

RPM-AC FINNED FRAME VARIABLE SPEED ALTERNATING
CURRENT MOTOR
FL2162C

ENCLOSURE: TOTALLY ENCLOSED
MOUNTING: FOOT/NEMA 210TC C-FACE
DRIVE METHOD: COUPLED OR BELTED

COOLING: NON-VENTILATED
ACCESSORIES: HS35

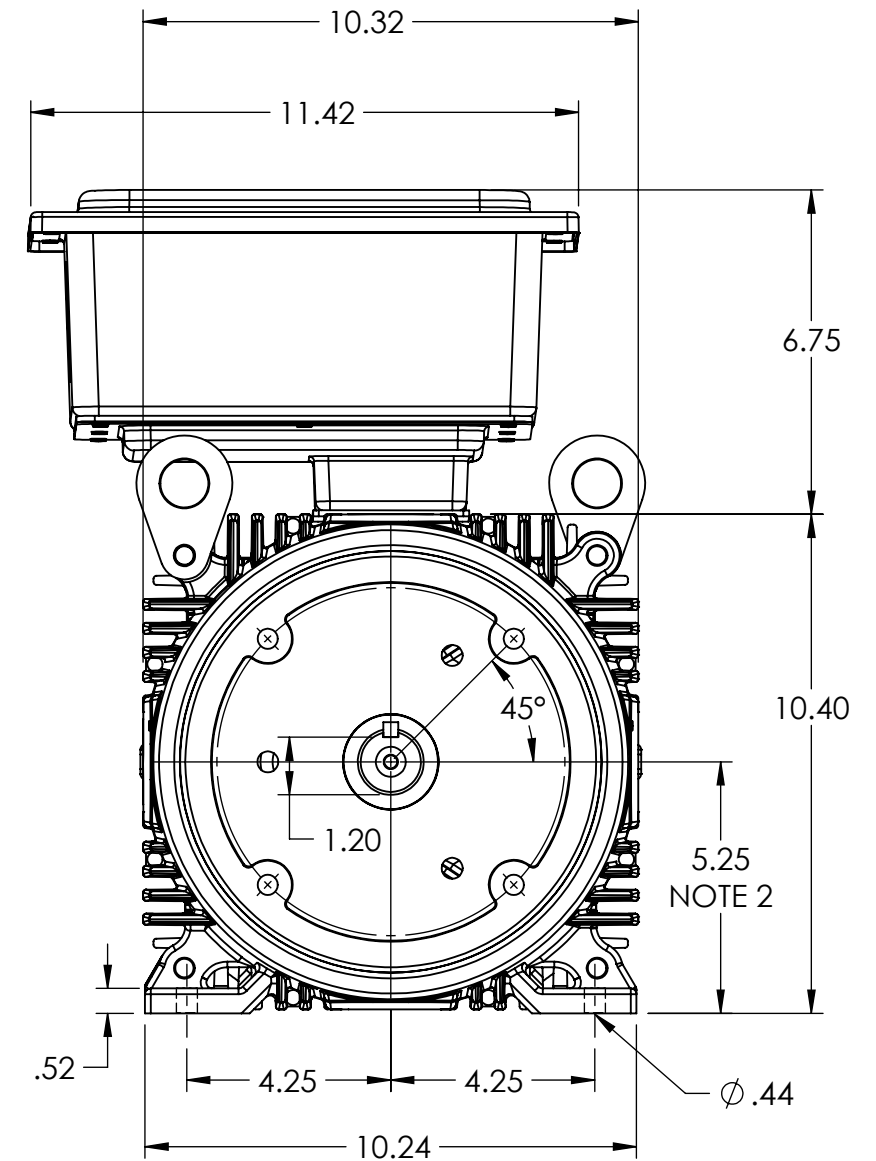
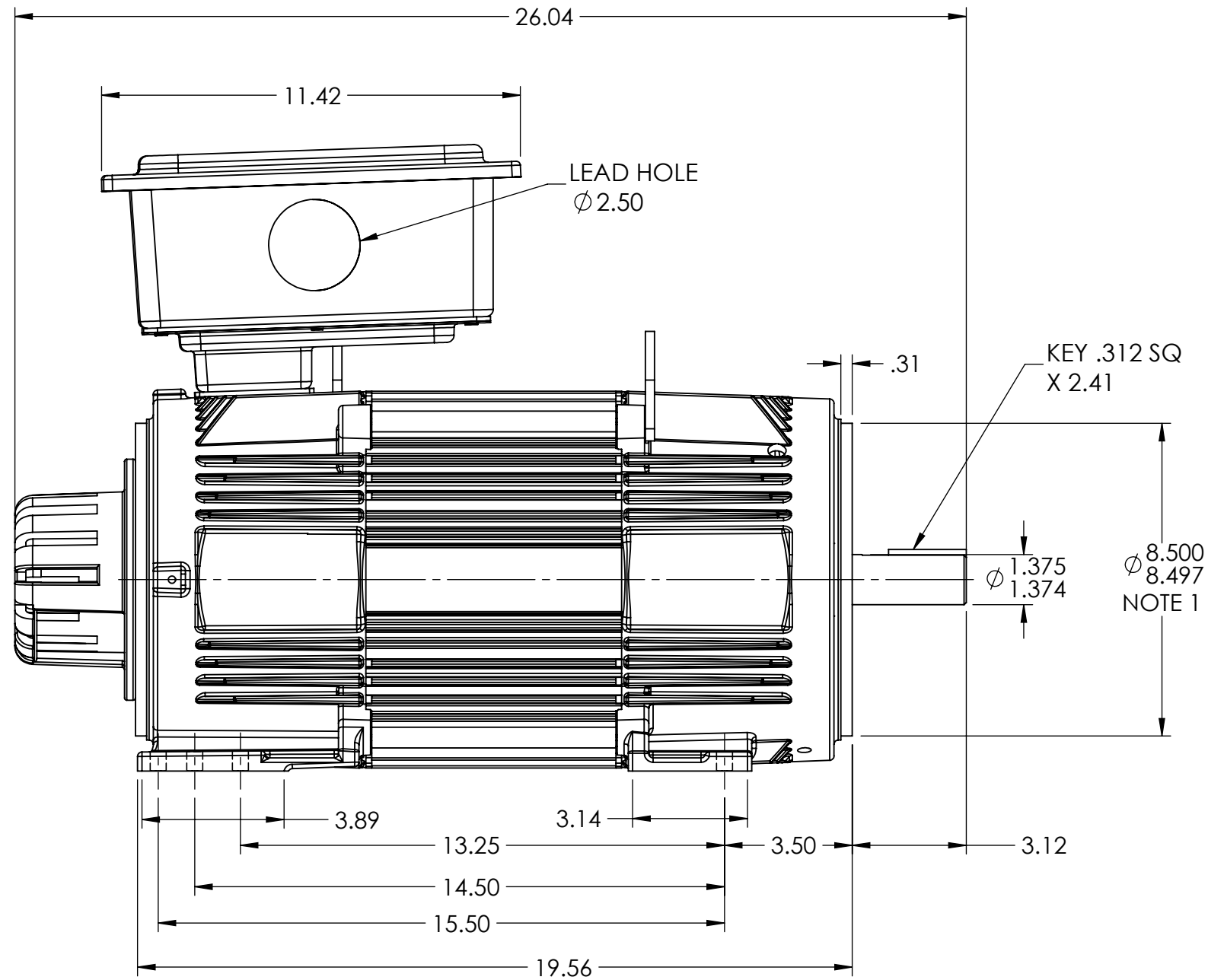

NOTE 1 O.D.E. C-FACE & TACHOMETER MOUNTING
1/2-13 TAP, .88 IN. DEEP, ON A ϕ 7.25 IN. BOLT CIRCLE
FACE RUNOUT AND ECCENTRICITY .004 MAX T.I.R.

NOTE 2 SHAFT HEIGHT WILL NOT BE EXCEEDED.
SHIMS UP TO .05mm IN THICKNESS ARE USUALLY
REQUIRED FOR COUPLED OR GEARED MACHINES.

235 AMP TERMINAL BOX SHOWN
ROTATABLE IN 90° INCREMENTS

DIMENSIONS ARE IN INCHES SCALE: 1.00
MOTOR WEIGHT: 280 LBS. (MAY VARY 15%)

CUSTOMER IS RESPONSIBLE FOR DETERMINING THAT THE PRODUCT WILL PERFORM SUITABLY IN THE INTENDED APPLICATION

REV. DESC: MODEL AND REDRAW IN SOLIDWORKS			
REV: A	VERSION: 01	REVISED: 12:55:04 01/30/2023	TDR: 000001202962
MODEL NO. 617516-374			REF: -
BY: USWATUR			B

BALDOR - RELIANCE®

DIM SHT,TENV,FL2162C,FT MT,HS35,F3 MILL BOX

617516-374

617516-374