

COOLING: FAN COOLED
ACCESSORIES: BEI HS35

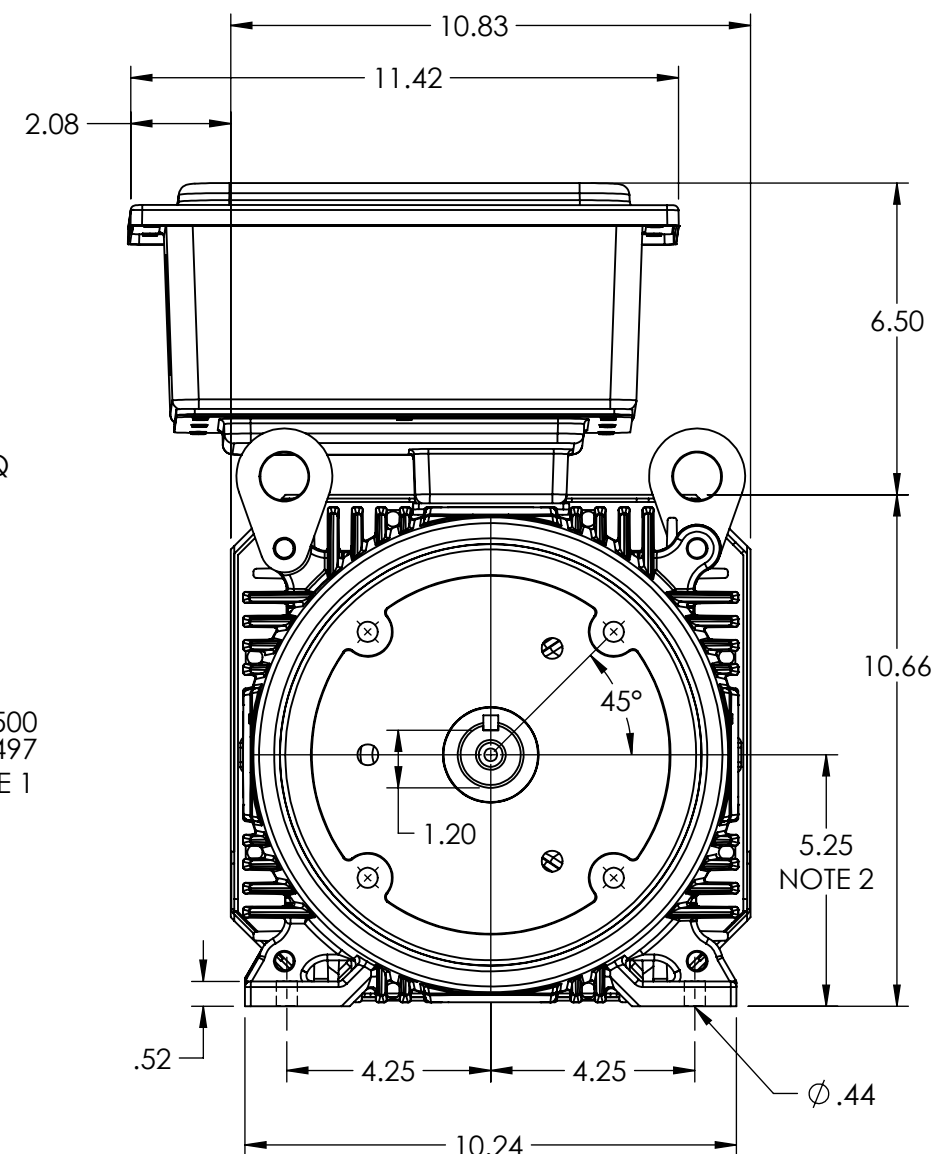
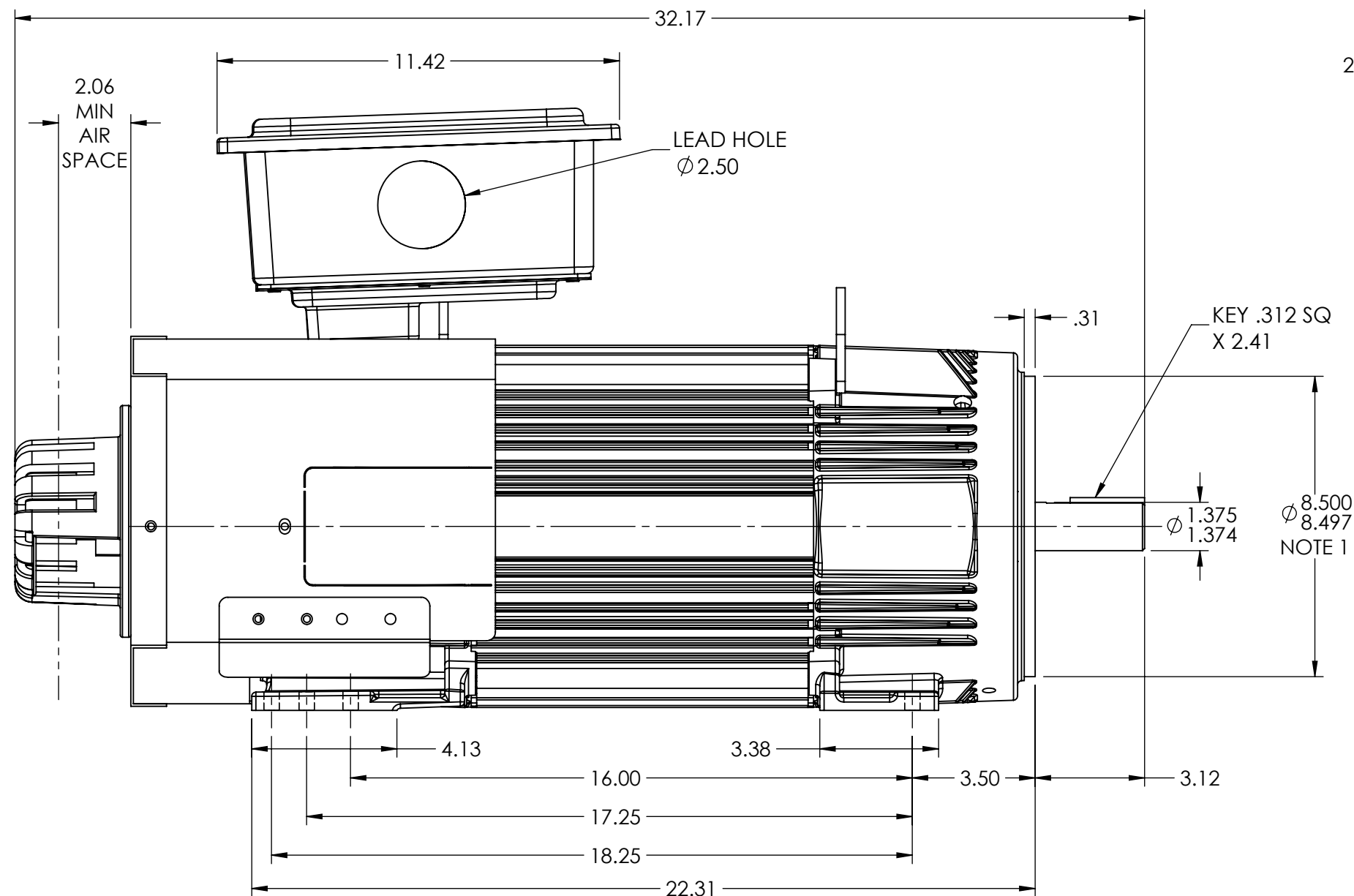

235 AMP TERMINAL BOX SHOWN
ROTATABLE IN 90° INCREMENTS

DIMENSIONS ARE IN INCHES SCALE: 1.00
MOTOR WEIGHT: 355 LBS. (MAY VARY 15%)

NOTE 1 O.D.E. C-FACE & TACHOMETER MOUNTING
1/2-13 TAP, .88 IN. DEEP, ON A $\varnothing 7.25$ IN. BOLT CIRCLE
FACE RUNOUT AND ECCENTRICITY .004 MAX T.I.R.

NOTE 2 SHAFT HEIGHT WILL NOT BE EXCEEDED.
SHIMS UP TO .05mm IN THICKNESS ARE USUALLY
REQUIRED FOR COUPLED OR GEARED MACHINES.

CUSTOMER IS RESPONSIBLE FOR DETERMINING THAT THE PRODUCT WILL PERFORM SUITABLY IN THE INTENDED APPLICATION

REV. DESC: MODEL AND REDRAW IN SOLIDWORKS			
REV: A	VERSION: 01	REVISED: 10:29:47 01/30/2023	TDR: 000001202962
MODEL NO. 617525-360			REF: -
BY: USWATUR			

BALDOR - RELIANCE®

DIM SHT,FL2173C,TEFC,210TC C-FACE MTG,F3 MILL BOX,HS35

617525-360