

DUTY MASTER ALTERNATING CURRENT MOTORS
SQUIRREL-CAGE INDUCTION

617429-746

ENCLOSURE: TOTALLY ENCLOSED

MOUNTING: FOOT, F-1

G405TS/G404TS FRAME MOUNTING HOLES

COOLING: FAN COOLED

F
E
D
C
B
A

F
E
D
C
B
A

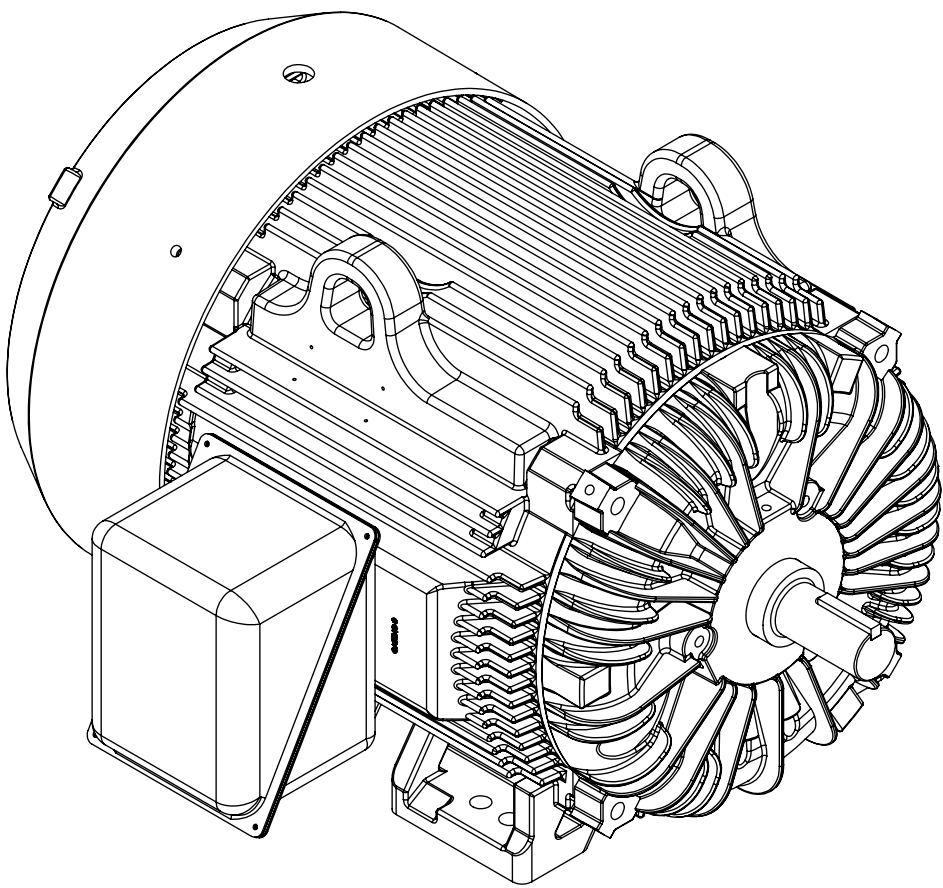
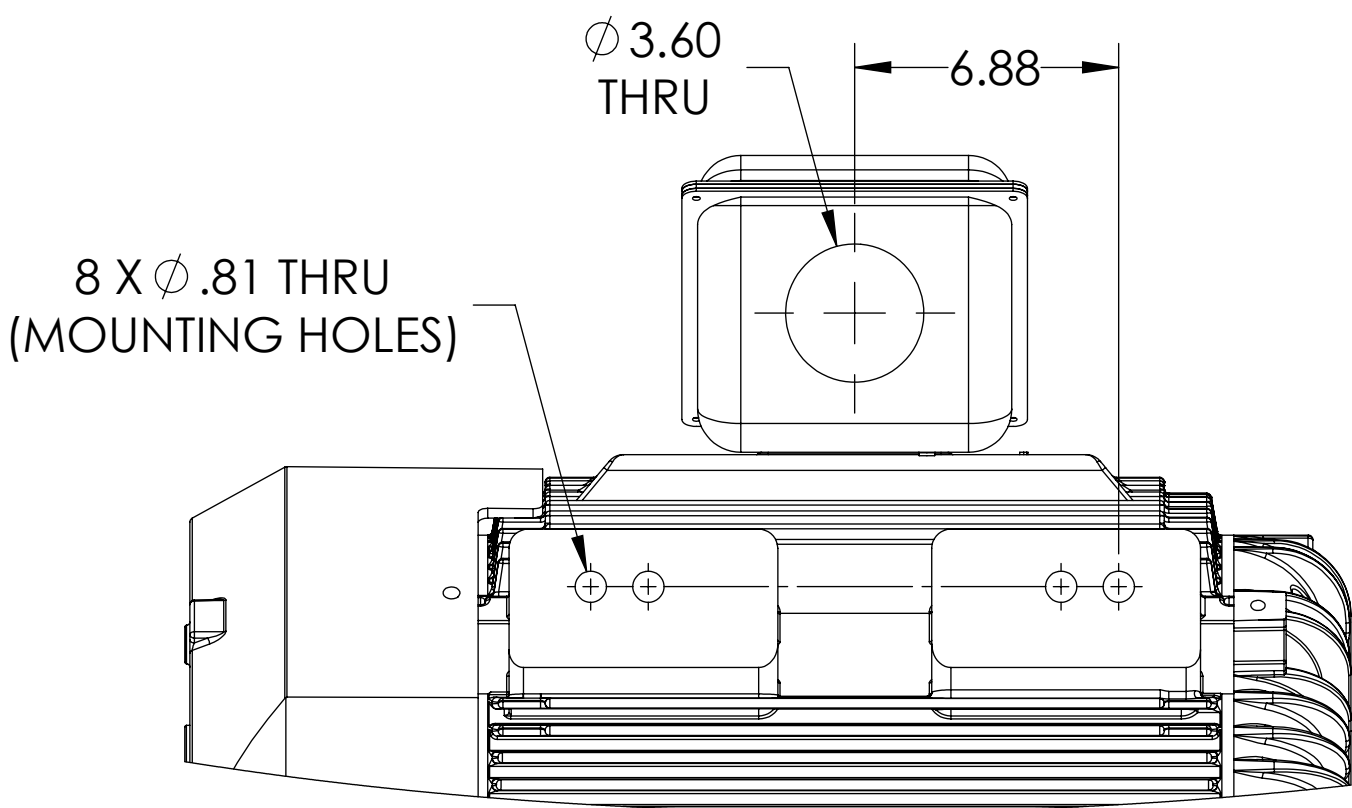
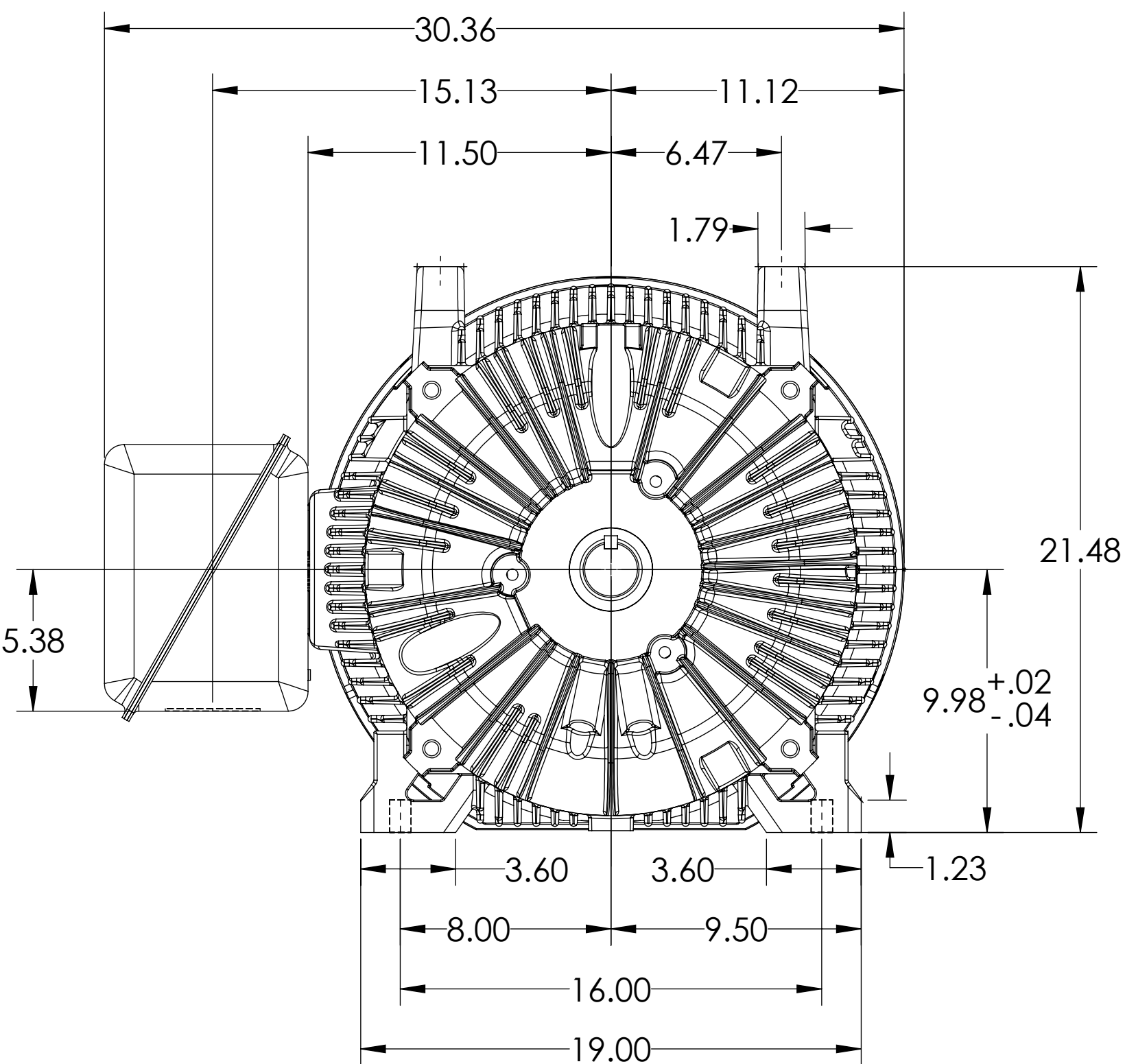
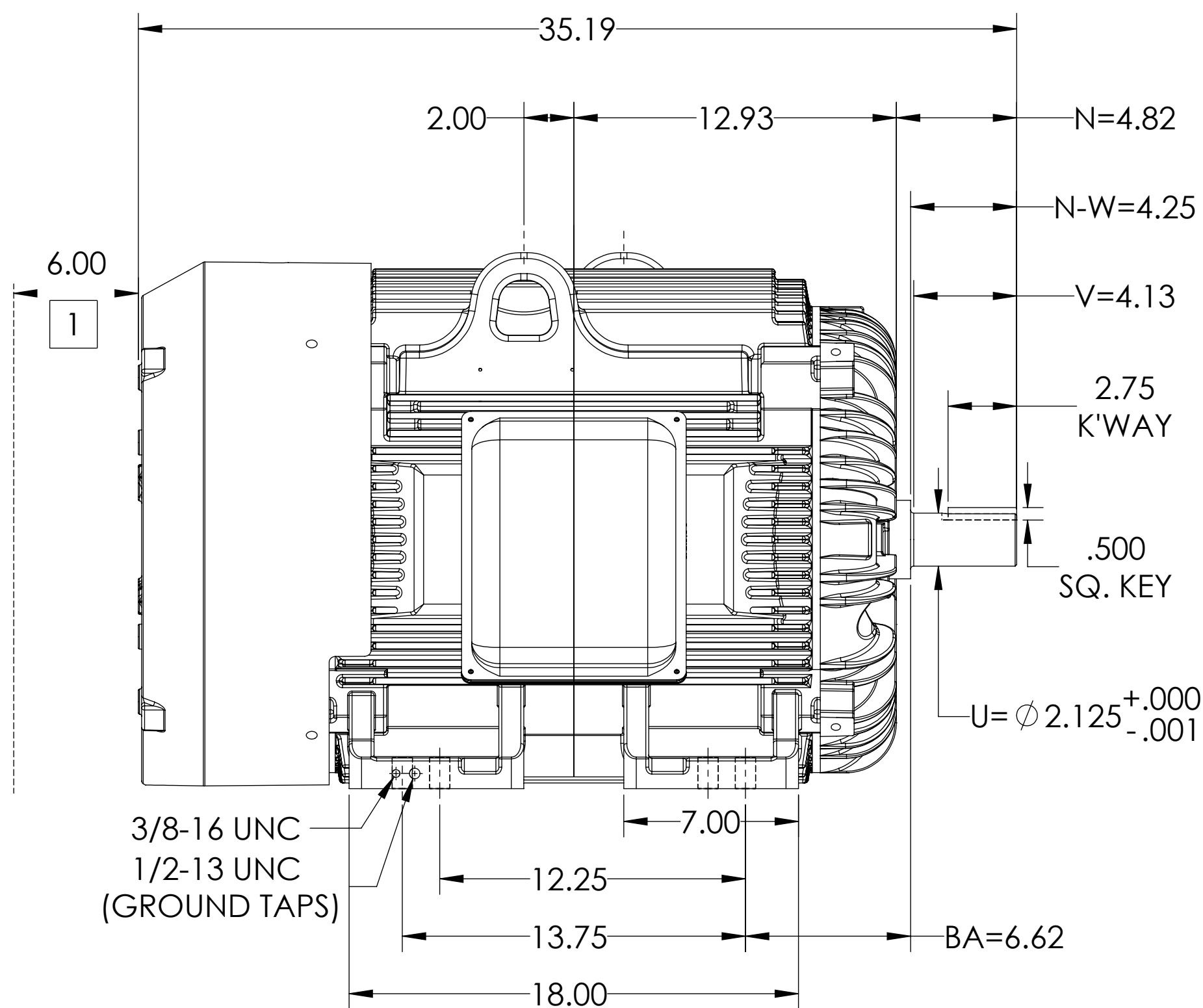

DIMENSIONS ARE IN INCHES
WEIGHT (LBS): 1350, MOTOR WEIGHTS MAY VARY BY 15% DEPENDING ON RATING.
CUSTOMER IS RESPONSIBLE FOR DETERMINING THAT MOTOR PERFORMANCE IS SUITABLE IN THE APPLICATION.

SHEET NUMBER
1 OF 2

617429-746

1 OBSTRUCTION MUST NOT ENCROACH ON AIR INLET

IF MOUNTING CLEARANCE DETAILS ARE REQUIRED, CONSULT FACTORY.
MAX PERMISSIBLE SHAFT RUNOUT WHEN MEASURED AT END OF STANDARD SHAFT EXTENSION IS .003" T.I.R.

REV. DESC: ADDING METRIC DS			
REV: B	VERSION: 02	REVISED: 09:22:40 09/20/2022	TDR: 000001197276
MODEL NO. 617429-746		REF:	
BY: USJEDIL		Material:	C

BALDOR

G405/404TS TEFC F1 FOOT/STEEL CONDUIT BOX

617429-746

8 7 6 5 4 3 2 1

DUTY MASTER ALTERNATING CURRENT MOTORS
SQUIRREL-CAGE INDUCTION

617429-746

ENCLOSURE: TOTALLY ENCLOSED

MOUNTING: FOOT, F-1

G405TS/G404TS FRAME MOUNTING HOLES

COOLING: FAN COOLED

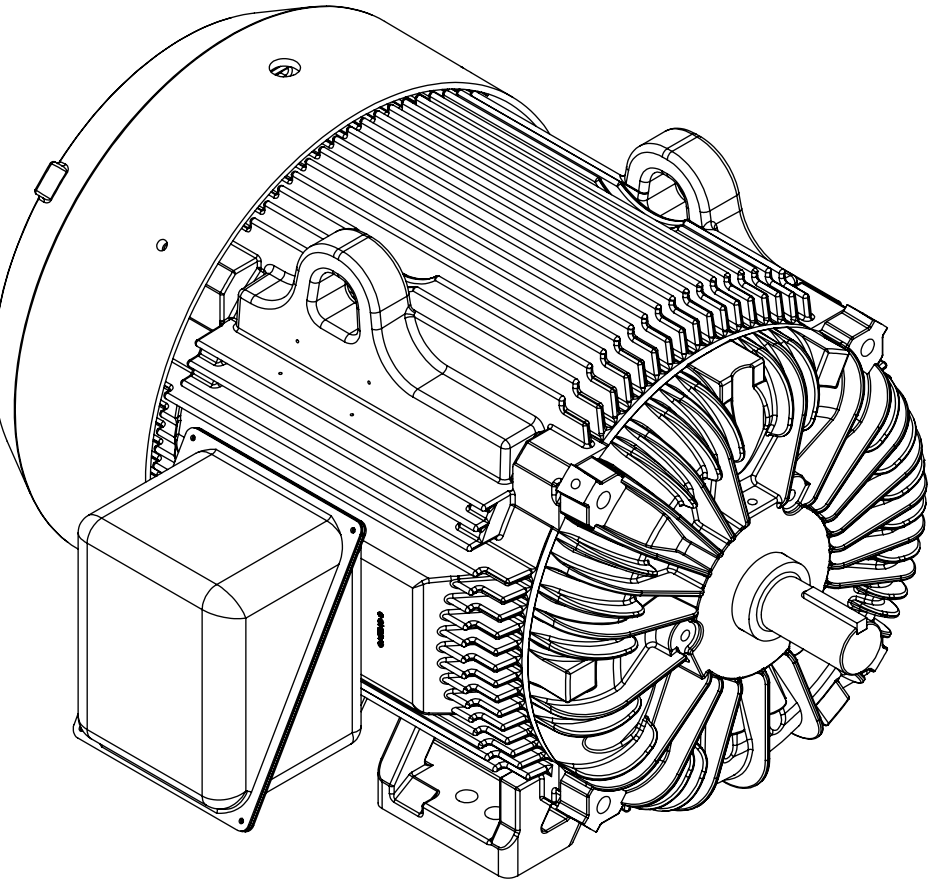
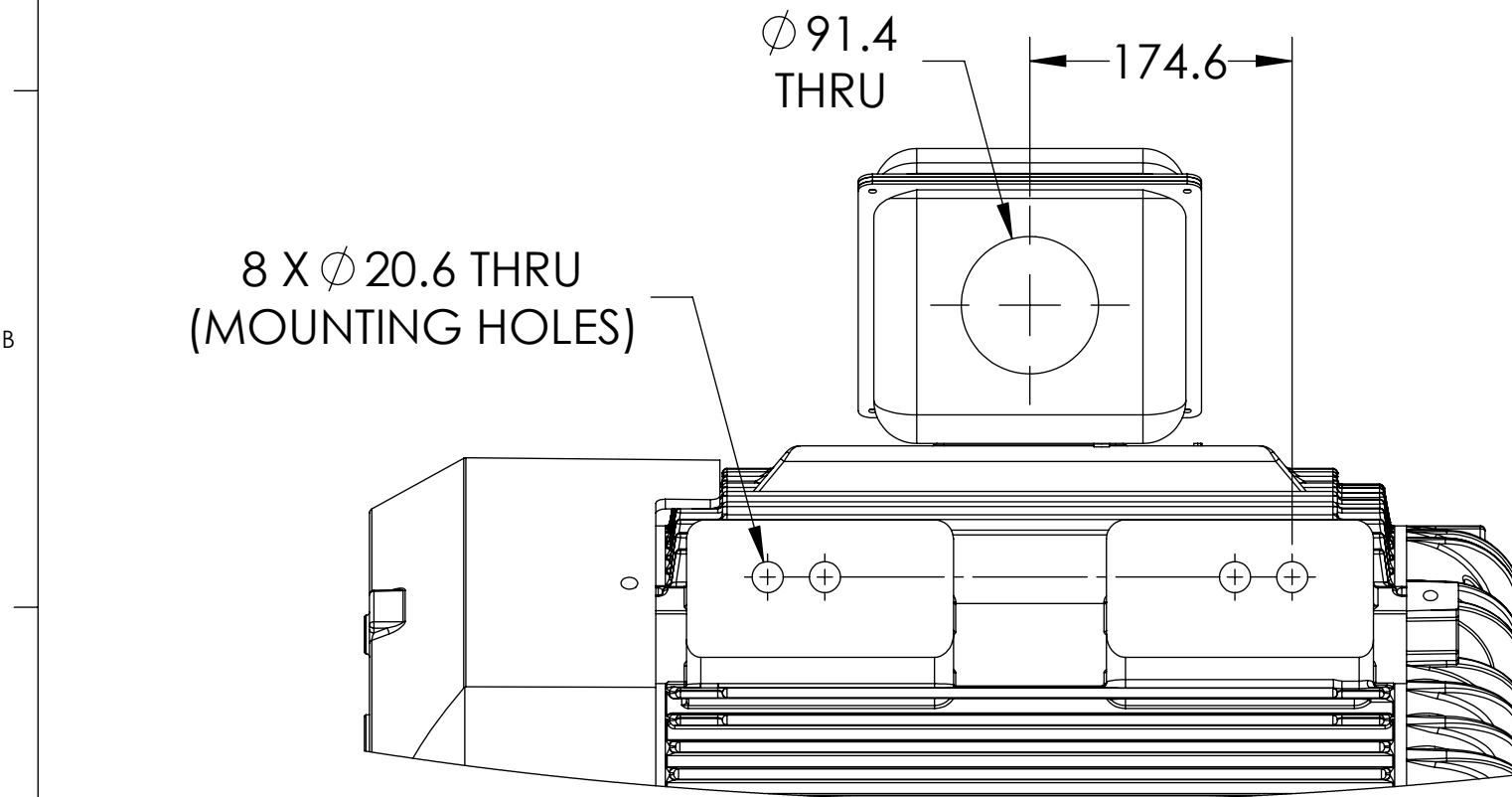
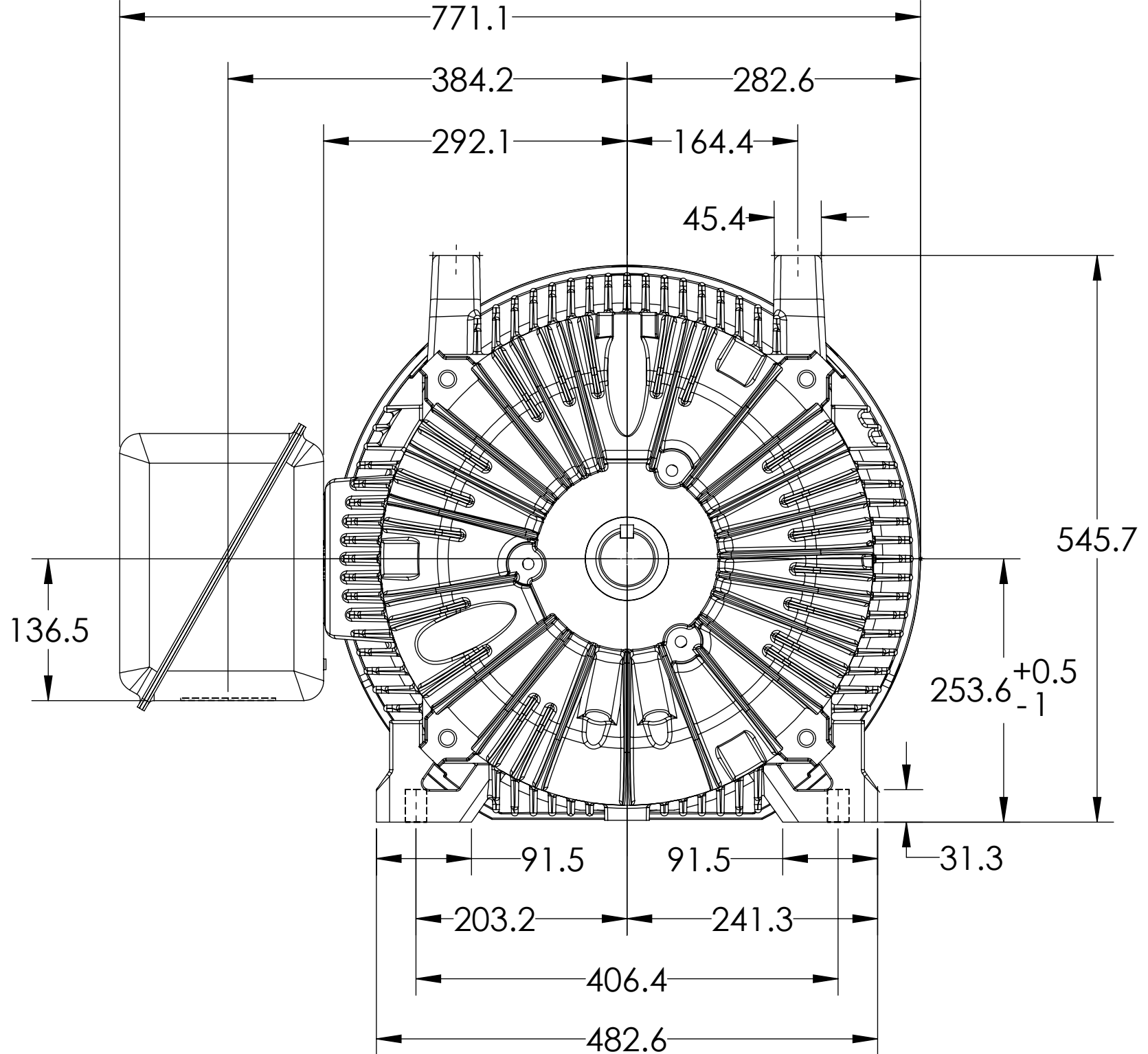
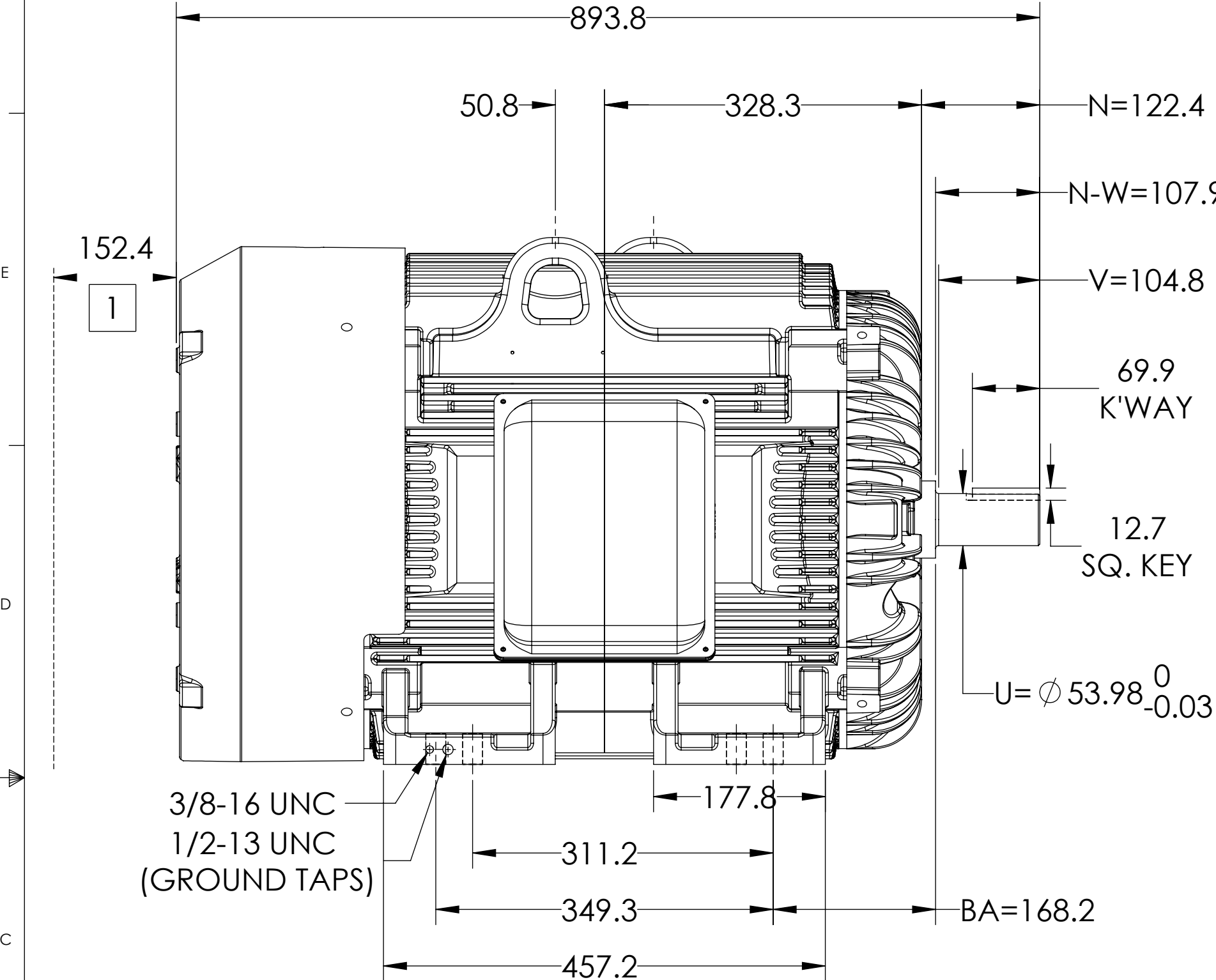

DIMENSIONS ARE IN MILLIMETERS.
WEIGHT (KG): 612, MOTOR WEIGHTS MAY VARY BY 15% DEPENDING ON RATING.
CUSTOMER IS RESPONSIBLE FOR DETERMINING THAT MOTOR PERFORMANCE IS SUITABLE IN THE APPLICATION.

REV. DESC: ADDING METRIC DS			
REV: B	VERSION: 02	REVISED: 09:22:40 09/20/2022	TDR: 000001197276
MODEL NO. 617429-746		REF:	
BY: USJEDIL		Material:	

BALDOR

G405/404TS TEFC F1 FOOT/STEEL CONDUIT BOX

1 OBSTRUCTION MUST NOT ENCROACH ON AIR INLET

IF MOUNTING CLEARANCE DETAILS ARE REQUIRED, CONSULT FACTORY.
MAX PERMISSIBLE SHAFT RUNOUT WHEN MEASURED AT END OF STANDARD SHAFT EXTENSION IS .08 T.I.R.

SHEET NUMBER
2 OF 2

617429-746

617429-746