

DUTY MASTER ALTERNATING CURRENT MOTORS
SQUIRREL-CAGE INDUCTION

617428-924

ENCLOSURE: TOTALLY ENCLOSED

MOUNTING: FOOTLESS, V-1

FRAME E364/365HP
CAST IRON C/BOX
VERTICAL LIFTING MEANS
DRIP COVER

COOLING: FAN COOLED

ENCLOSURE ENHANCEMENT: SEVERE DUTY

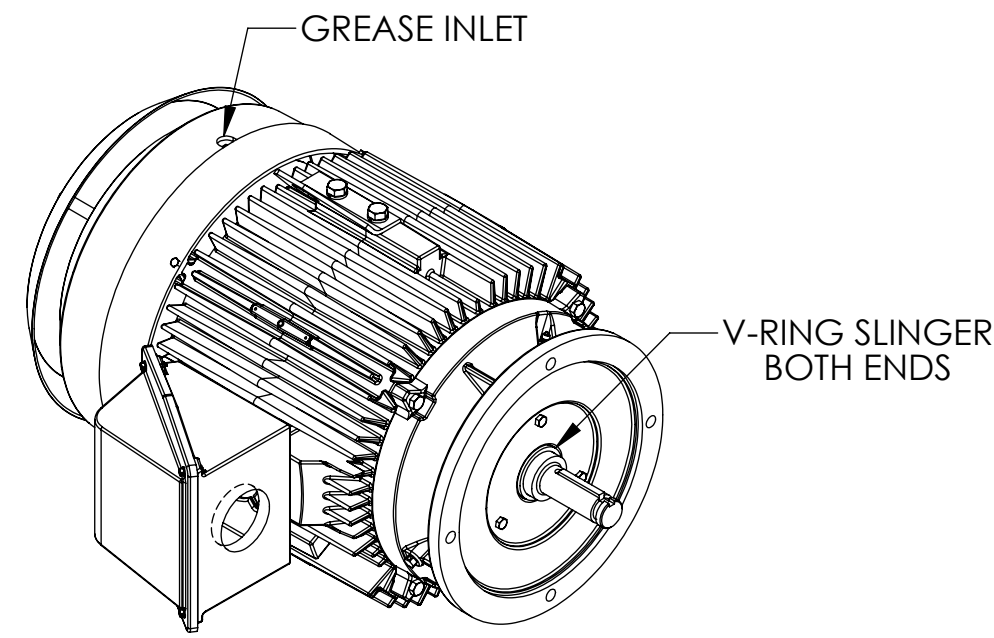
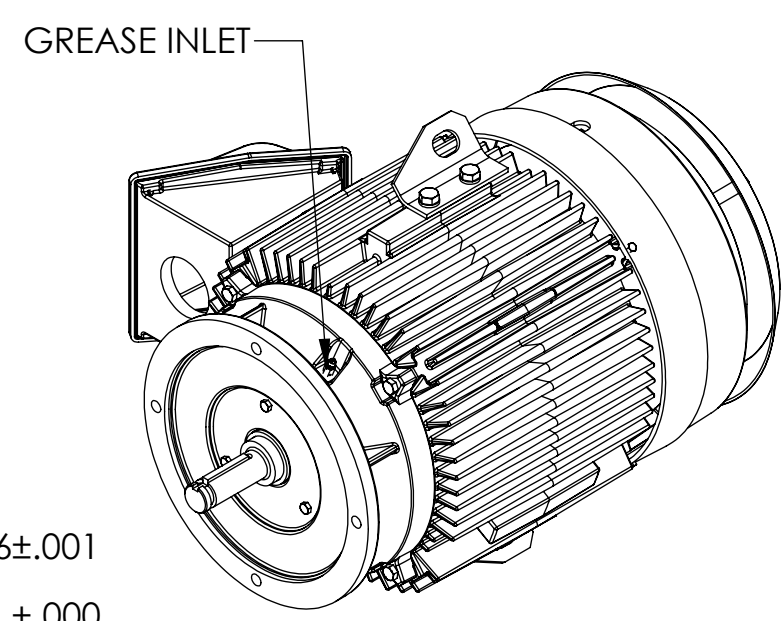
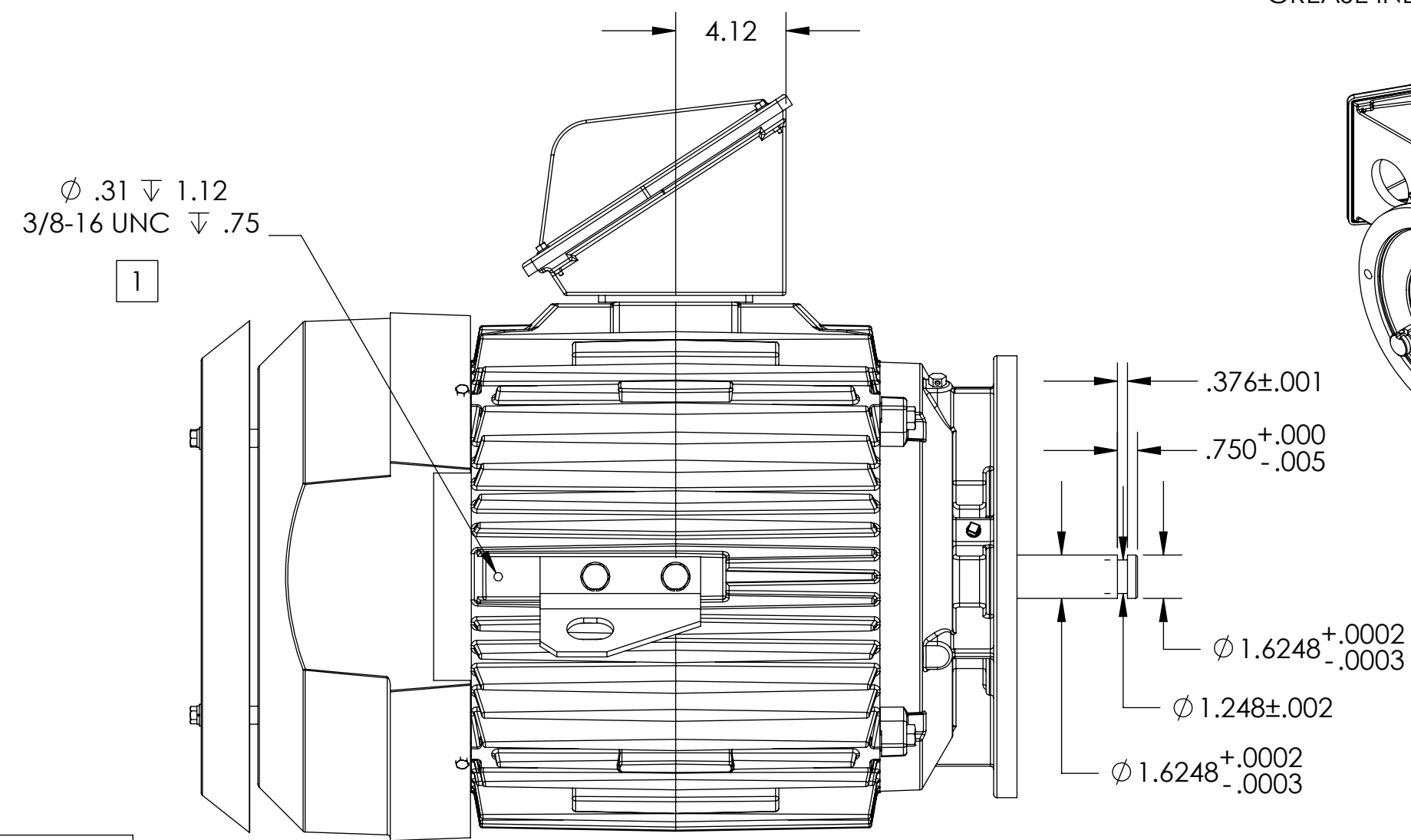
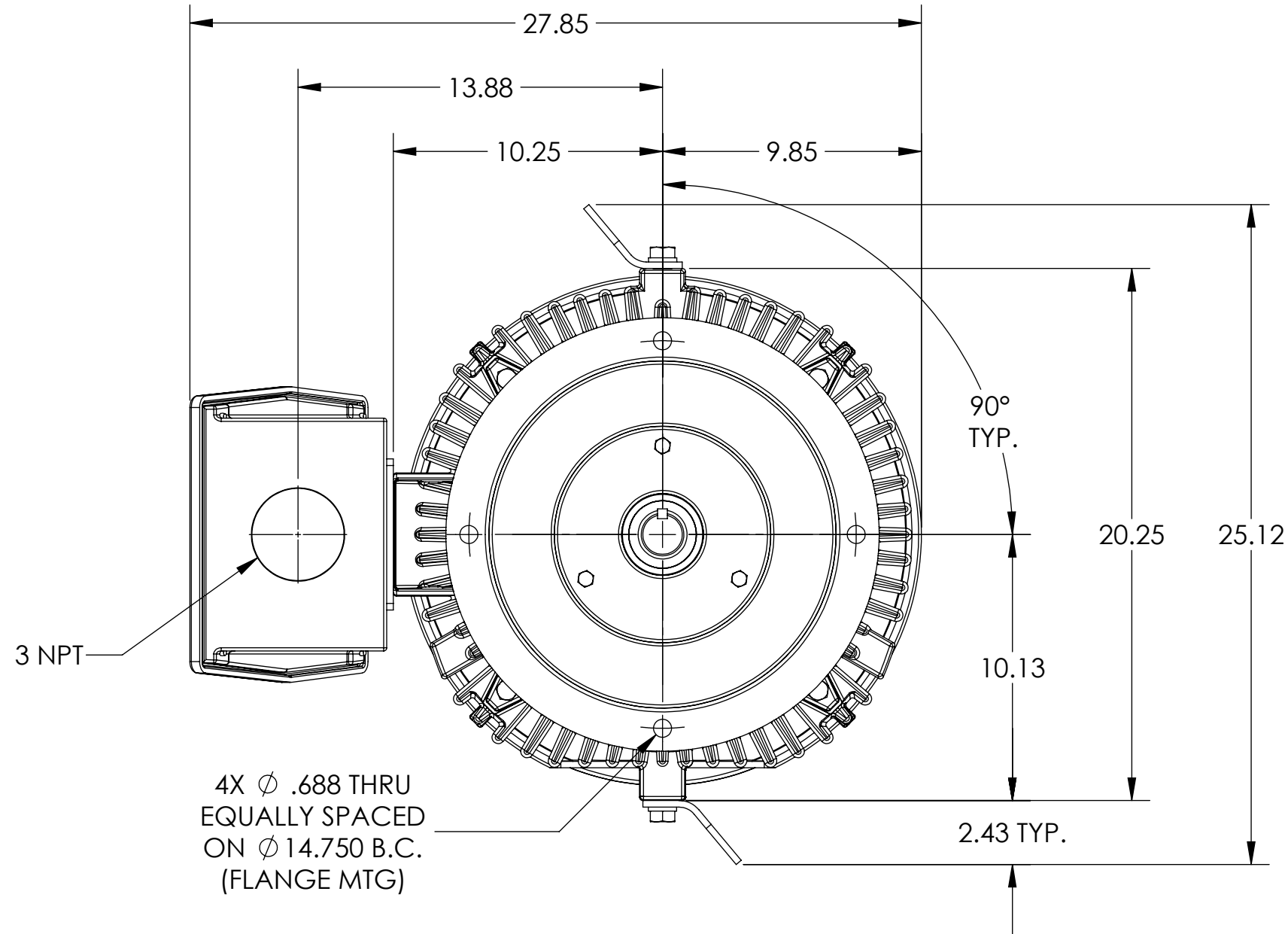
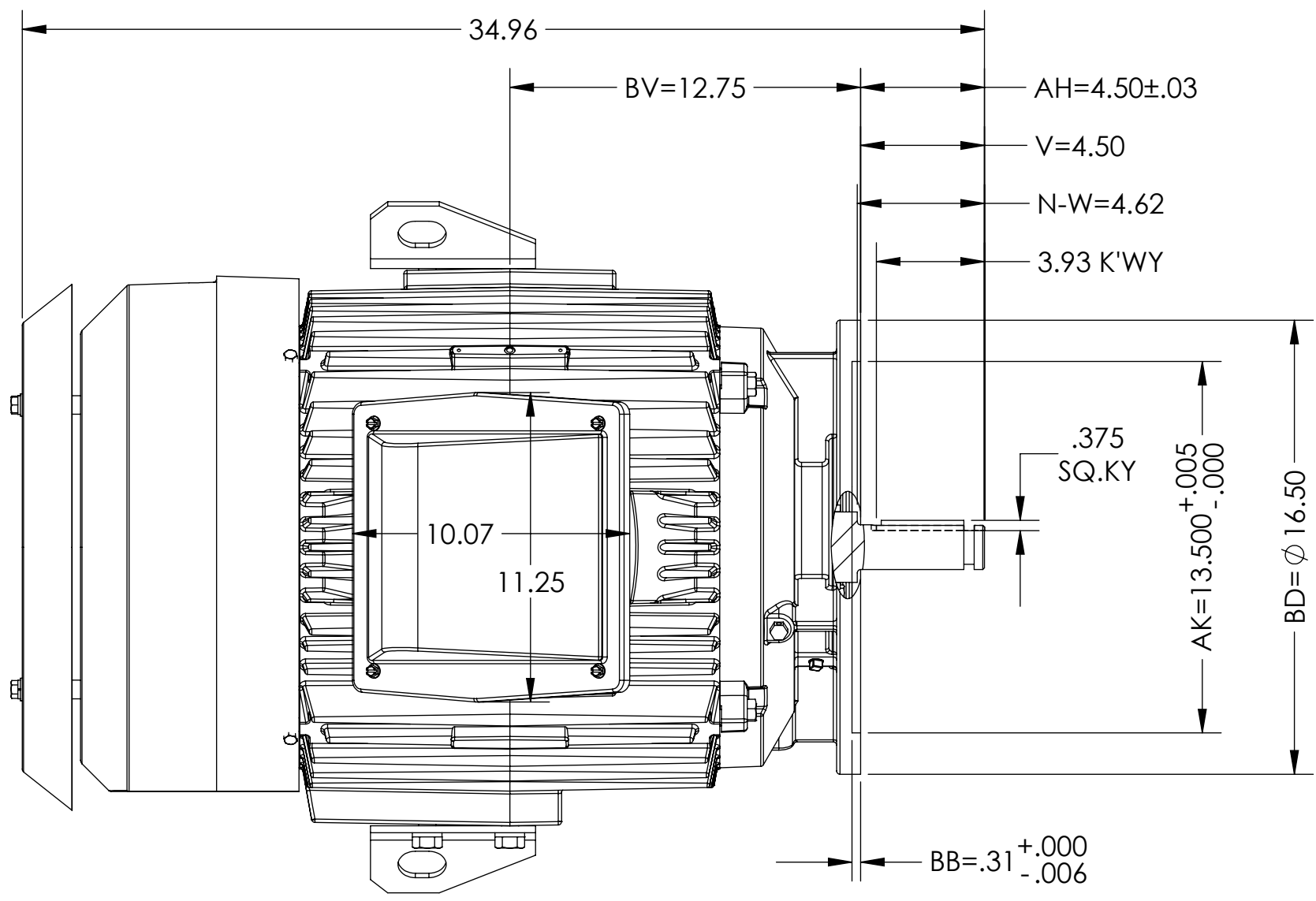

1 FRAME GROUND PROVIDED ONLY WHEN SPECIFIED

WEIGHT=900 LBS ± 15% DEPENDING ON RATING.

IF MOUNTING CLEARANCE DETAILS ARE REQUIRED, CONSULT FACTORY.

MAXIMUM PERMISSIBLE SHAFT RUNOUT WHEN MEASURED AT END OF
STANDARD SHAFT EXTENSION IS .002 T.I.R.

FACE RUNOUT & ECCENTRICITY RUNOUT = .006 T.I.R. MAX.

DIMENSIONS ARE IN INCHES

CUSTOMER IS RESPONSIBLE FOR DETERMINING THAT MOTOR PERFORMANCE IS SUITABLE IN THE APPLICATION.

REV. DESC: NOTE FRAME GRD HOLE PROVIDED ONLY WHEN SPECIFIED			
REV: A	VERSION: 01	REVISED: 03:22:45 06/11/2024	TDR: 000001234366
MODEL NO. 617428-924			
BY: RAGGDM			

BALDOR

E364/365HP TEFC V-1 FTLS - CAST IRON C/BOX

SHEET NUMBER
1 OF 1
617428-924

617428-924