

DUTY MASTER ALTERNATING CURRENT MOTORS
SQUIRREL-CAGE INDUCTION

617427-507

ENCLOSURE: TOTALLY ENCLOSED

MOUNTING: FOOT, F-1 SIDE

G444T/G445T FRAME MOUNTING HOLES

COOLING: FAN COOLED

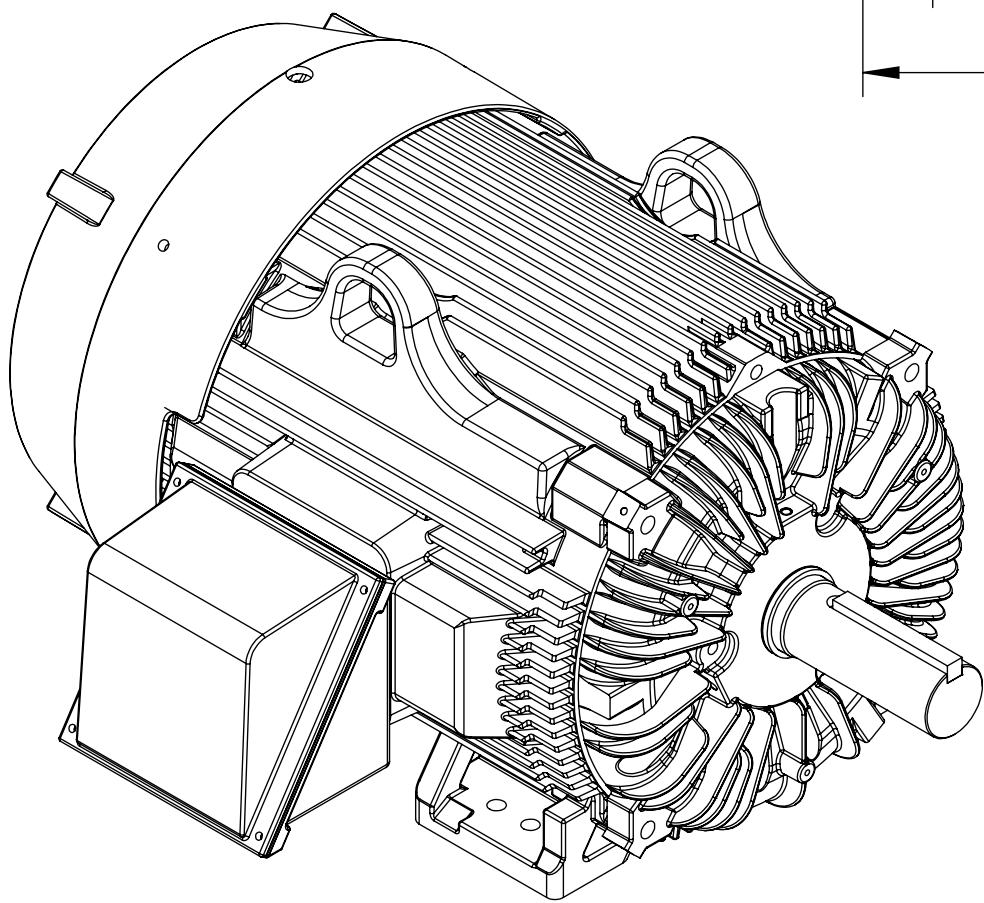
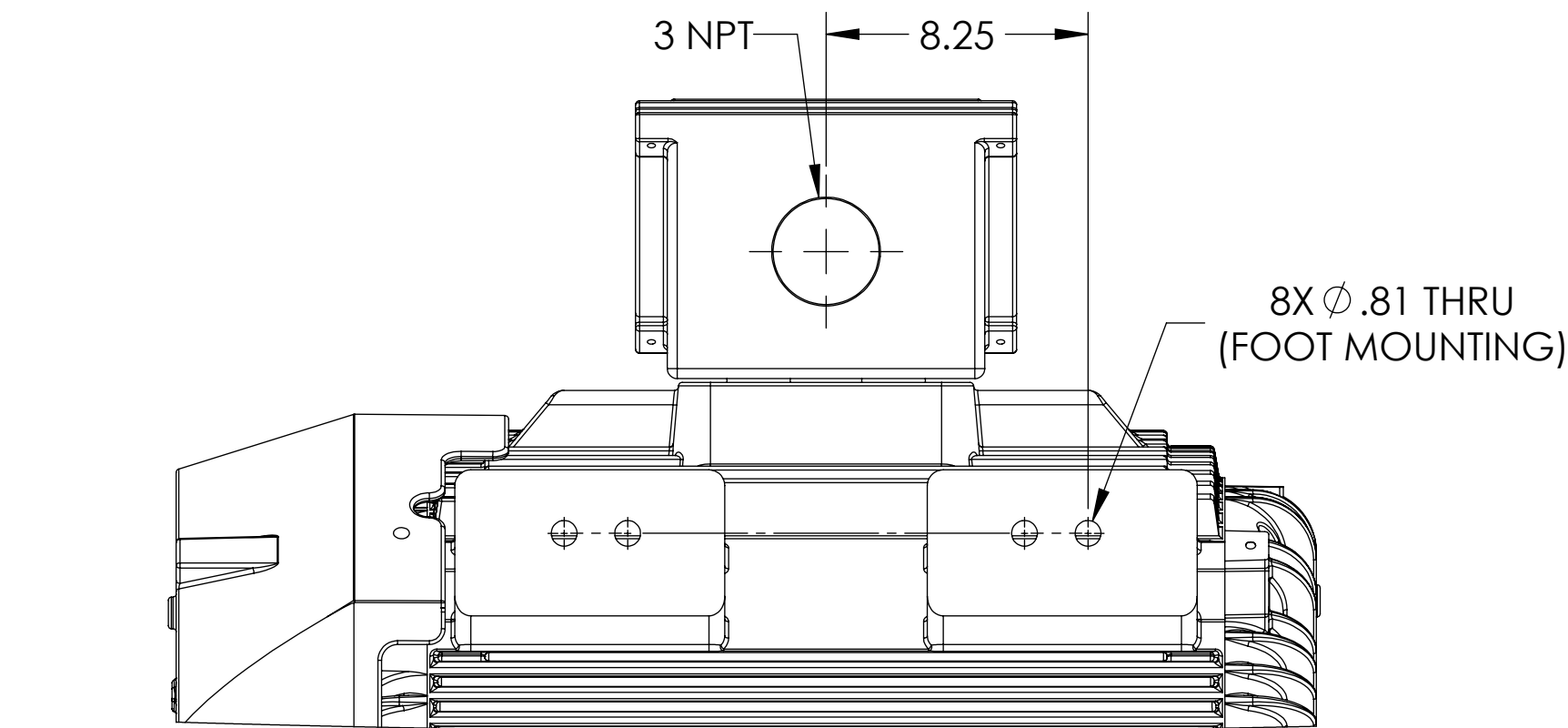
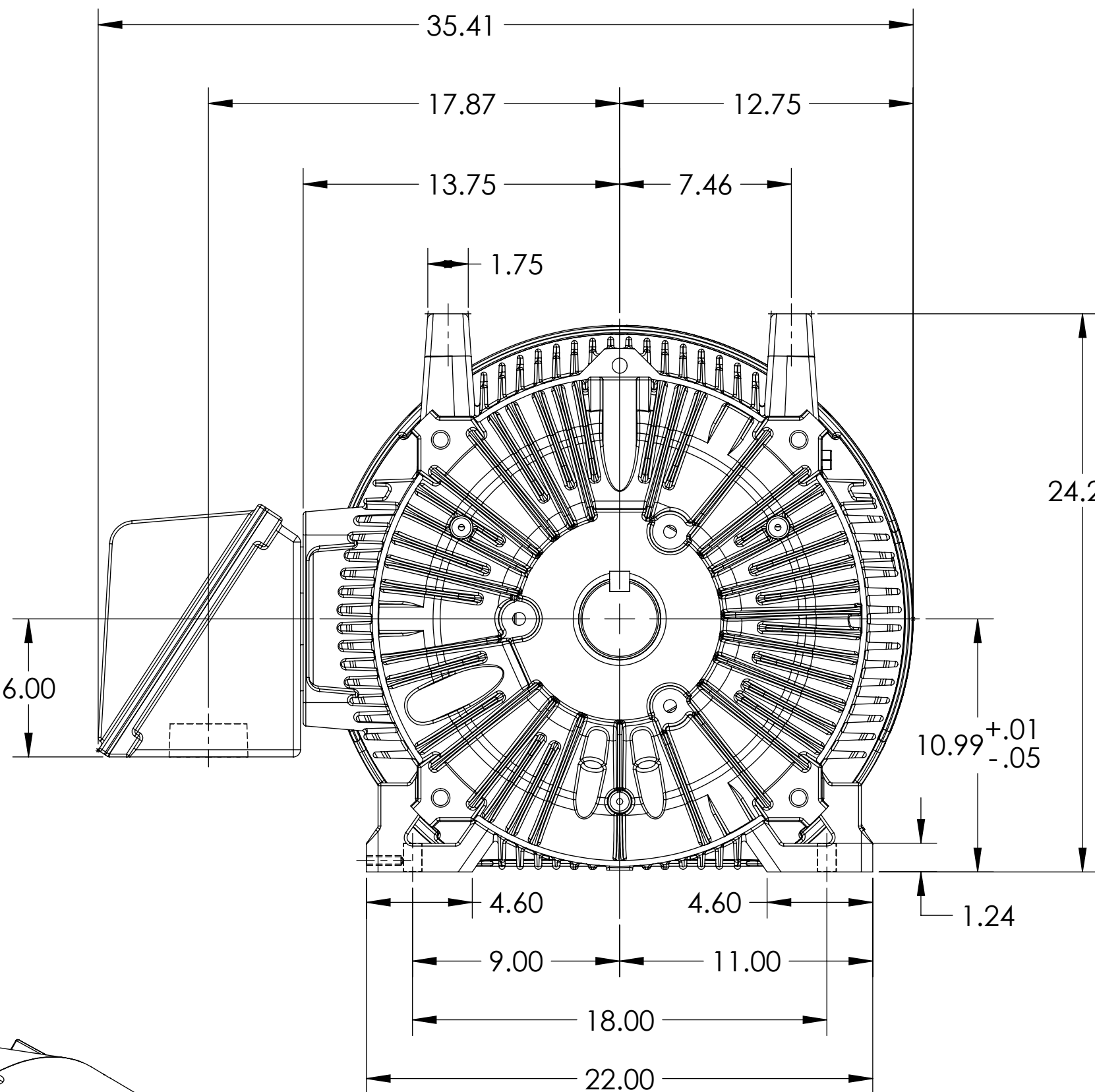
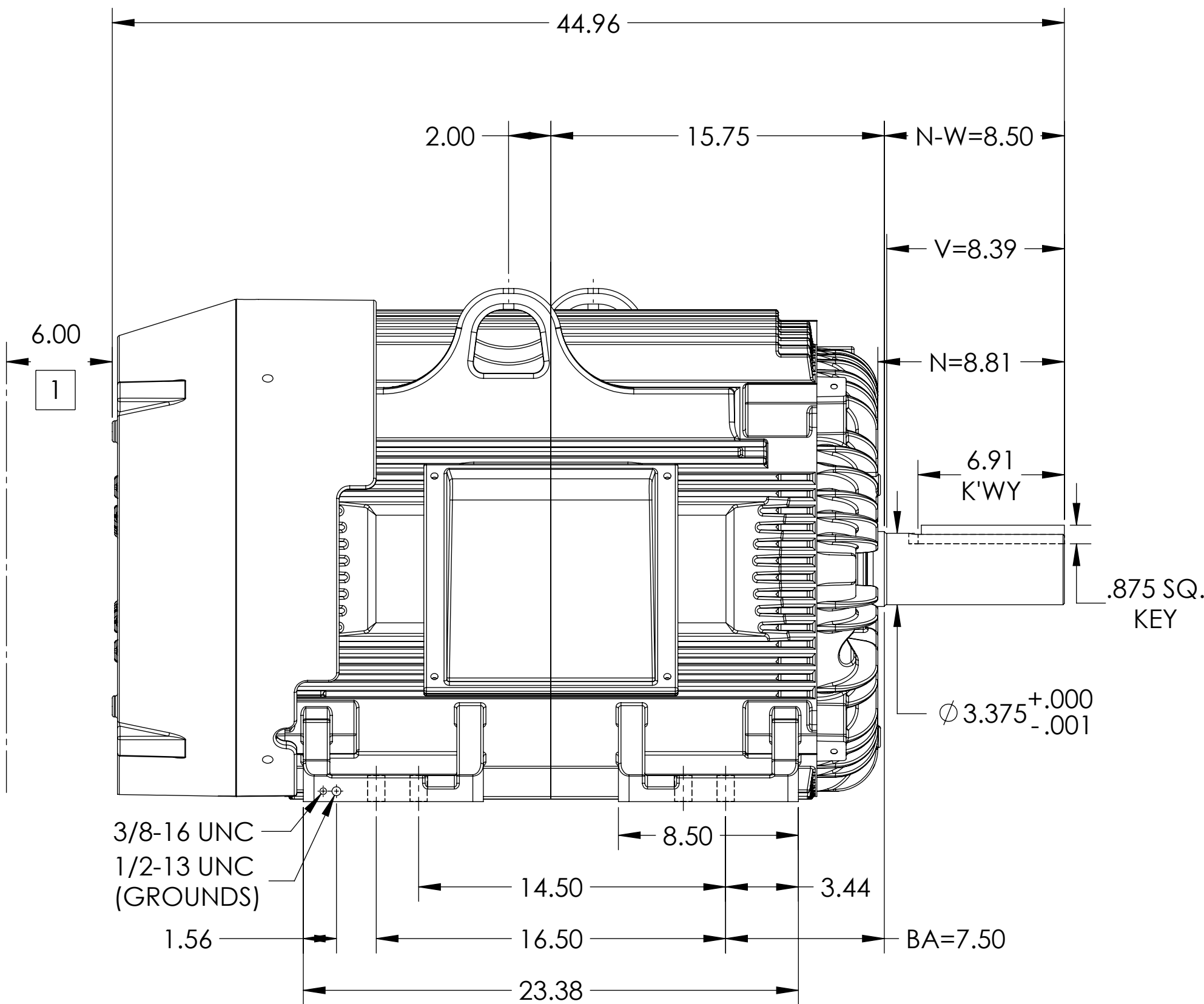

DIMENSIONS ARE IN INCHES
WEIGHT (LBS): 2130, MOTOR WEIGHTS MAY VARY BY 15% DEPENDING ON RATING.
CUSTOMER IS RESPONSIBLE FOR DETERMINING THAT MOTOR PERFORMANCE IS SUITABLE IN THE APPLICATION.

REV. DESC: ADD ADDITIONAL FOOT MOUNTING DIMS TO THE DS			
REV: C	VERSION: 03	REVISED: 07:57:50 01/13/2023	TDR: 000001202430
MODEL NO. 617427-507		REF: -	
BY: USJEDIL		Material: -	

BALDOR

G445/444T TEFC F1 FOOT CAST IRON BOX

SHEET NUMBER
1 OF 2

617427-507

1 OBSTRUCTION MUST NOT ENCR OACH ON AIR INLET.

IF MOUNTING CLEARANCE DETAILS ARE REQUIRED, CONSULT FACTORY.
MAX PERMISSIBLE SHAFT RUNOUT WHEN MEASURED AT END OF STANDARD SHAFT EXTENSION IS .003" T.I.R.

617427-507

DUTY MASTER ALTERNATING CURRENT MOTORS
SQUIRREL-CAGE INDUCTION

617427-507

ENCLOSURE: TOTALLY ENCLOSED

MOUNTING: FOOT, F-1 SIDE

G444T/G445T FRAME MOUNTING HOLES

COOLING: FAN COOLED

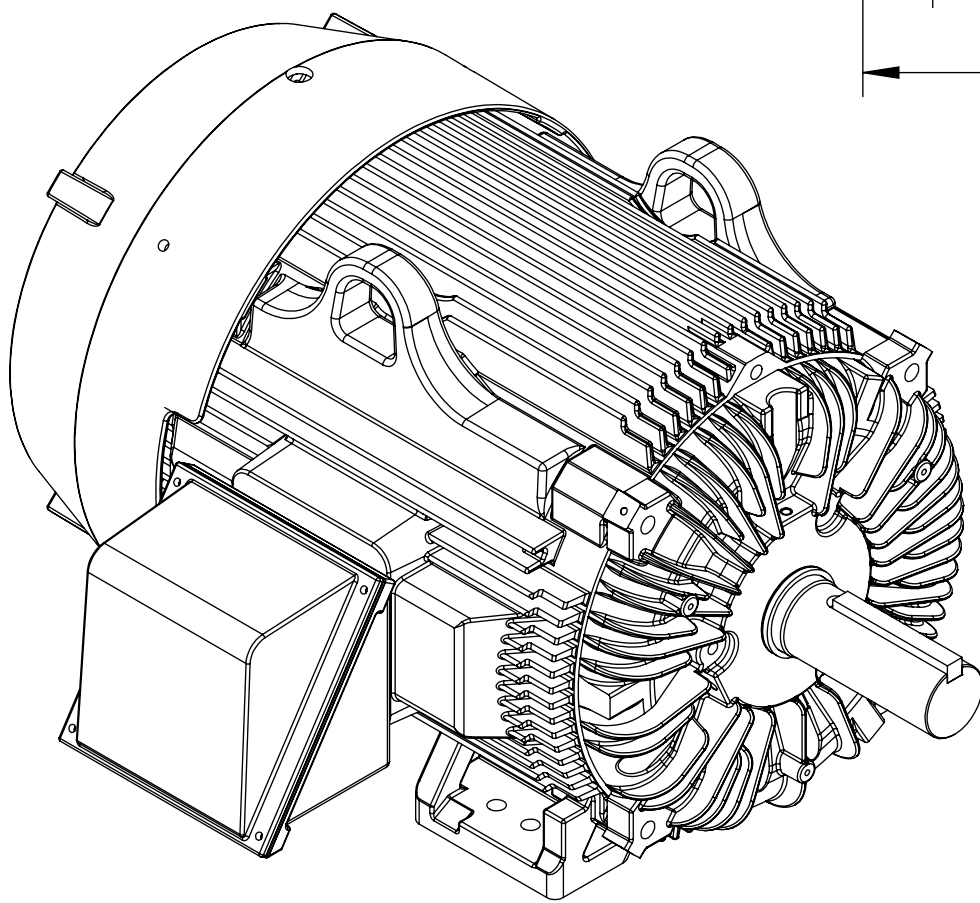
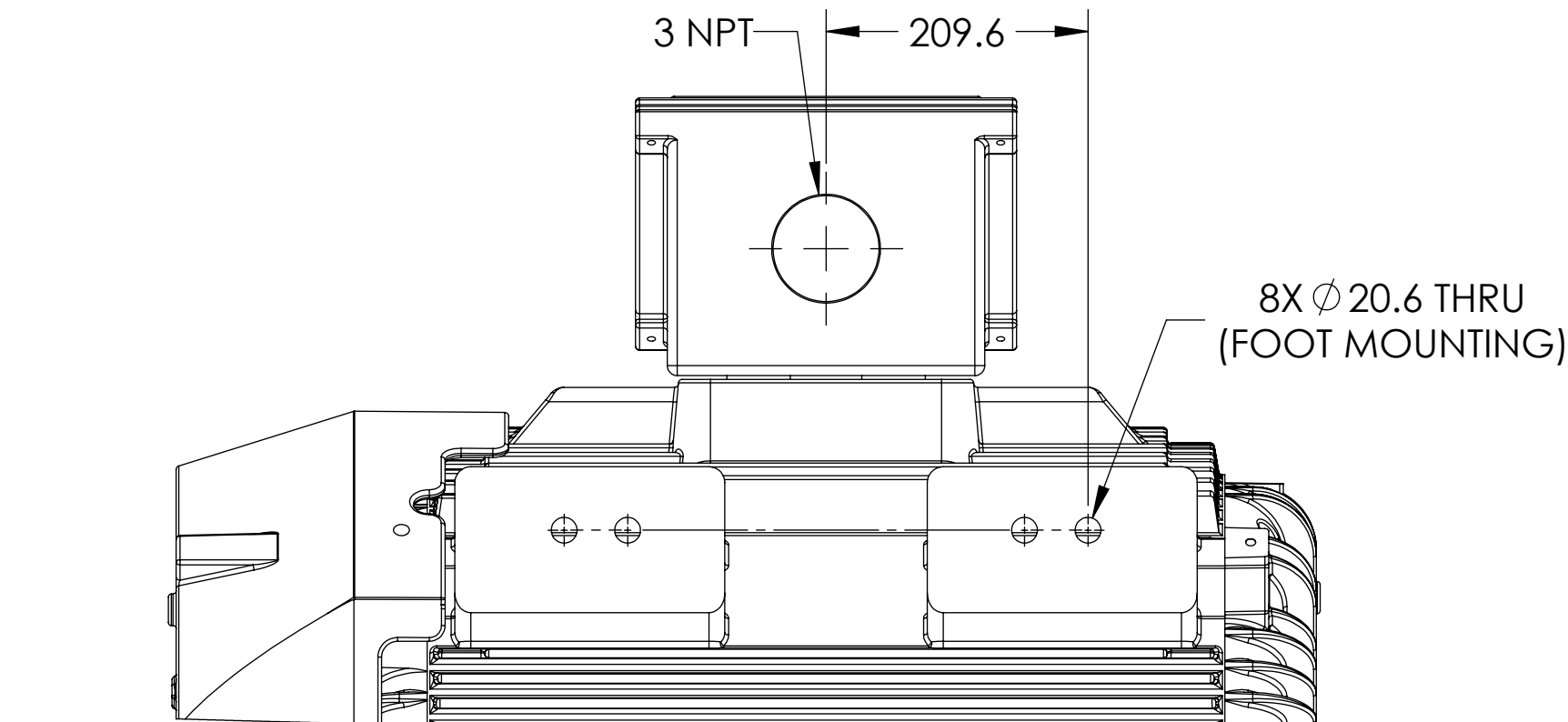
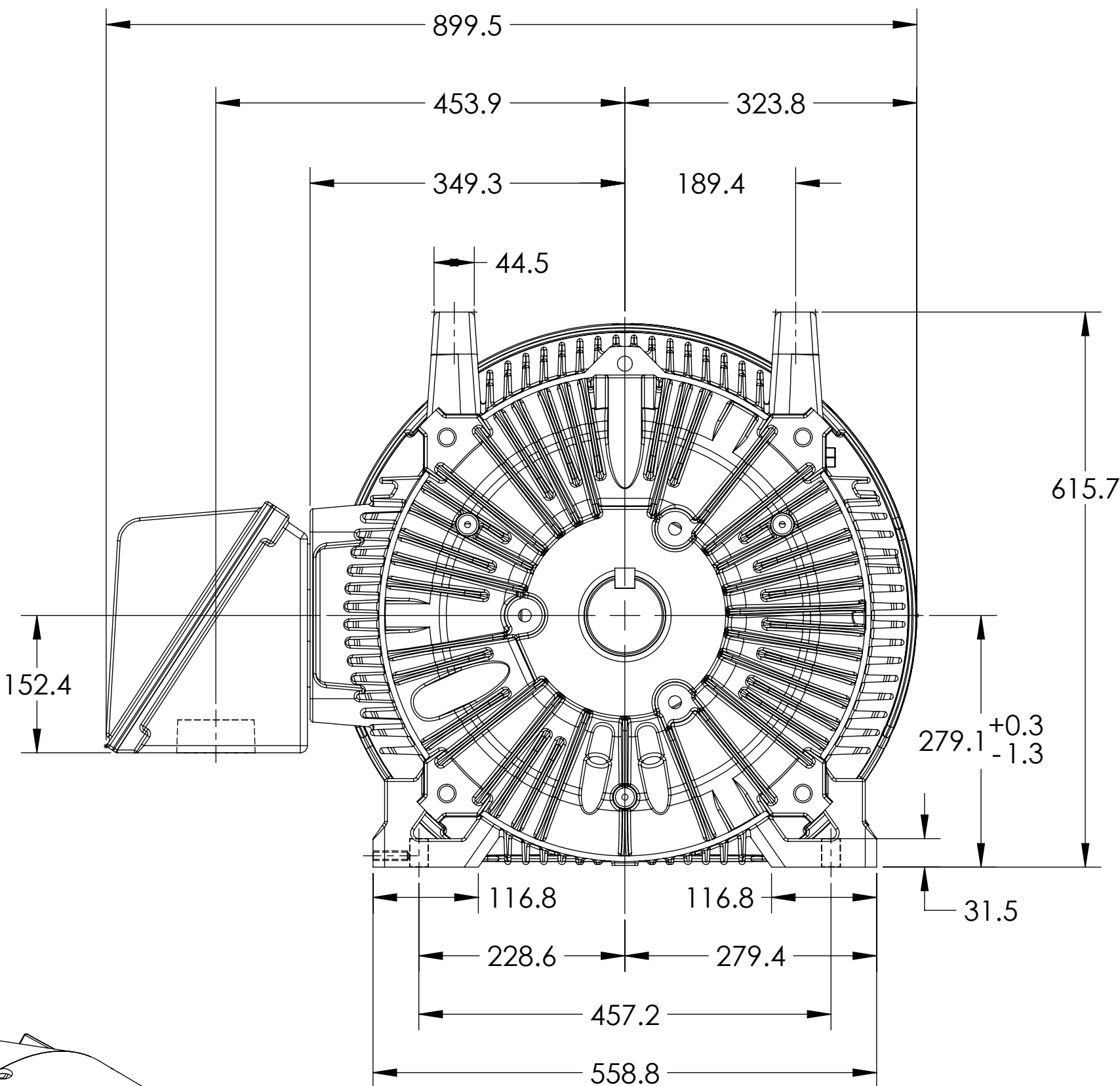
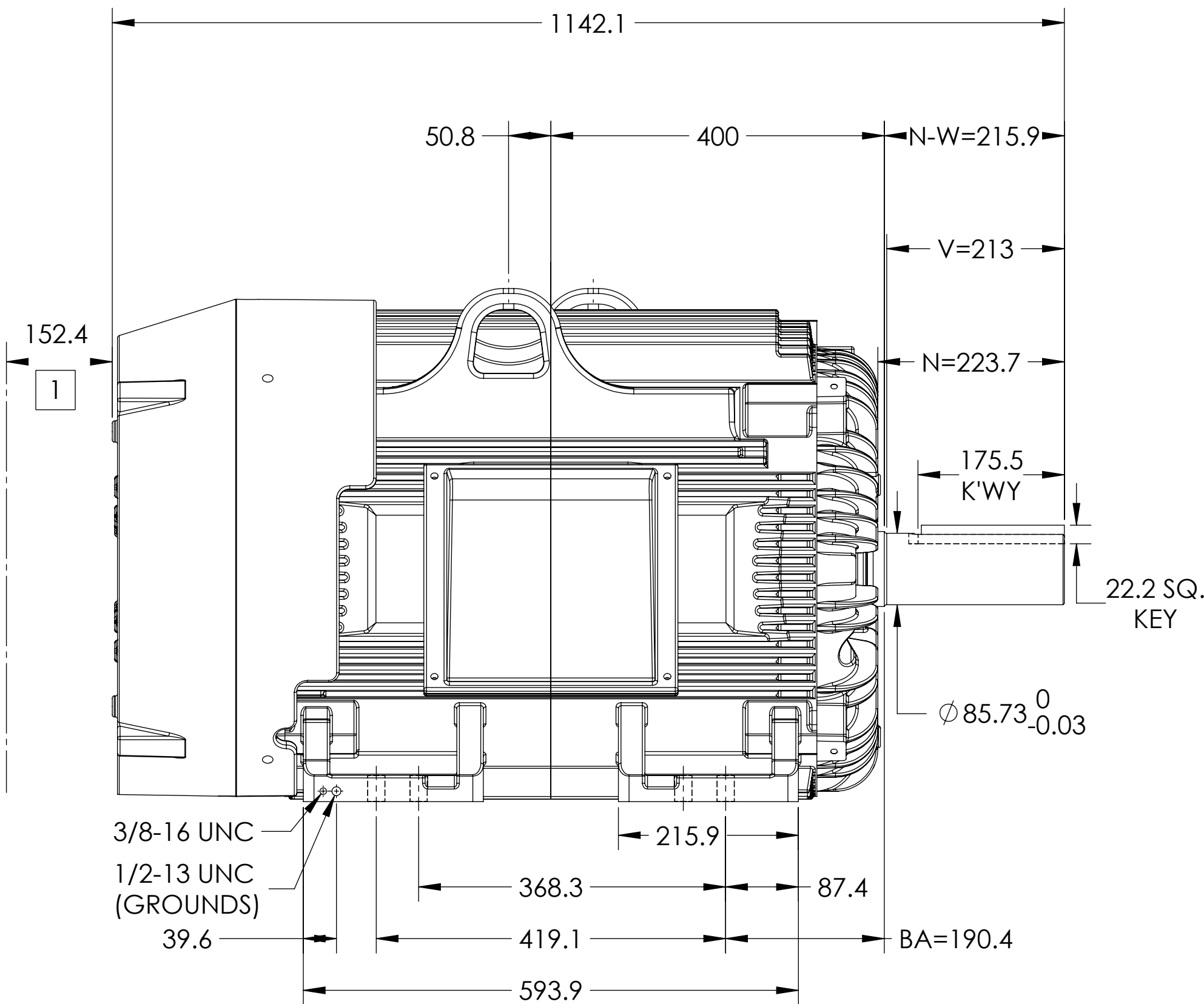

DIMENSIONS ARE IN MILLIMETERS.
WEIGHT (KG): 966, MOTOR WEIGHTS MAY VARY BY 15% DEPENDING ON RATING.
CUSTOMER IS RESPONSIBLE FOR DETERMINING THAT MOTOR PERFORMANCE IS SUITABLE IN THE APPLICATION.

REV. DESC: ADD ADDITIONAL FOOT MOUNTING DIMS TO THE DS			
REV: C	VERSION: 03	REVISED: 07:57:50 01/13/2023	TDR: 000001202430
MODEL NO. 617427-507		REF: -	
BY: USJEDIL		Material: -	C

BALDOR

G445/444T TEFC F1 FOOT CAST IRON BOX

SHEET NUMBER
2 OF 2

617427-507

1 OBSTRUCTION MUST NOT ENCR OACH ON AIR INLET.

IF MOUNTING CLEARANCE DETAILS ARE REQUIRED, CONSULT FACTORY.
MAX PERMISSIBLE SHAFT RUNOUT WHEN MEASURED AT END OF STANDARD SHAFT EXTENSION IS .076 T.I.R.

617427-507