



Customer information packet

JM3111

.75HP, 3450RPM, 3PH, 60HZ, 56J, 3416M, OPEN, F1

Class - None

Division - Not Applicable

Specifications

Enclosure	OPEN
Frame	56J
Frame Material	Steel
Frequency	60.00 Hz
Haz Area Class and Group	None
Haz Area Division	Not Applicable
Motor Letter Type	Three Phase
Output @ Frequency	.750 HP @ 60 HZ
Phase	3
Synchronous Speed @ Frequency	3600 RPM @ 60 HZ
Voltage @ Frequency	208.0 V @ 60 HZ 230.0 V @ 60 HZ 460.0 V @ 60 HZ
Agency Approvals	CSA UR
Ambient Temperature	40 °C
Auxillary Box	No Auxillary Box
Auxillary Box Lead Termination	None
Base Indicator	No Mounting
Bearing Grease Type	Polyrex EM (-20F +300F)
Blower	None
Current @ Voltage	4.000 A @ 208.0 V 3.200 A @ 208.0 V 3.000 A @ 230.0 V 1.500 A @ 460.0 V
Design Code	B
Drip Cover	Drip Cover
Duty Rating	CONT
Efficiency @ 100% Load	74.0 %
Electrically Isolated Bearing	Not Electrically Isolated
Feedback Device	NO FEEDBACK
Front Face Code	Drip Cover Mounting

Part detail

Revision	AA
Type	AC
Mech. spec.	34F038
Base	
Status	PRD/A
Elec. spec.	34WG2719
Layout	34LYF038
Eff. date	12-31-2024
CD Diagram	CD0005
Poles	02
Leads	9#18
Proprietary	False
Created date	01-01-0001

Front Shaft Indicator	None
Heater Indicator	No Heater
High Voltage Full Load Amps	1.5 a
Insulation Class	B
Inverter Code	Not Inverter
KVA Code	M
Lifting Lugs	No Lifting Lugs
Locked Bearing Indicator	Locked Bearing
Motor Lead Exit	Ko Box
Motor Lead Quantity/Wire Size	9 @ 18 AWG
Motor Lead Termination	Flying Leads
Motor Standards	NEMA
Motor Type	3416M
Mounting Arrangement	F1
Number of Poles	2
Overall Length	11.72 IN
Power Factor	66
Product Family	General Purpose
Pulley End Bearing Type	Ball
Pulley Face Code	C-Face
Pulley Shaft Indicator	Ext Thread
Rodent Screen	None
RoHS Status	ROHS COMPLIANT
Service Factor	1.50
Shaft Diameter	0.625 IN
Shaft Extension Location	Pulley End
Shaft Ground Indicator	No Shaft Grounding
Shaft Rotation	Reversible
Shaft Slinger Indicator	No Slinger
Speed	3450 rpm
Speed Code	Single Speed
Starting Method	Direct on line
Thermal Device - Bearing	None
Thermal Device - Winding	None

Vibration Sensor Indicator

No Vibration Sensor

Nameplate

NP1256L									
CAT.NO.	JM3111								
SPEC.	34F38-2719								
HP	.75								
VOLTS	208-230/460								
AMP	3.2-3/1.5								
RPM	3450								
FRAME	56J		HZ	60		PH	3		
SER.F.	1.50	CODE	M	DES	B	CLASS	B		
NEMA-NOM-EFF	74	PF	66						
RATING	40C AMB-CONT								
CC									
DE	6203		ODE	6203					
ENCL	OPEN	SN							
	SFA 4-3.8/1.9								

AC Induction Motor Performance Data

Record # 6656

Typical performance - not guaranteed values

Winding: 34WG2719-R001		Type: 3416M		Enclosure: TEFC	
Nameplate Data			460 V, 60 Hz: High Voltage Connection		
Rated Output (HP)	.75		Full Load Torque	1.1 LB-FT	
Volts	208-230/460		Start Configuration	direct on line	
Full Load Amps	3.2-3/1.5		Breakdown Torque	6.2 LB-FT	
R.P.M.	3450		Pull-up Torque	5.2 LB-FT	
Hz	60 Phase	3	Locked-rotor Torque	5.4 LB-FT	
NEMA Design Code	B KVA Code	M	Starting Current	11.4 A	
Service Factor (S.F.)	1.5		No-load Current	1.3 A	
NEMA Nom. Eff.	74 Power Factor	66	Line-line Res. @ 25°C	16.4 Ω	
Rating - Duty	40C AMB-CONT		Temp. Rise @ Rated Load	55°C	
S.F. Amps	4-3.8/1.9		Temp. Rise @ S.F. Load	78°C	

Load Characteristics 460 V, 60 Hz, 0.75 HP

% of Rated Load	25	50	75	100	125	150	S.F.
Power Factor	30	43	55	63	70	74	0
Efficiency	47.6	62.6	69.8	73	74.4	74.8	0
Speed	3569	3544	3518	3492	3463	3433	0
Line amperes	1.3	1.3	1.4	1.5	1.7	1.9	1.9

ABB Motors and Mechanical Inc.

WINDING # 34WG2719

Typical performance - not guaranteed values.

0.75 HP 3 PH 60 HZ 3450 RPM 460 V 3416M

TORQUES (LB-FT) : PO=6.2 PU=5.2 LR=5.4 LRA=11.4

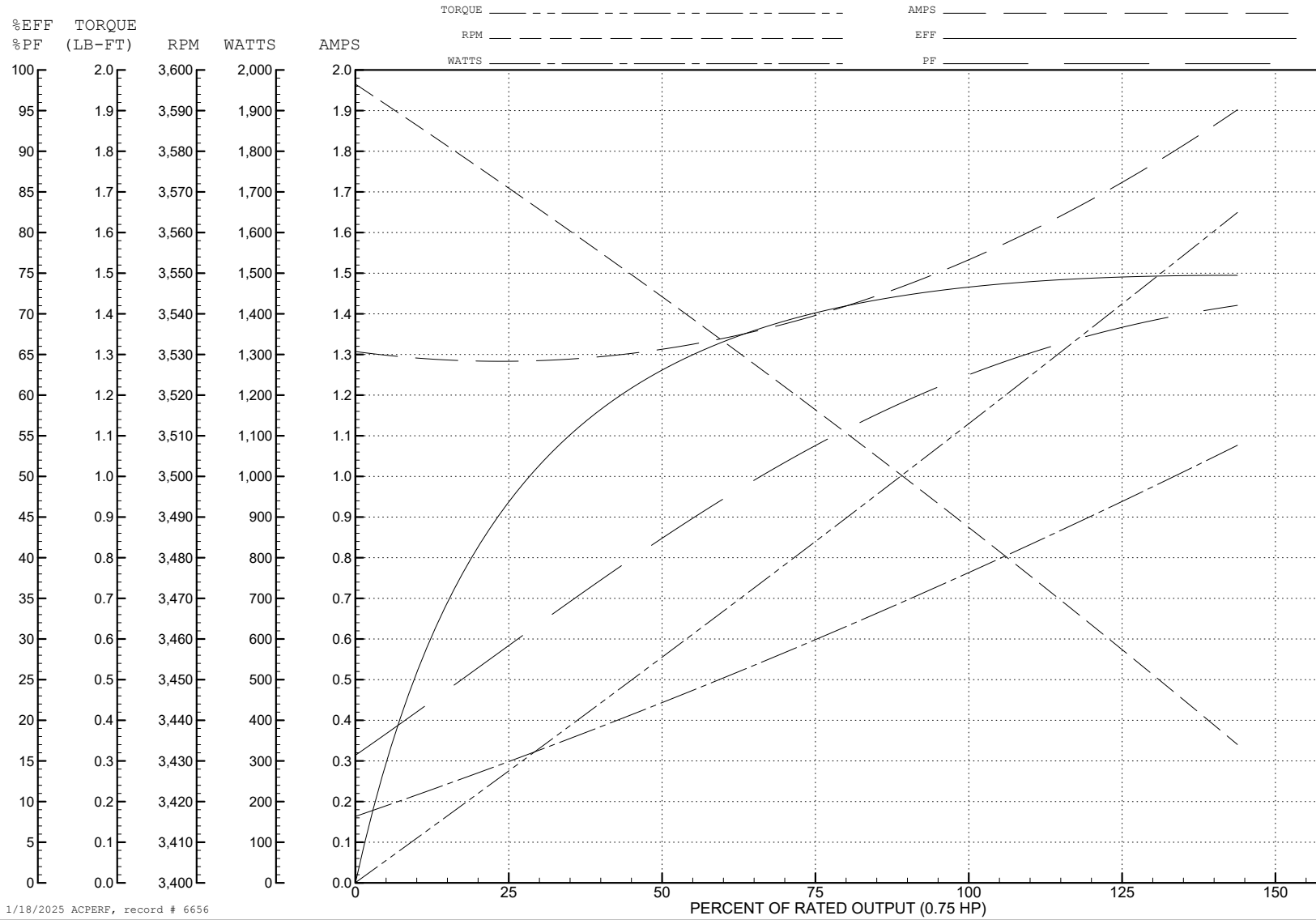

1/18/2025 ACPERF, record # 6656

34LYF038

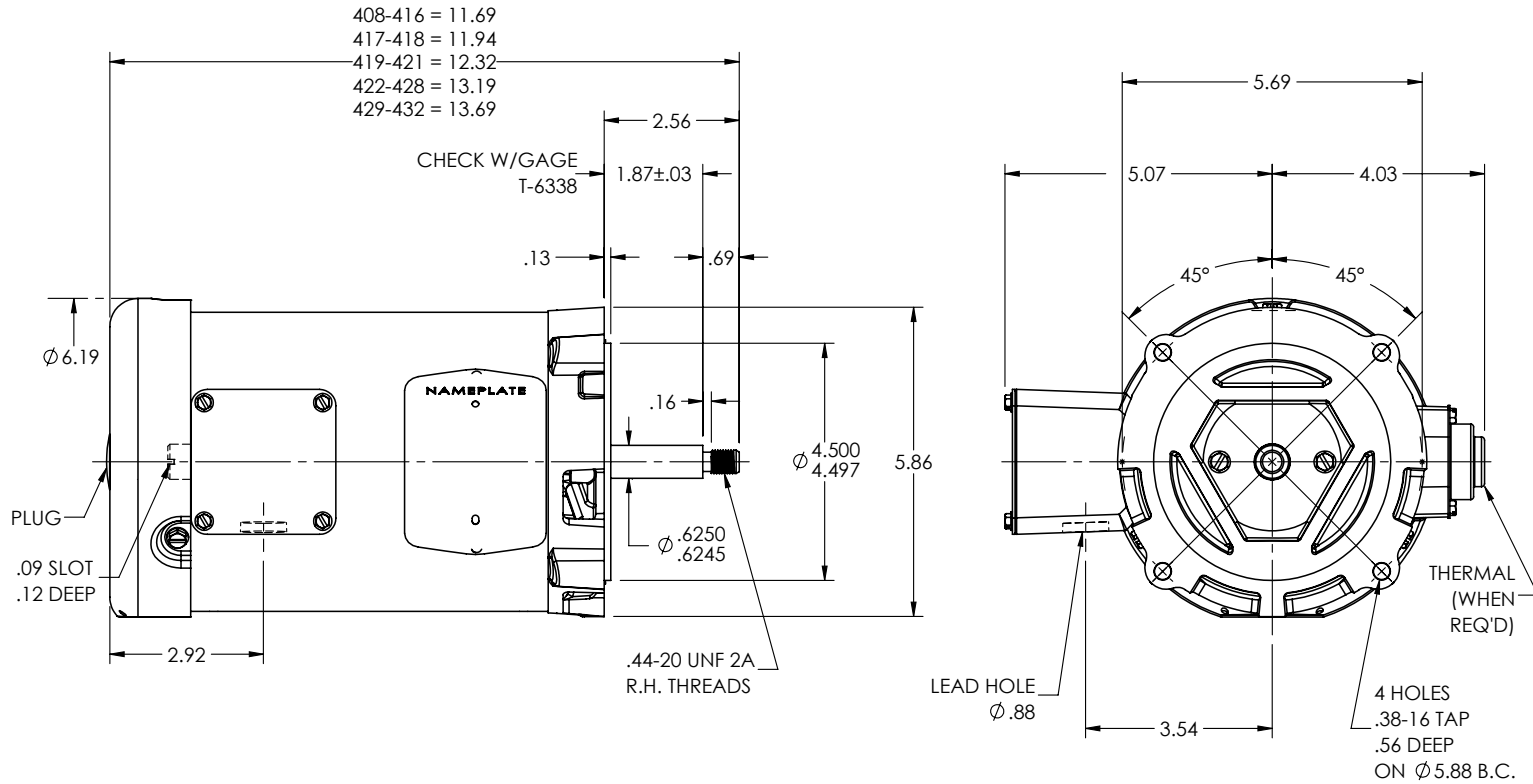

CUSTOMER IS RESPONSIBLE FOR DETERMINING THAT THE PRODUCT WILL PERFORM SUITABLY IN THE INTENDED APPLICATION

REV. DESC: LOAD TO SOLIDWORKS - REV H			
REV: J	VERSION: 02	REVISED: 09:33:54 12/19/2022	TDR: 000001201165
34LYF038	MODEL NO. 34LYF038	REF: -	
	BY: ENFRAJ0		

BALDOR - RELIANCE®

STD VERT 56J OPEN 34M W/DRIP CVR

34LYF038

CD0005

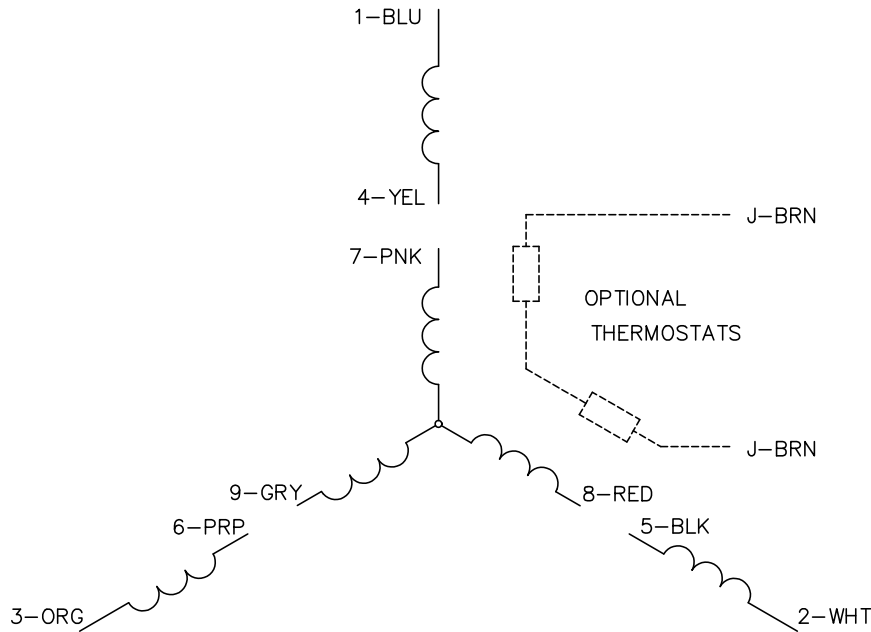

LOW VOLTAGE
(2Y)



LINE

HIGH VOLTAGE
(1Y)



LINE

NOTES:

1. INTERCHANGE ANY TWO LINE LEADS TO REVERSE ROTATION.
2. OPTIONAL THERMOSTATS ARE PROVIDED WHEN SPECIFIED.
3. ACTUAL NUMBER OF INTERNAL PARALLEL CIRCUITS MAY BE A MULTIPLE OF THOSE SHOWN ABOVE.
4. LEAD COLORS ARE OPTIONAL. LEADS MUST ALWAYS BE NUMBERED AS SHOWN.

CD0005

REV. DESC: REVISE TO SHOW OPTIONAL COLORS			
REV. LTR: E	BY: JLP	REVISED: 01/19/99 10:15	TDR: 0171435
S00000		FILE: AAA00005140	MDL: -
		MTL: -	

BALDOR ELECTRIC Co.

3PH, DV, 9 LEADS