

DUTY MASTER ALTERNATING CURRENT MOTORS

616512-525

SQUIRREL-CAGE INDUCTION

ENCLOSURE: TOTALLY ENCLOSED

FRAME 365T

COOLING: FAN-COOLED

MOUNTING: FOOT

INCLUDES 364T FRAME MOUNTING HOLES

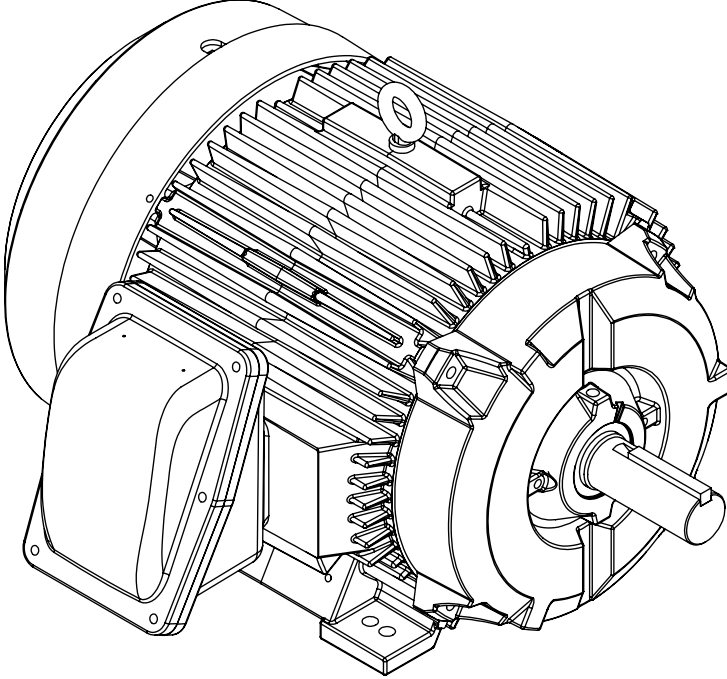
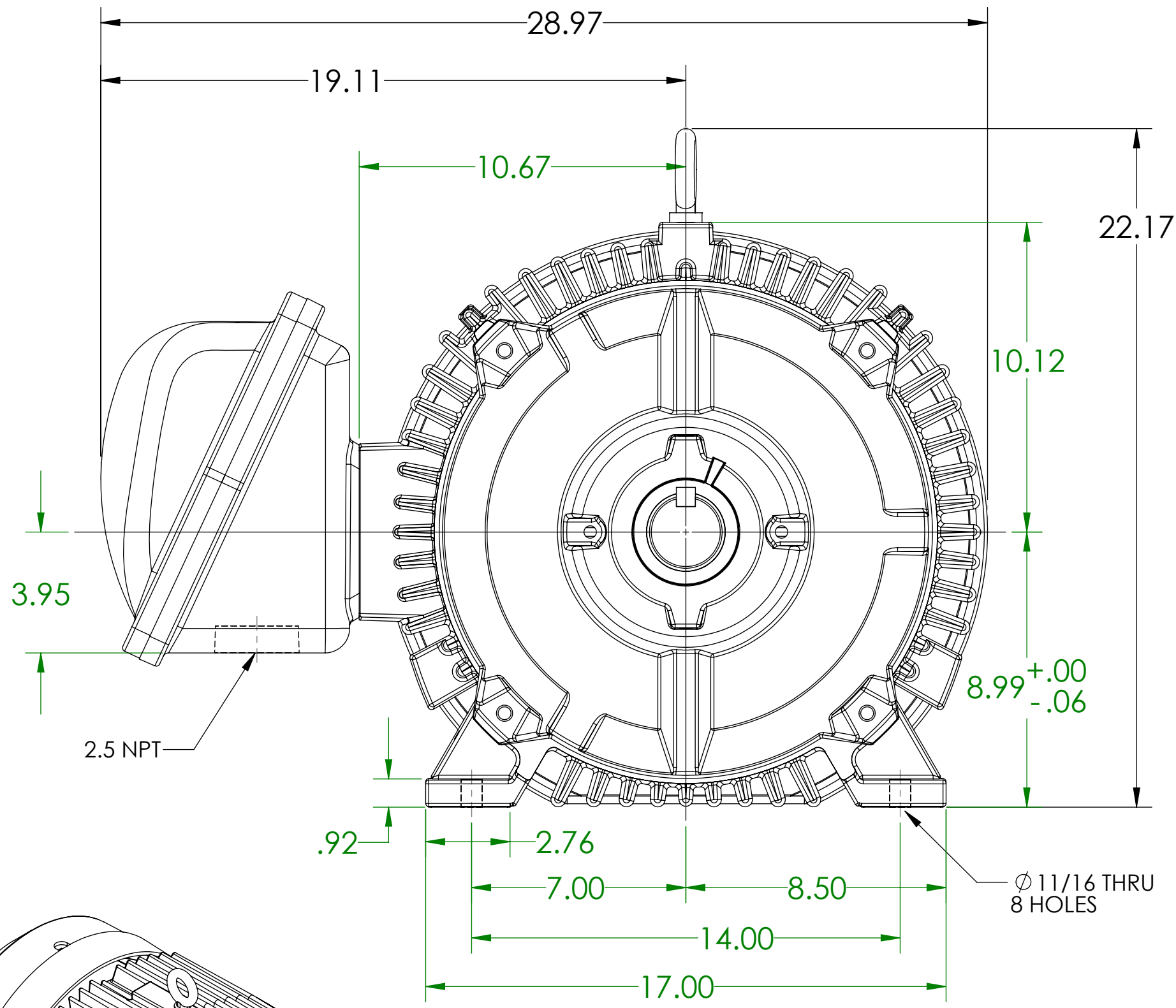
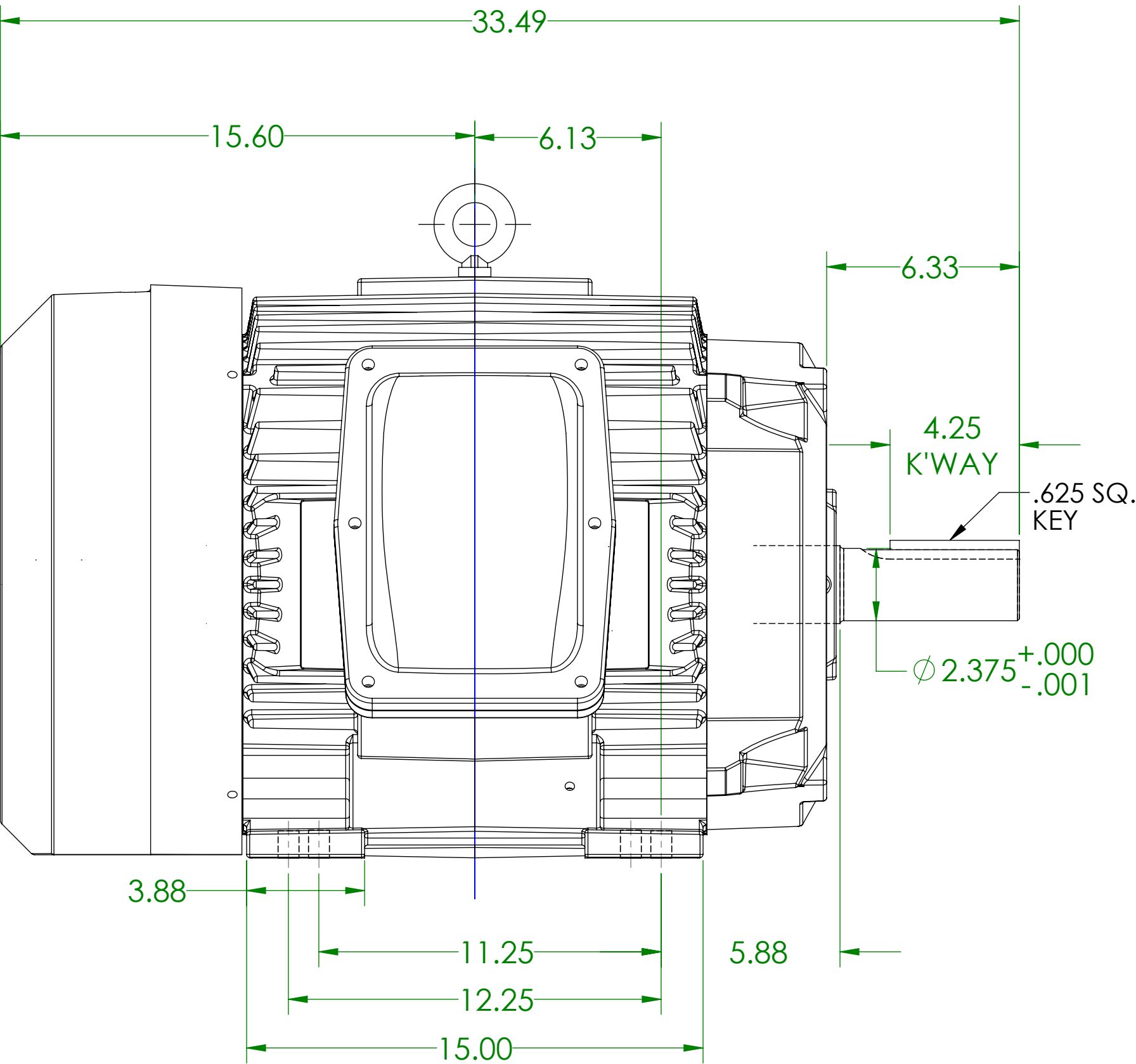

DIMENSIONS ARE IN INCHES

CUSTOMER IS RESPONSIBLE FOR DETERMINING THAT MOTOR PERFORMANCE IS SUITABLE IN THE APPLICATION.

REV. DESC: NEW ISSUE			
REV: -	VERSION: 00	REVISED: 04:28:17 03/10/2016	TDR: 000000970300
MODEL NO. 616512-525			
BY: RAGGDM			

BALDOR

E365T 6313 FCXP W/BOLT ON CONDUIT BOX -- CLASS 1 GR D

SHEET NUMBER
1 OF 1

525-1651

IF MOUNTING CLEARANCE DETAILS ARE REQUIRED, CONSULT FACTORY.
MAXIMUM PERMISSIBLE SHAFT RUNOUT WHEN MEASURED AT END OF
STANDARD SHAFT EXTENSION IS .001" T.I.R.

616512-525