

# ABB BALDOR RELIANCE III

---

## Customer information packet

### IDVSM4407T-4

200HP, 1790-2685RPM, 3PH, 60-90HZ, 447T, A441

Class - None

Division - Not Applicable

**Specifications**

<b>Enclosure</b>	TEFC
<b>Frame</b>	447T
<b>Frame Material</b>	Iron
<b>Frequency</b>	60.00 Hz 90.00 Hz
<b>Haz Area Class and Group</b>	None
<b>Haz Area Division</b>	Not Applicable
<b>Motor Letter Type</b>	Three Phase
<b>Output @ Frequency</b>	200.000 HP @ 90 HZ 200.000 HP @ 60 HZ
<b>Phase</b>	3
<b>Synchronous Speed @ Frequency</b>	1800 RPM @ 60 HZ
<b>Voltage @ Frequency</b>	460.0 V @ 60 HZ 460.0 V @ 90 HZ
<b>Agency Approvals</b>	CCSA US
<b>Ambient Temperature</b>	40 °C
<b>Auxiliary Box</b>	NO AUXILLARY BOX
<b>Base Indicator</b>	Rigid
<b>Bearing Grease Type</b>	Polyrex EM (-20F +300F)
<b>Constant Torque Speed Range</b>	1000:1
<b>Current @ Voltage</b>	218.000 A @ 460.0 V 226.000 A @ 460.0 V
<b>Design Code</b>	A
<b>Drip Cover</b>	No Drip Cover
<b>Duty Rating</b>	CONT
<b>Efficiency @ 100% Load</b>	95.4 %
<b>Feedback Device</b>	NO FEEDBACK
<b>Heater Indicator</b>	No Heater
<b>High Voltage Full Load Amps</b>	218.0 a
<b>Insulation Class</b>	F
<b>Inverter Code</b>	Inverter Duty
<b>KVA Code</b>	L

**Part Detail**

<b>Revision</b>	Q
<b>Type</b>	AC
<b>Mech. spec.</b>	
<b>Base</b>	
<b>Status</b>	PRD/A
<b>Elec. spec.</b>	A44WG1128
<b>Layout</b>	617435-137
<b>Eff. date</b>	03-26-2026
<b>CD Diagram</b>	416820-036
<b>Poles</b>	04
<b>Leads</b>	3#1/0 (02 per group)
<b>Proprietary</b>	False
<b>Created date</b>	08-23-2012

<b>Lifting Lugs</b>	<b>Standard Lifting Lugs</b>
<b>Max Speed</b>	3600 rpm
<b>Motor Lead Quantity/Wire Size</b>	6 @ 1/0 AWG
<b>Motor Standards</b>	NEMA
<b>Motor Type</b>	A44106M
<b>Mounting Arrangement</b>	F1
<b>Number of Poles</b>	4
<b>Overall Length</b>	48.24 IN
<b>Power Factor</b>	87
<b>Pulley End Bearing Type</b>	Ball
<b>Pulley Face Code</b>	Standard
<b>Service Factor</b>	1.00
<b>Shaft Diameter</b>	3.375 IN
<b>Shaft Ground Indicator</b>	No Shaft Grounding
<b>Shaft Rotation</b>	Reversible
<b>Shaft Slinger Indicator</b>	No Slinger
<b>Speed</b>	1790 rpm 2685 rpm
<b>Speed Code</b>	Single Speed
<b>Starting Method</b>	Direct on line
<b>Thermal Device - Bearing</b>	None
<b>Thermal Device - Winding</b>	Normally Closed Thermostat

**Nameplate**

**000613007HV**

<b>CAT NO</b>	IDVSM4407T-4	<b>SPEC NO.</b>	P44G4010					
<b>SER.NO.</b>		<b>FRAME</b>	447T					
	<b>HP</b>	<b>RPM</b>	<b>VOLTS</b>	<b>AMPS</b>	<b>HZ</b>	<b>TYPE</b>	<b>P</b>	
<b>BASE</b>	200	1790	460	226	60	SF	1.00	
<b>MAX</b>	200	2685	460	218	90	<b>INSUL.CLASS</b>	F	
<b>DRIVE END BEARING</b>	90BC03J30X	<b>CONSTANT TORQUE</b>		<b>DUTY</b>	CONT	<b>AMB</b>	40	
<b>OPP D.E. BEARING</b>	6318C3VL0241	1000:1	<b>ENCL</b>	TEFC	<b>PHASE</b>	3		
<b>DESIGN NO.</b>	A44WG1128-R001	<b>FLUX AMPS</b>	75.6		<b>VPWM INVERTER READY</b>			
<b>MAX SPEED/RPM</b>	3600	<b>OVERTEMP PROT</b>	2	<b>WK2</b>	70.1	<b>POLES</b>	4	<b>WEIGHT</b>

REL S.O.	-	VOLTS	460	ENCLOSURE	TEFC	WYE CONN EQ CKT OHMS PER PHASE			
FRAME	447T	AMPS	226	MAX SAFE RPM	3600	(AT BASE RATING, 25 °C)			
HP	200	DUTY	CONT	IM (AMPS)	75.6	R1	.00721	X1	.0917
BASE SPEED	1790	S.F.	1.0	P.F. @NL/FL	.069/.867	R2	.00459	X2	.0885
PHASE/HERTZ	3/60	AMB °C/INSUL	40/F	WK <sup>2</sup> (Lb-Ft <sup>2</sup> )	70.1			XM	2.97

**RATED FULL LOAD DATA**

	RPM	HP	TORQUE LB-FT	FUND VOLTS	FREQ-HZ	AMPS
BASE SPEED	1792	200	586	460	60	226
MAX SPEED	2687	200	391	460	90	218
MIN SPEED	0	0	586	6.20	.281	226

**LOAD PERFORMANCE AT BASE SPEED**

	RPM	HP	TORQUE LB-FT	FUND VOLTS	FREQ-HZ	AMPS
NO LOAD	1800	0	0	460	60	75.4
1/4	1798	50.0	146	460	60	104
1/2	1796	100	293	460	60	138
3/4	1794	150	439	460	60	180
FULL LOAD	1792	200	586	460	60	226
O/L	1782	398	1173	460	60	434

**BLOWER  
DATA**

VOLTS	PH/HZ	FL AMPS	LR AMPS	FRAME	CFM

REMARKS: CALCULATED DATA  
VECTOR PWM INVERTER DUTY



DR. BY B. R. PENDLEY  
 CK. BY W. L. SMITH  
 APP. BY W. L. SMITH  
 DATE 09/07/04

**A-C MOTOR  
PERFORMANCE DATA**      **A44WG1128-R001**  
 ISSUE DATE      04/05/11

REL S.O.	-	VOLTS	460	ENCLOSURE	TEFC	WYE CONN EQ CKT OHMS PER PHASE	
FRAME	447T	AMPS	226	MAX SAFE RPM	3600	(AT BASE RATING, 25 °C)	
HP	200	DUTY	CONT	IM (AMPS)	75.6	R1	.00721 X1 .0917
BASE SPEED	1790	S.F.	1.0	P.F. @NL/FL	.069/.867	R2	.00459 X2 .0885
PHASE/HERTZ	3/60	AMB °C/INSUL	40/F	WK <sup>2</sup> (Lb-Ft <sup>2</sup> )	70.1		XM 2.97

VECTOR PWM INVERTER DUTY  
VARIABLE SPEED AC MOTOR CURVES

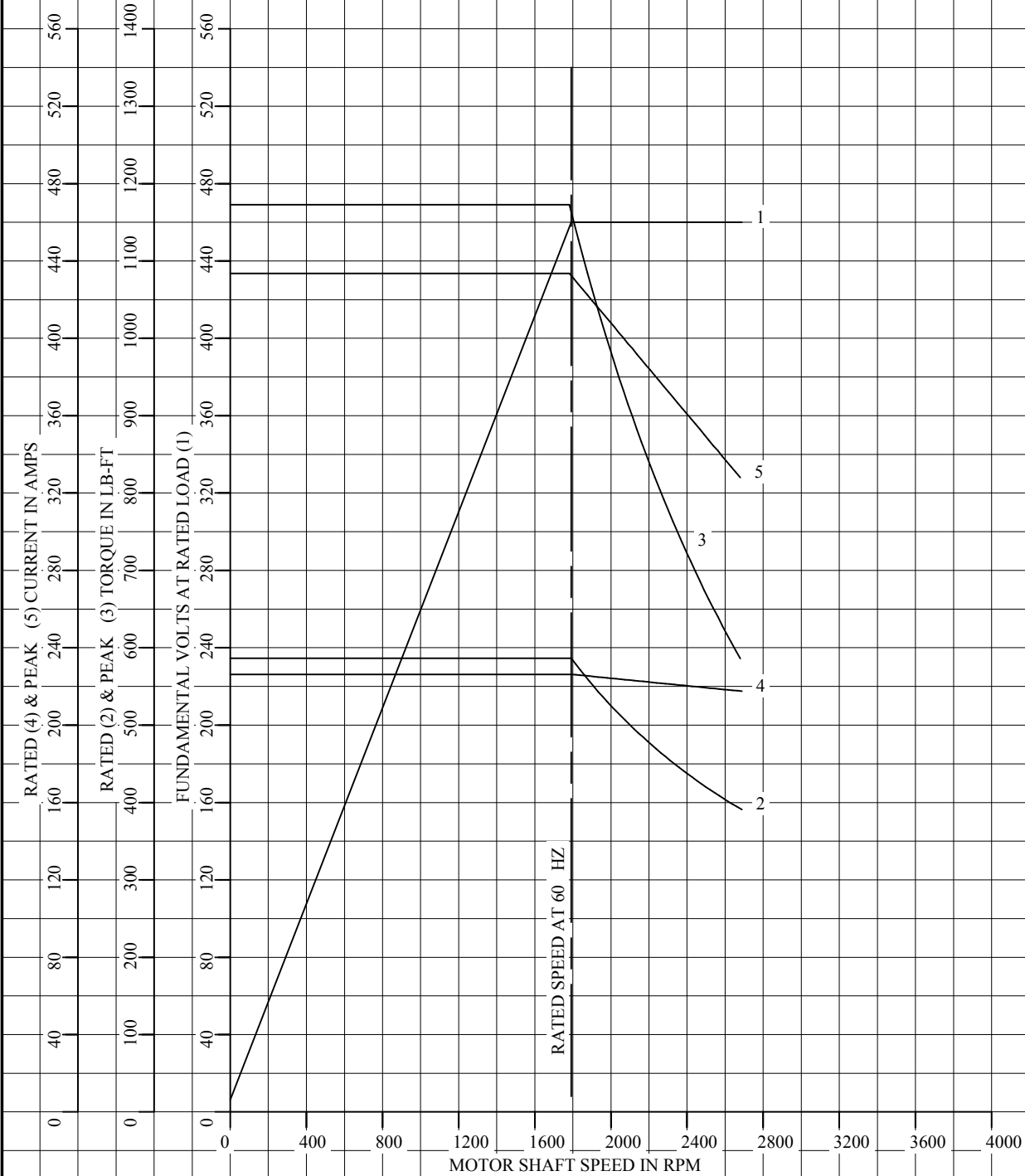

REMARKS: CALCULATED DATA  
DATA VALID FOR NAMEPLATE SPEED RANGE ONLY



DR. BY B.R.PENDLEY  
CK. BY W.L.SMITH  
APP. BY W.L.SMITH  
DATE 09/07/04

**A-C MOTOR  
PERFORMANCE  
CURVES** A44WG1128-R001  
SH 1 OF 2  
ISSUE DATE 04/05/11

REL S.O.	-	VOLTS	460	ENCLOSURE	TEFC	WYE CONN EQ CKT OHMS PER PHASE	
FRAME	447T	AMPS	226	MAX SAFE RPM	3600	(AT BASE RATING, 25 °C)	
HP	200	DUTY	CONT	IM (AMPS)	75.6	R1 .00721	X1 .0917
BASE SPEED	1790	S.F.	1.0	P.F. @NL/FL	.069/.867	R2 .00459	X2 .0885
PHASE/HERTZ	3/60	AMB °C/INSUL	40/F	WK <sup>2</sup> (Lb-Ft <sup>2</sup> )	70.1		XM 2.97

VECTOR PWM INVERTER DUTY  
LOAD PERFORMANCE (CONSTANT V/HZ RANGE)

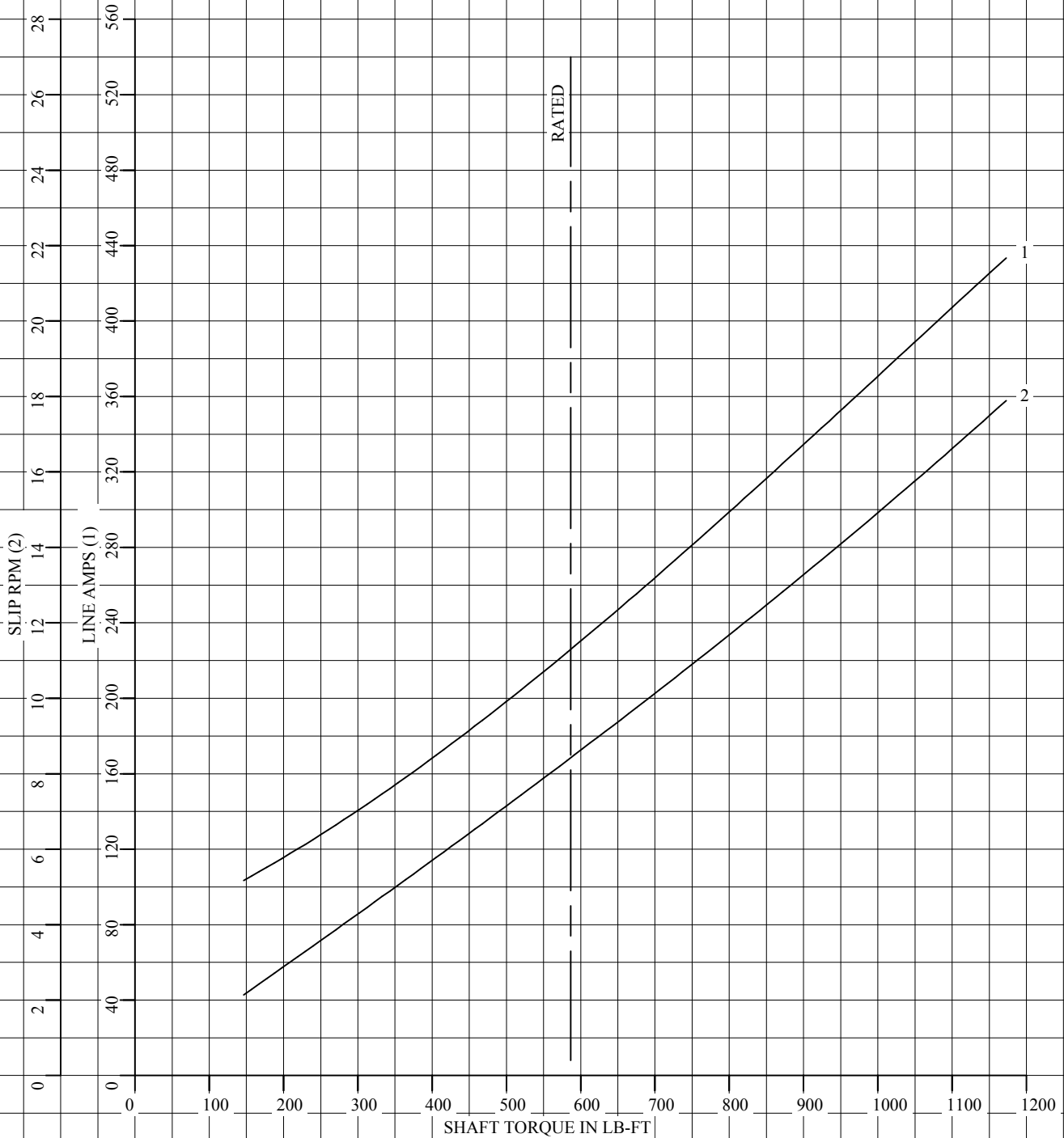

REMARKS: CALCULATED DATA  
DATA VALID FOR NAMEPLATE SPEED RANGE ONLY



DR. BY B.R.PENDLEY  
CK. BY W.L.SMITH  
APP. BY W.L.SMITH  
DATE 09/07/04

**A-C MOTOR  
PERFORMANCE  
CURVES** A44WG1128-R001  
SH 2 OF 2  
ISSUE DATE 04/05/11

**DUTY MASTER ALTERNATING CURRENT MOTORS**  
SQUIRREL-CAGE INDUCTION

ENCLOSURE: TOTALLY ENCLOSED

MOUNTING: FOOT, F1

G447T/G445T FRAME MOUNTING HOLES

COOLING: FAN COOLED

STEEL CONDUIT BOX

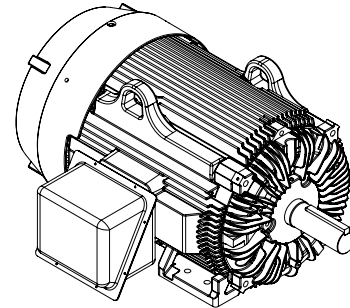
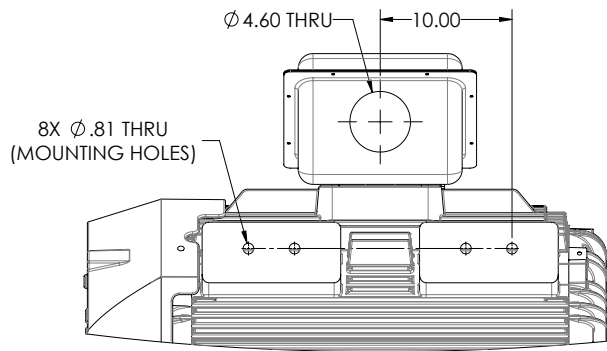
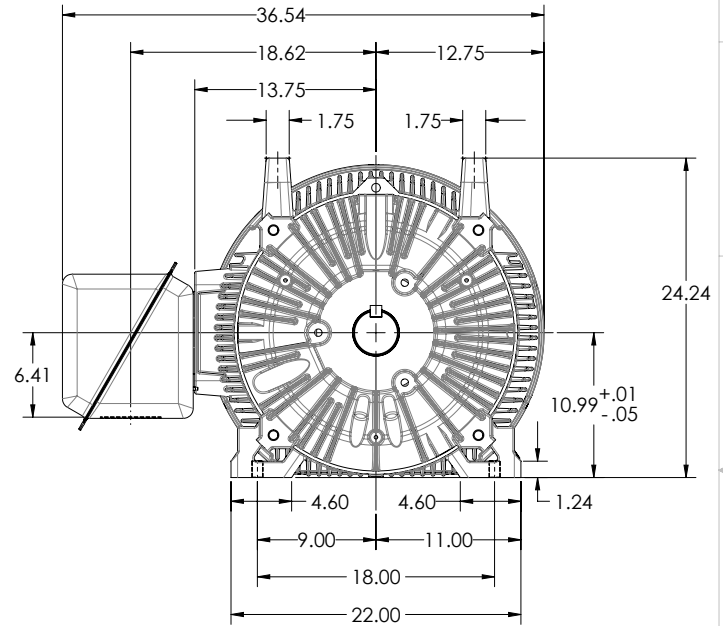
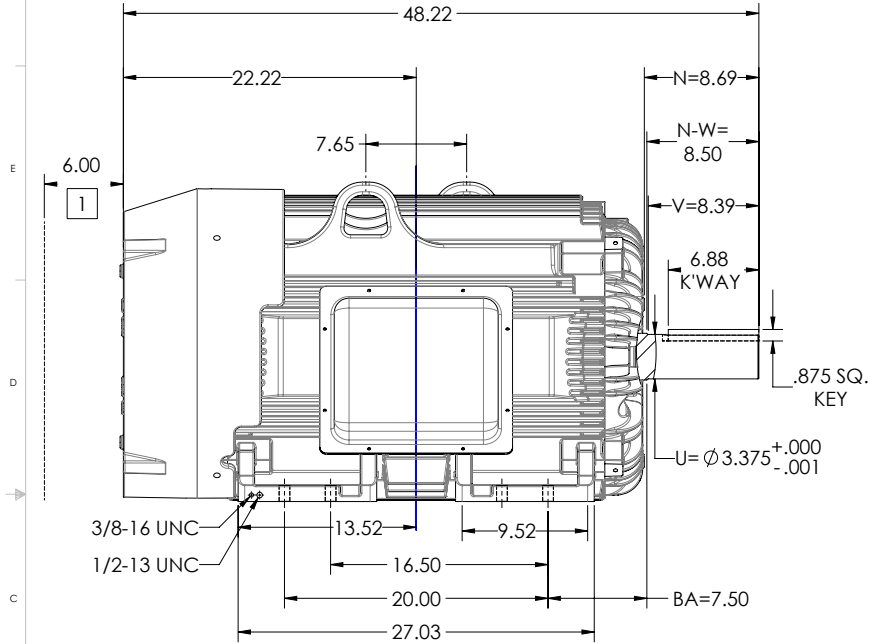

1 OBSTRUCTION MUST NO ENCR OACH ON AIR INLET

SHEET NUMBER  
**1 OF 1**  
L&T-557219

IF MOUNTING CLEARANCE DETAILS ARE REQUIRED, CONSULT FACTORY.  
MAXIMUM PERMISSIBLE SHAFT RUNOUT WHEN MEASURED AT END OF  
STANDARD SHAFT EXTENSION IS .003

DIMENSIONS ARE IN INCHES.  
WEIGHT (LBS): 2515, MOTOR WEIGHTS MAY VARY BY 15% DEPENDING ON RATING.  
CUSTOMER IS RESPONSIBLE FOR DETERMINING THAT MOTOR PERFORMANCE IS SUITABLE IN THE APPLICATION.

REV. DESC: NEW DRAWING			
REV: -	VERSION: 00	REVISED: 11-29-02 06/27/2016	TDR: 00000984408
MODEL NO. 617435-137		REF: -	
BY: USJEDIL	Material: -		

**BALDOR**

G447T/445T TEFC F1 FOOTED SIDE/CENTER STEEL CONDUIT BOX

416820-036

**A-C MOTOR  
CONNECTION DIAGRAM  
STANDARD 3 LEAD CONNECTED**

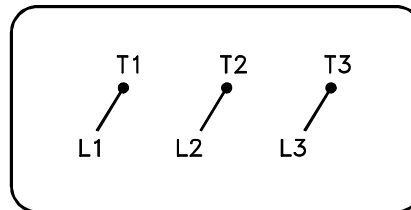

(N.P. 1575-BA)

416820-036

REV. DESC: LOADED TO BUS, C/R 335225		
REV. LTR: -	VERSION: 00	TDR: 000000538207
FILE: \MGA\00000\682	REVISED: 11: 54: 06 04/30/2010	
MTL: -	BY: RAGRA	

**BALDOR**

CONN DIAG - STANDARD 3 LEAD  
SH 1 of 1