

RPM-AC FINNED FRAME VARIABLE SPEED ALTERNATING
CURRENT MOTOR
FL2162C

ENCLOSURE: TOTALLY ENCLOSED
MOUNTING: FOOT/NEMA 210TC C-FACE
DRIVE METHOD: COUPLED OR BELTED

COOLING: NON-VENTILATED
ACCESSORIES: PROVISIONS FOR
TACHOMETER MOUNTING
ONLY WHEN SPECIFIED

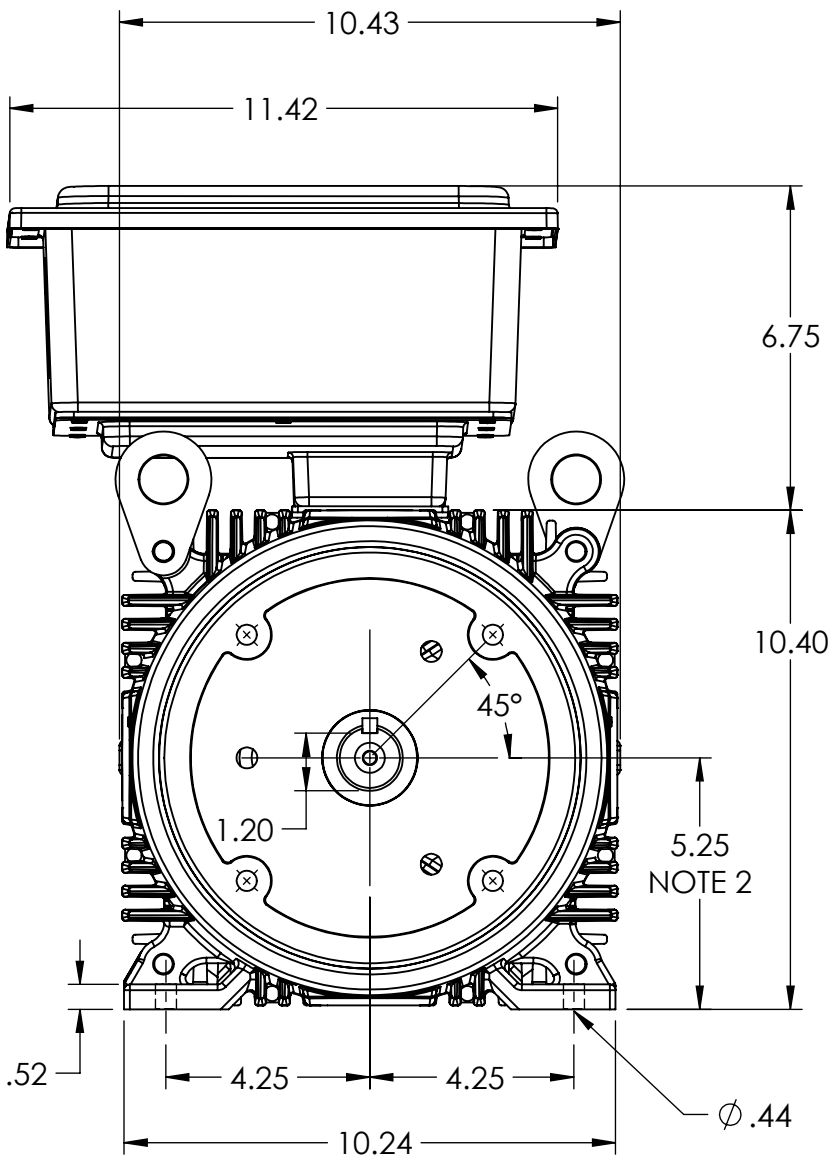
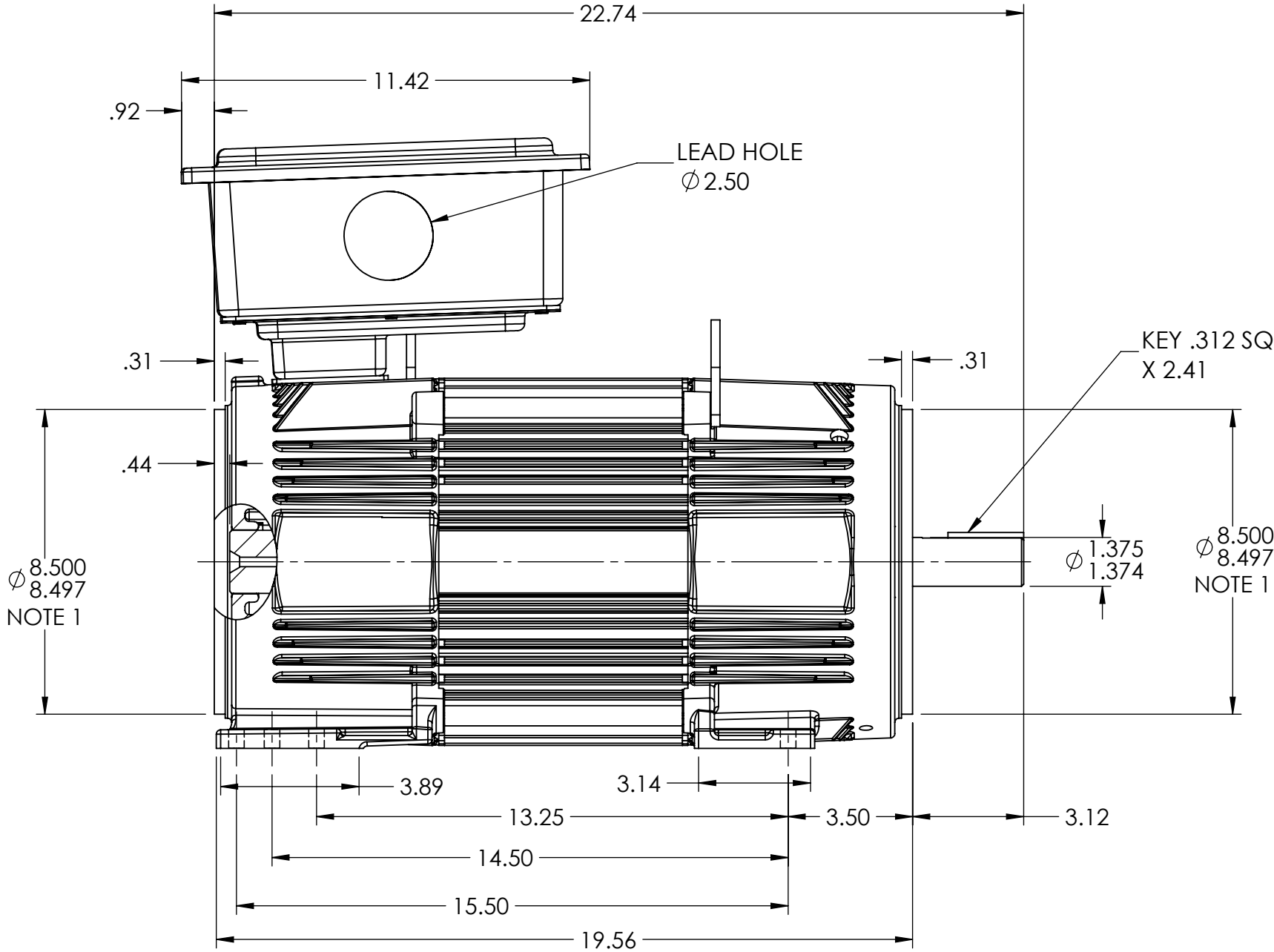

DIMENSIONS ARE IN INCHES SCALE: 1.00
MOTOR WEIGHT: 280 LBS. (MAY VARY 15%)

235 AMP TERMINAL BOX SHOWN
ROTATABLE IN 90° INCREMENTS

NOTE 1 O.D.E. C-FACE & TACHOMETER MOUNTING
1/2-13 TAP, .88 IN. DEEP, ON A Ø 7.25 IN. BOLT CIRCLE
FACE RUNOUT AND ECCENTRICITY .004 MAX T.I.R.

NOTE 2 SHAFT HEIGHT WILL NOT BE EXCEEDED.
SHIMS UP TO .05mm IN THICKNESS ARE USUALLY
REQUIRED FOR COUPLED OR GEARED MACHINES.

CUSTOMER IS RESPONSIBLE FOR DETERMINING THAT THE PRODUCT WILL PERFORM SUITABLY IN THE INTENDED APPLICATION

REV. DESC: MODEL AND REDRAW IN SOLIDWORKS			
REV: A	VERSION: 01	REVISED: 01:42:57 01/26/2023	TDR: 000001202962
MODEL NO. 617516-063			REF: -
BY: USWATUR			B

BALDOR - RELIANCE®

DIM SHT RPMAC TENV FL2162C FT MT PROV FOR TACH,F3 MILL BOX

617516-063

617516-063