

DUTY MASTER ALTERNATING CURRENT MOTORS
SQUIRREL-CAGE INDUCTION

617435-427

ENCLOSURE: TOTALLY ENCLOSED

MOUNTING: FOOT, F-1

GL449TS/449TS FRAME MOUNTING

COOLING: FAN COOLED

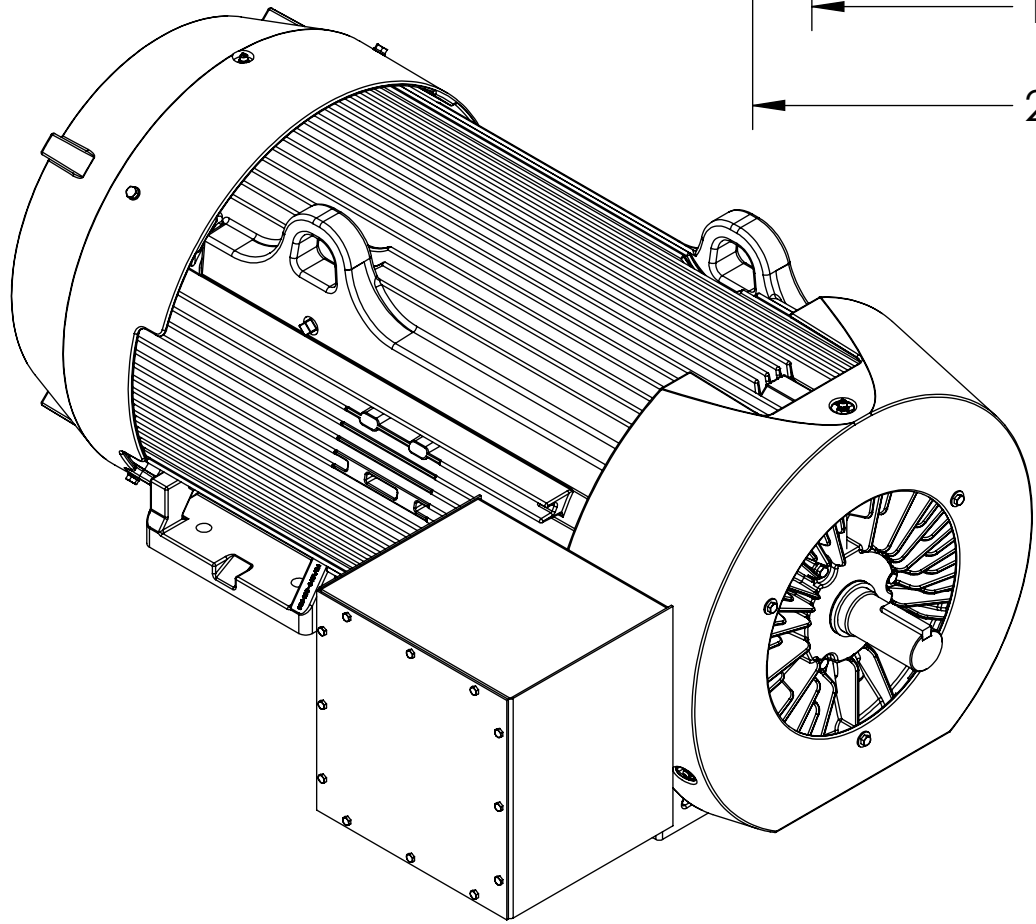
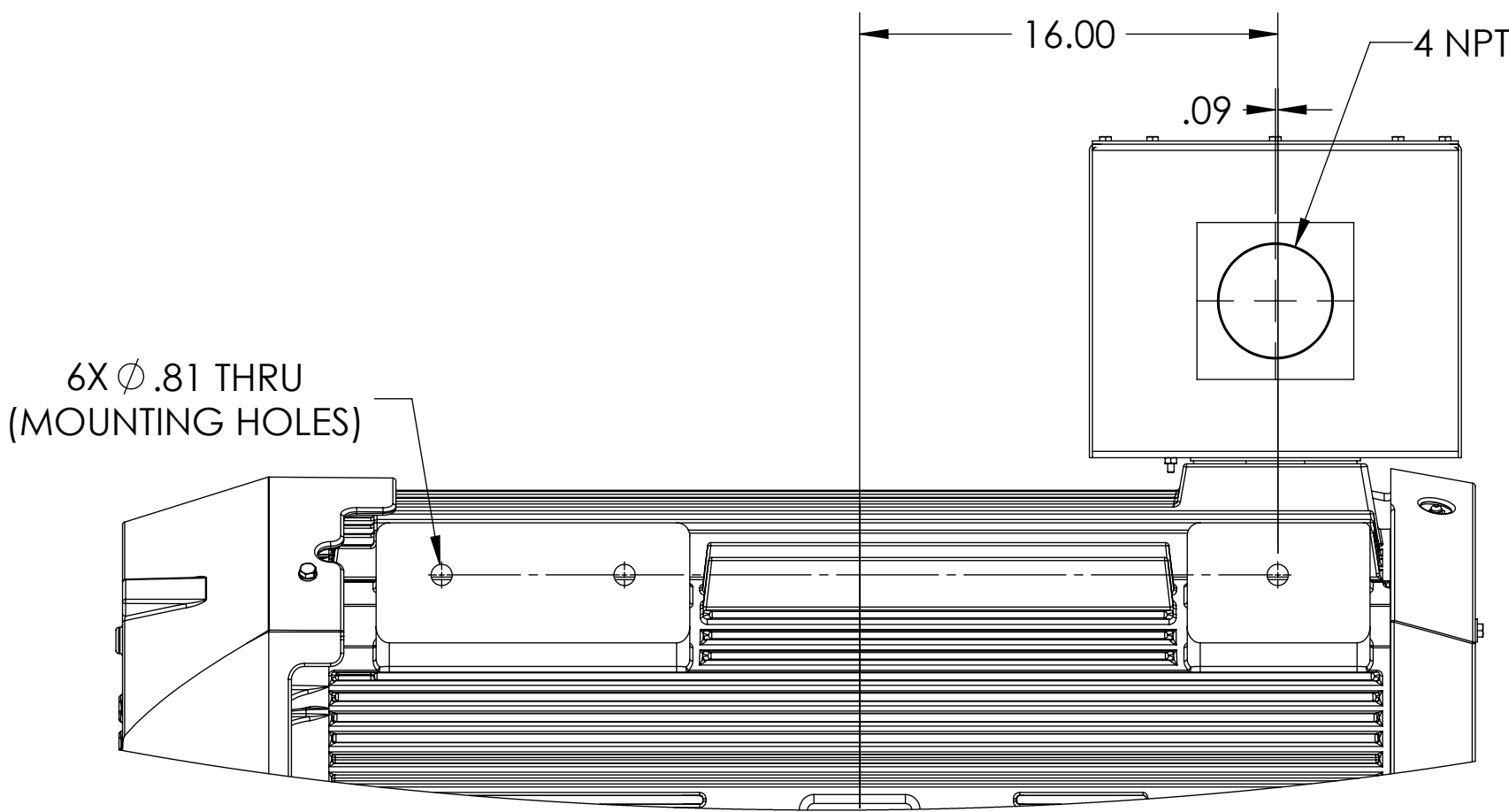
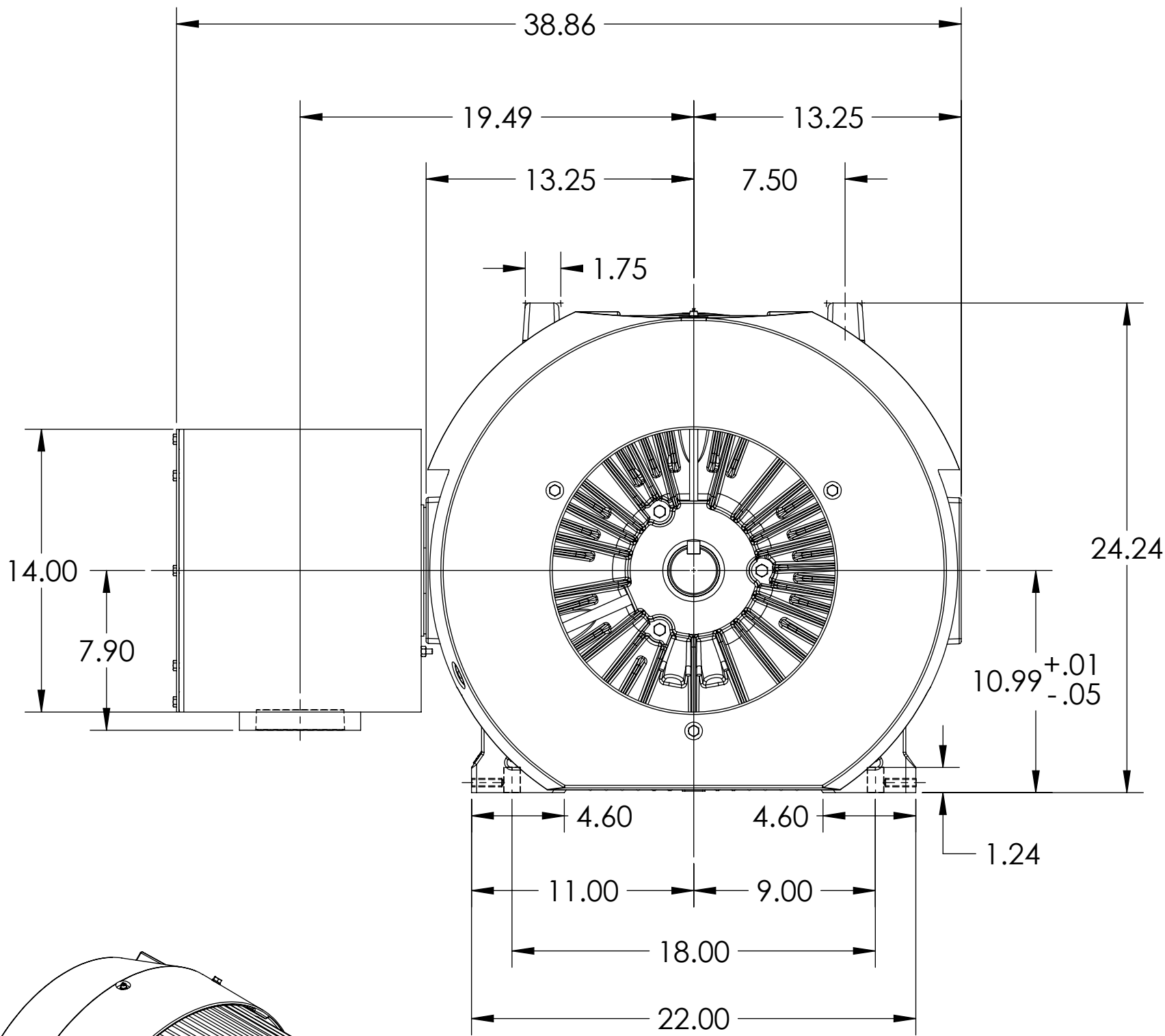
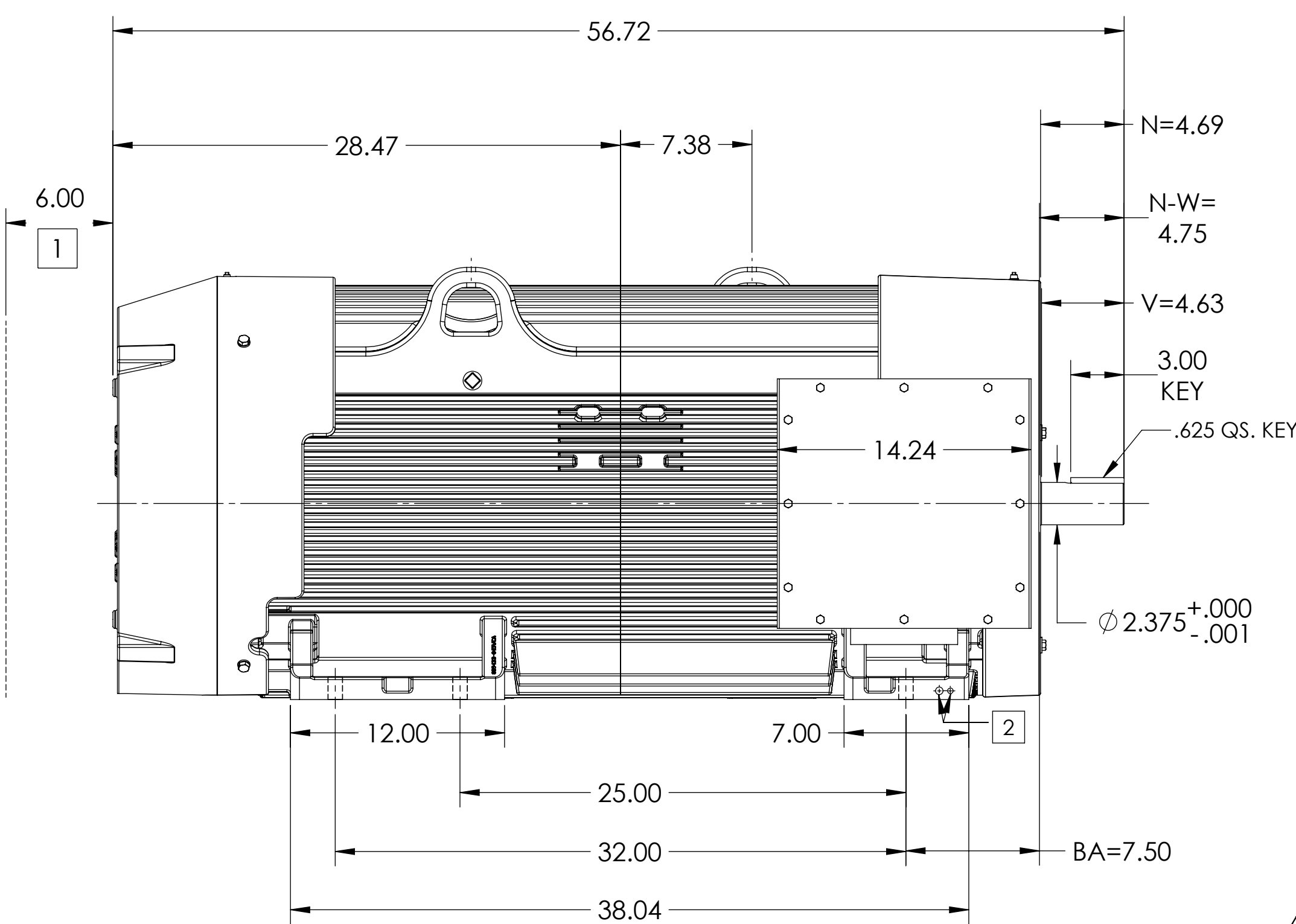

DRIVE END AIR DEFLECTOR IS ONLY INCLUDED WHEN SPECIFIED

DIMENSIONS ARE IN INCHES.
CUSTOMER IS RESPONSIBLE FOR DETERMINING THAT MOTOR PERFORMANCE IS SUITABLE IN THE APPLICATION.

REV. DESC: ADD NOTE REGARDING AIR DEFLECTOR			
REV: C	VERSION: 03	REVISED: 07:44:30 02/27/2024	TDR: 000001226889
MODEL NO. 617435-427			
BY: RAGGDM		C	

BALDOR

GL449/449TS F1 TEFC FT SIDE MNT 14X14X12 STEEL BOX W/ 4" NPT

SHEET NUMBER
1 OF 1

617435-427

- 1 OBSTRUCTION MUST NO ENCROACH ON AIR INLET.
2 (1) 3/8-16 & (1) 1/2-13 GROUNDING TAPS (BOTH SIDES).

IF MOUNTING CLEARANCE DETAILS ARE REQUIRED, CONSULT FACTORY.
MAX PERMISSIBLE SHAFT RUNOUT WHEN MEASURED AT END OF STANDARD SHAFT EXTENSION IS .003" T.I.R.

617435-427