

DUTY MASTER ALTERNATING CURRENT MOTORS

SQUIRREL-CAGE INDUCTION
CAST IRON CONSTRUCTION

ENCLOSURE: TOTALLY ENCLOSED
MOUNTING: FOOT

FRAMES 364TS-365TS

COOLING: FAN COOLED

617428-013

D

C

B

A

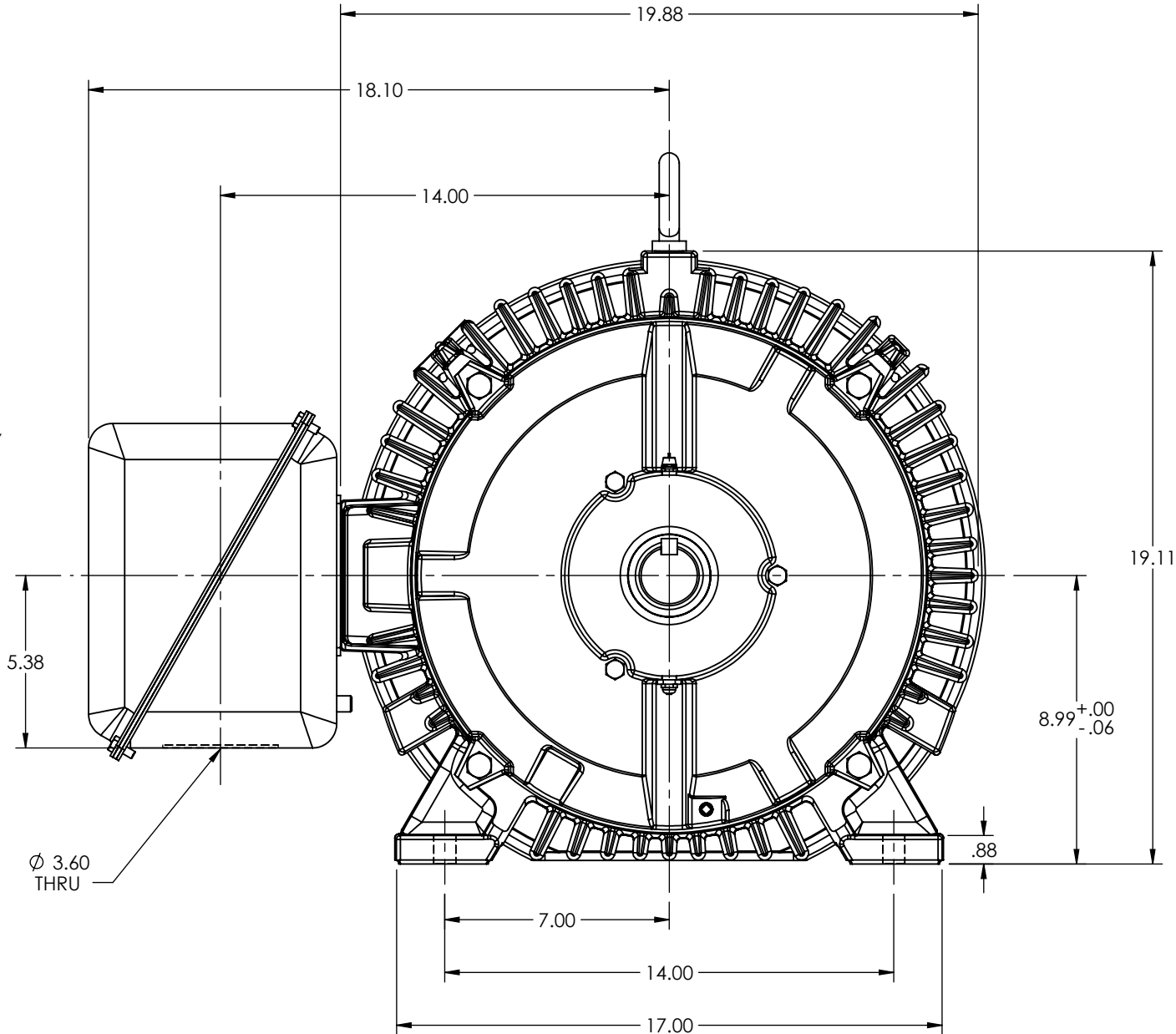
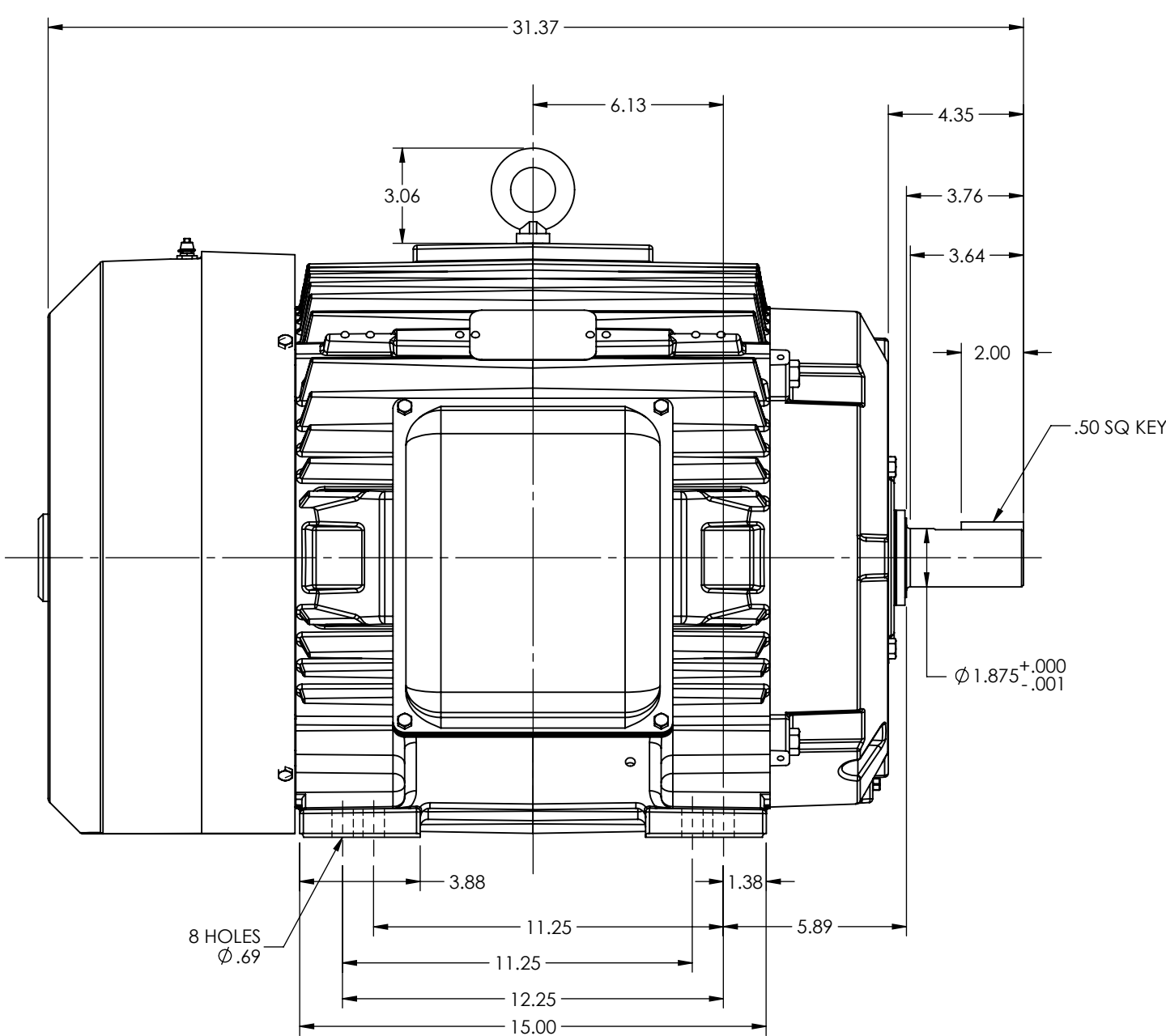

D

C

B

A

MAXIMUM PERMISSIBLE SHAFT RUNOUT WHEN MEASURED
AT END OF STD. SHAFT EXTENSION IS .002 T.I.R. UP TO
AND INCLUDING 1.625 DIA. AND .003 T.I.R. 1.625 DIA.
TO 5 INCH DIA.

WEIGHT (LBS): 364T = 794
365T = 834

MOTOR WEIGHTS MAY VARY BY 15% DEPENDING UPON RATING.

CUSTOMER IS RESPONSIBLE FOR DETERMINING THAT BALDOR'S PRODUCT WILL PERFORM SUITABLY IN THE INTENDED APPLICATION

| | | | |
|---|-------------|------------------------------|-------------------|
| REV. DESC: UPDATE MODEL TO ADD EXTERNAL HARDWARE PER PROD MGM | | | |
| REV: C | VERSION: 03 | REVISED: 01:50:19 10/03/2022 | TDR: 000001196512 |
| MODEL NO. 617428-013 | | | REF: |
| BY: ENFRAJ0 | | | B |

BALDOR

DIM SHT TEFC 364-365TS FT MTG W/GRSR AND RELIEF

617428-013