

OVERSIZED 14X14X12 STEEL BOX

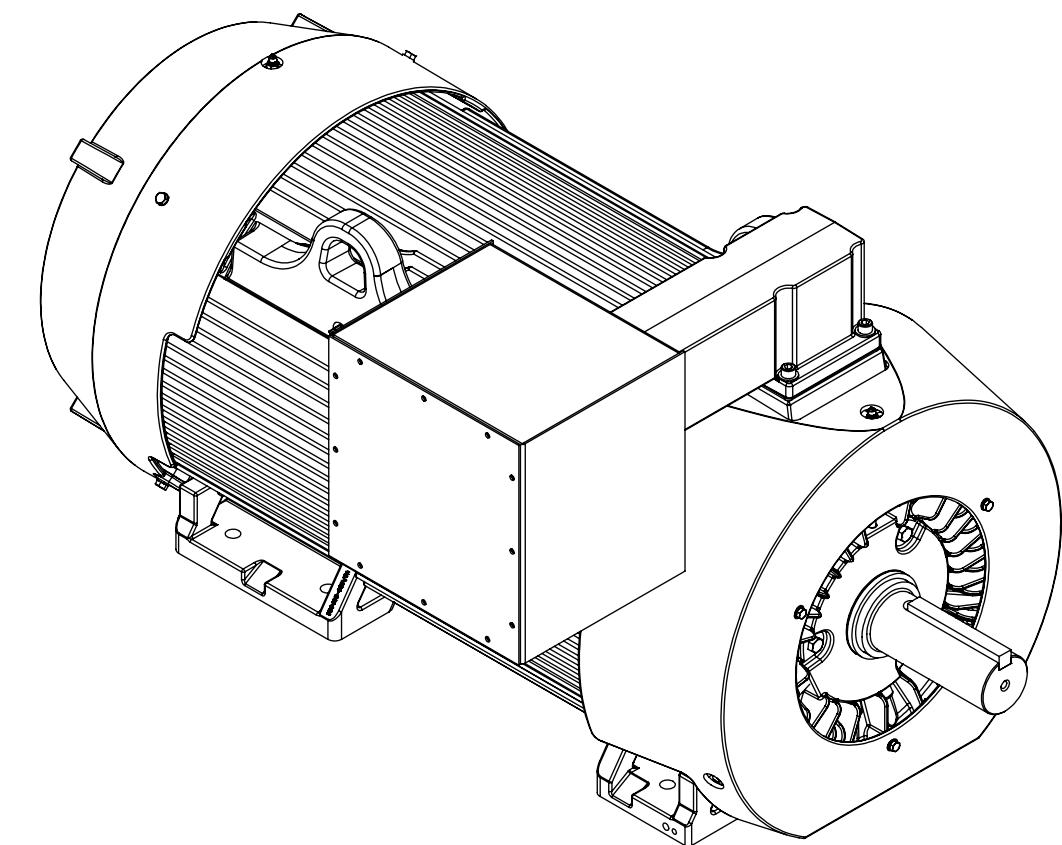
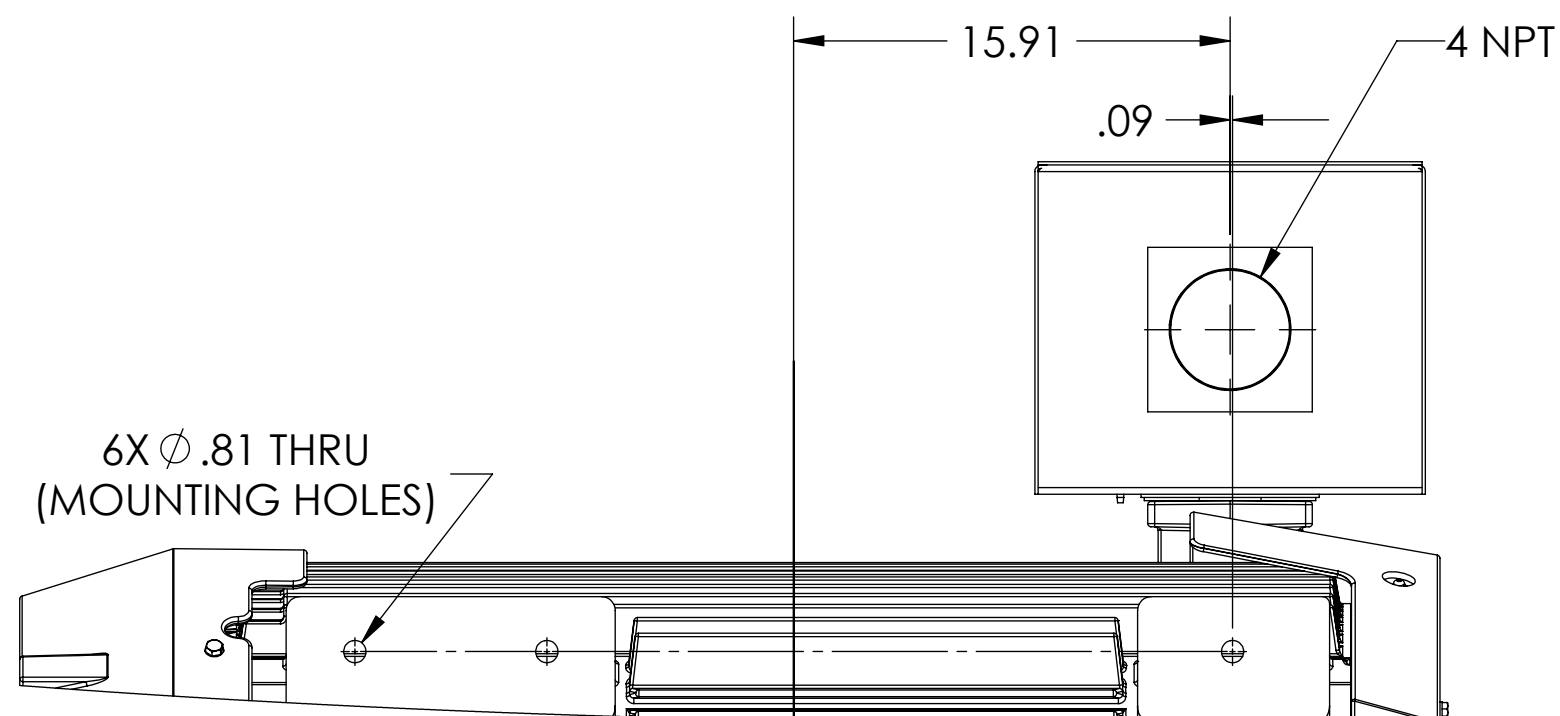
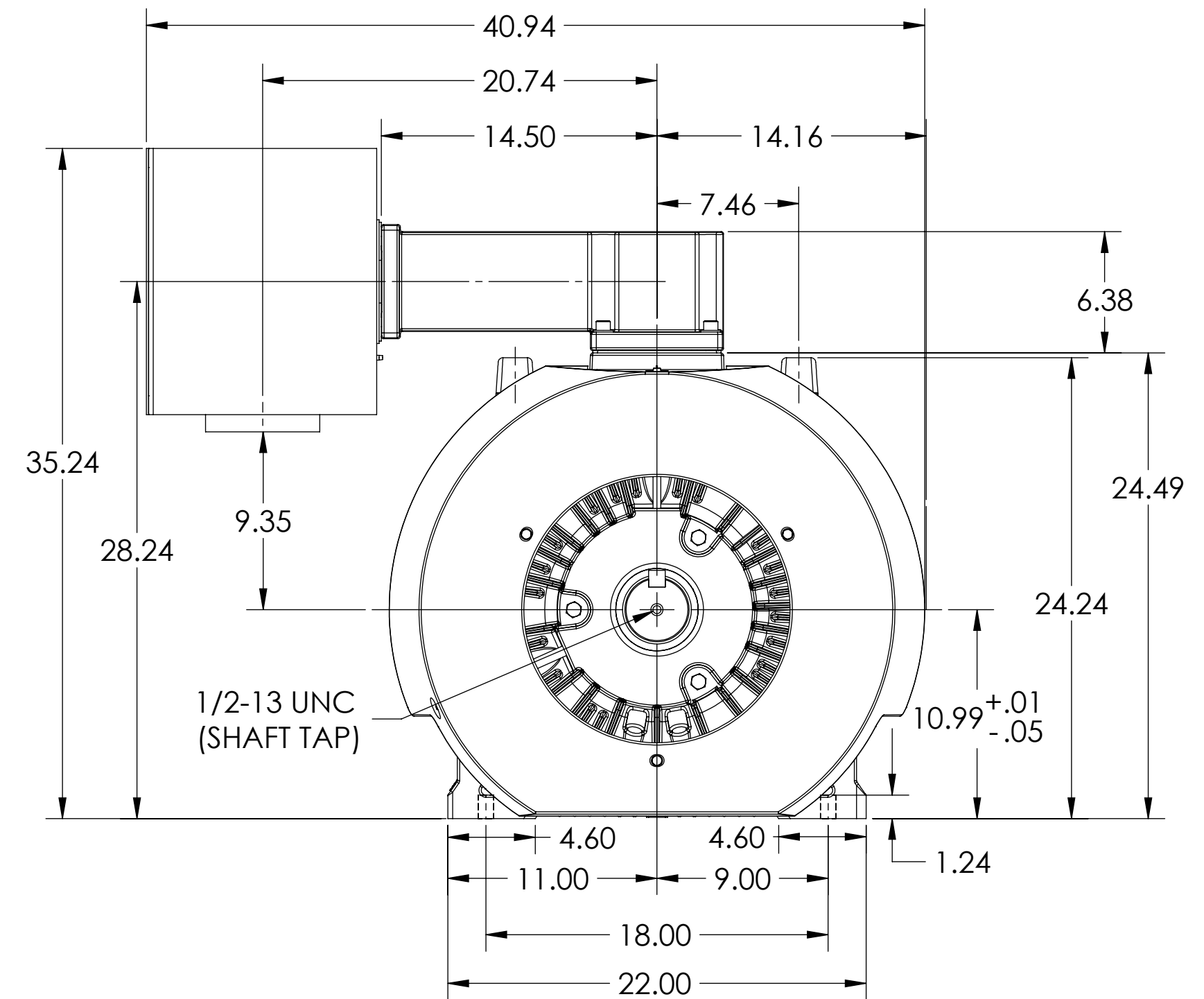
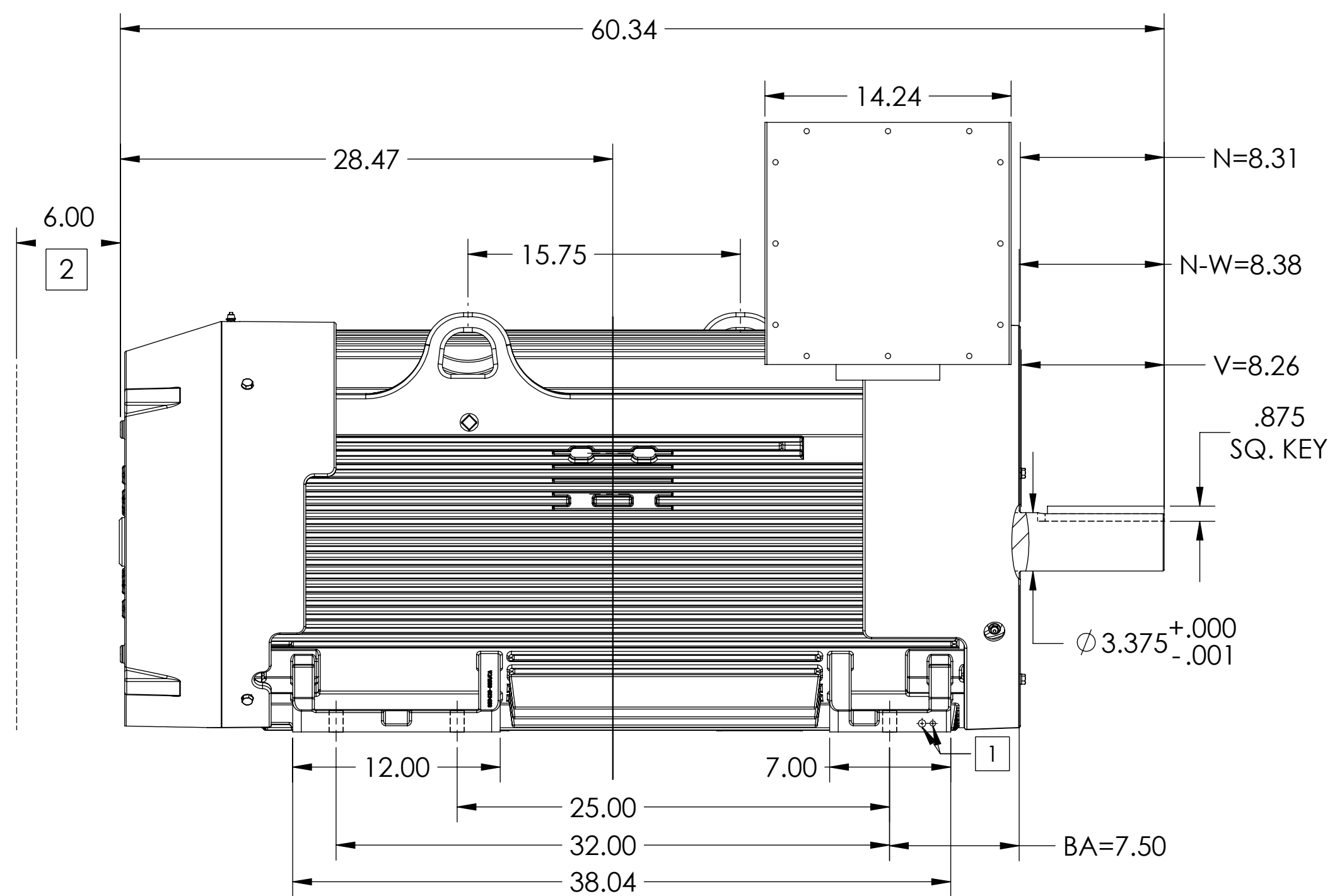

1. GROUND HOLES QTY 1 1/2-13 TAP; QTY 1 3/8-16 TAP
2. OBSTRUCTION MUST NO ENCROACH ON AIR INLET

CONDUIT BOX LOCATED ON OPPOSITE SIDE WHEN F-2.  
IF MOUNTING CLEARANCE DETAILS ARE REQUIRED, CONSULT FACTORY.  
MAXIMUM PERMISSIBLE SHAFT RUNOUT WHEN MEASURED AT END OF  
STANDARD SHAFT EXTENSION IS .003" T.I.R. TO 5 INCH DIA.

DIMENSIONS ARE IN INCHES; SEE SHEET 2 FOR DIMENSIONS IN MILLIMETERS.  
WEIGHT (LBS): 3875, MOTOR WEIGHTS MAY VARY BY 15% DEPENDING ON RATING.  
CUSTOMER IS RESPONSIBLE FOR DETERMINING THAT MOTOR PERFORMANCE IS SUITABLE IN THE APPLICATION.

REV. DESC: CHANGING TITLE BLOCK DS NUMBER TO 617423-352			
REV: A	VERSION: 01	REVISED: 11:15:45 04/04/2023	TDR: 000001206942
MODEL NO. 617423-352			REF: -
BY: USERWAL2		Material: -	C

# BALDOR

GL449/449T F1 FT TEFC -TOP MNT C/BOX 14X14X12- V-RING SLGRS

DUTY MASTER ALTERNATING CURRENT MOTORS  
SQUIRREL-CAGE INDUCTION

617423-352

ENCLOSURE: TOTALLY ENCLOSED  
MOUNTING: FOOT, F-1

GL449T/G449T FRAME MOUNTING HOLES

COOLING: FAN COOLED

OVERSIZED 14X14X12 STEEL BOX

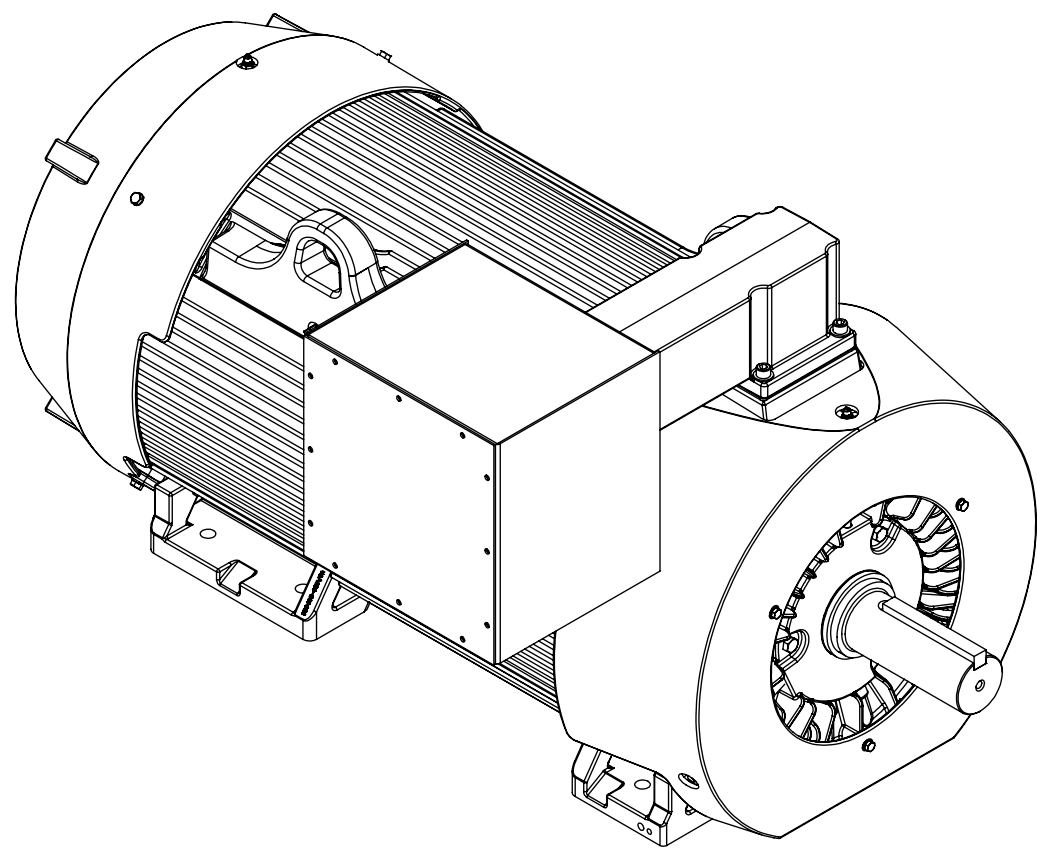
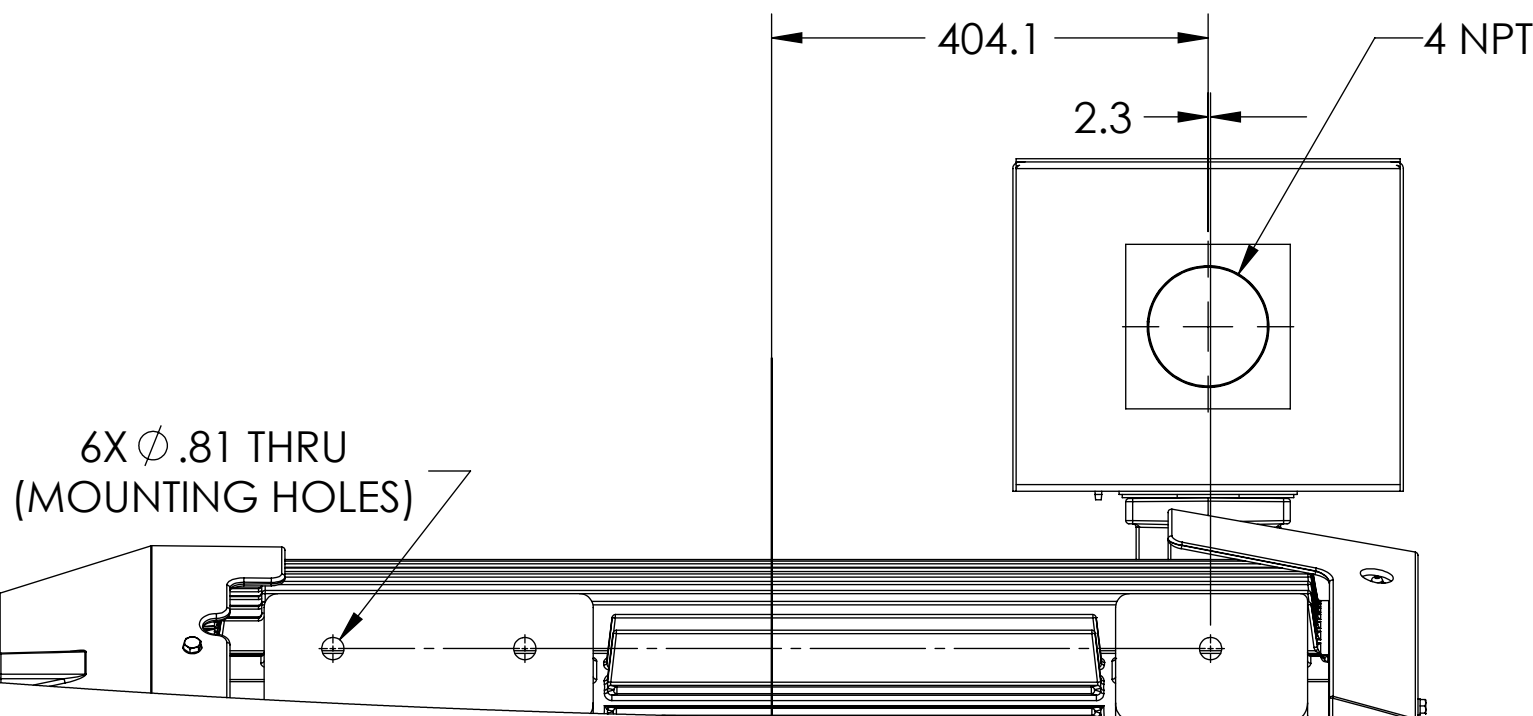
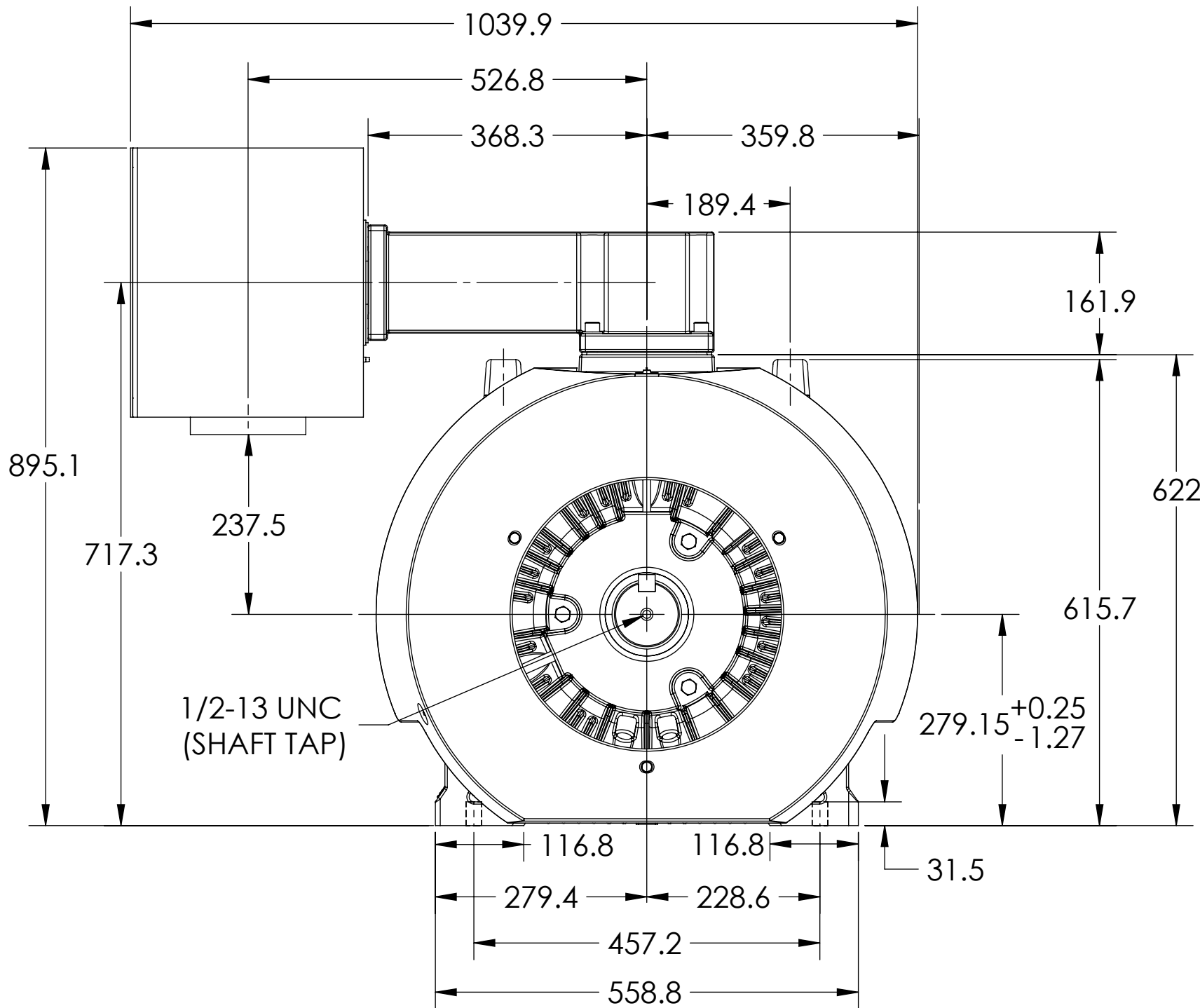
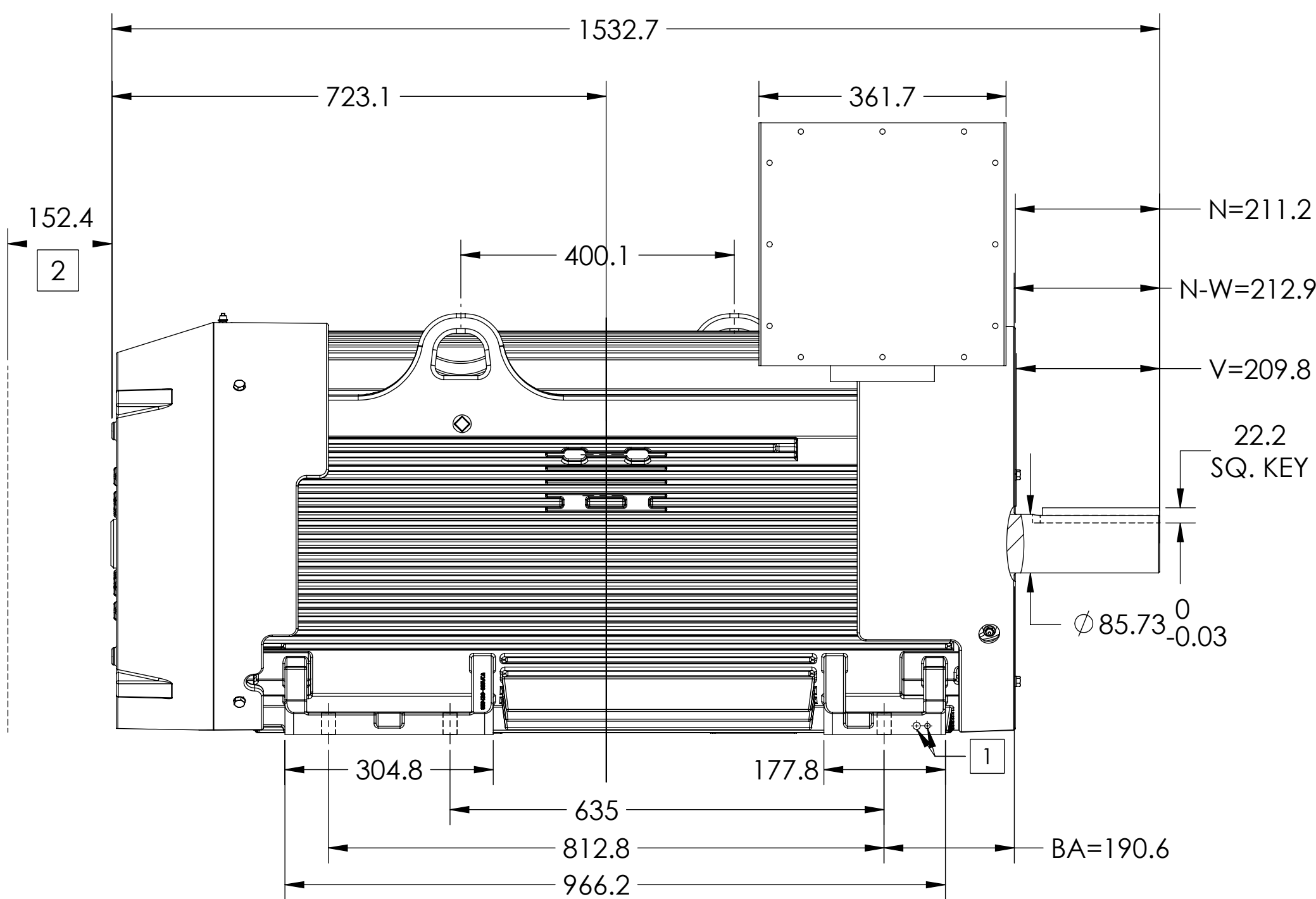

- GROUND HOLES QTY 1 1/2-13 TAP; QTY 1 3/8-16 TAP
- OBSTRUCTION MUST NO ENCROACH ON AIR INLET

CONDUIT BOX LOCATED ON OPPOSITE SIDE WHEN F-2.  
IF MOUNTING CLEARANCE DETAILS ARE REQUIRED, CONSULT FACTORY.  
MAXIMUM PERMISSIBLE SHAFT RUNOUT WHEN MEASURED AT END OF  
STANDARD SHAFT EXTENSION IS .08 MM T.I.R. TO 127 MM DIA.

DIMENSIONS ARE IN MILLIMETERS; SEE SHEET 1 FOR DIMENSIONS IN INCHES  
WEIGHT (KGS): 1760, MOTOR WEIGHTS MAY VARY BY 15% DEPENDING ON RATING.  
CUSTOMER IS RESPONSIBLE FOR DETERMINING THAT MOTOR PERFORMANCE IS SUITABLE IN THE APPLICATION.

REV. DESC: CHANGING TITLE BLOCK DS NUMBER TO 617423-352			
REV: A	VERSION: 01	REVISED: 11:15:45 04/04/2023	TDR: 000001206942
MODEL NO. 617423-352		REF: -	
BY: USERWAL2		Material: -	

**BALDOR**

GL449/449T F1 FT TEFC -TOP MNT C/BOX 14X14X12- V-RING SLGRS

617423-352

617423-352