

DUTY MASTER ALTERNATING CURRENT MOTORS

SQUIRREL-CAGE INDUCTION

FRAME G445T

INCLUDES 444T FRAME MOUNTING HOLES
CAST IRON C/BOX

COOLING: FAN COOLED

ENCLOSURE ENHANCEMENT: SEVERE DUTY

ENCLOSURE: TOTALLY ENCLOSED

MOUNTING: FOOT, F1

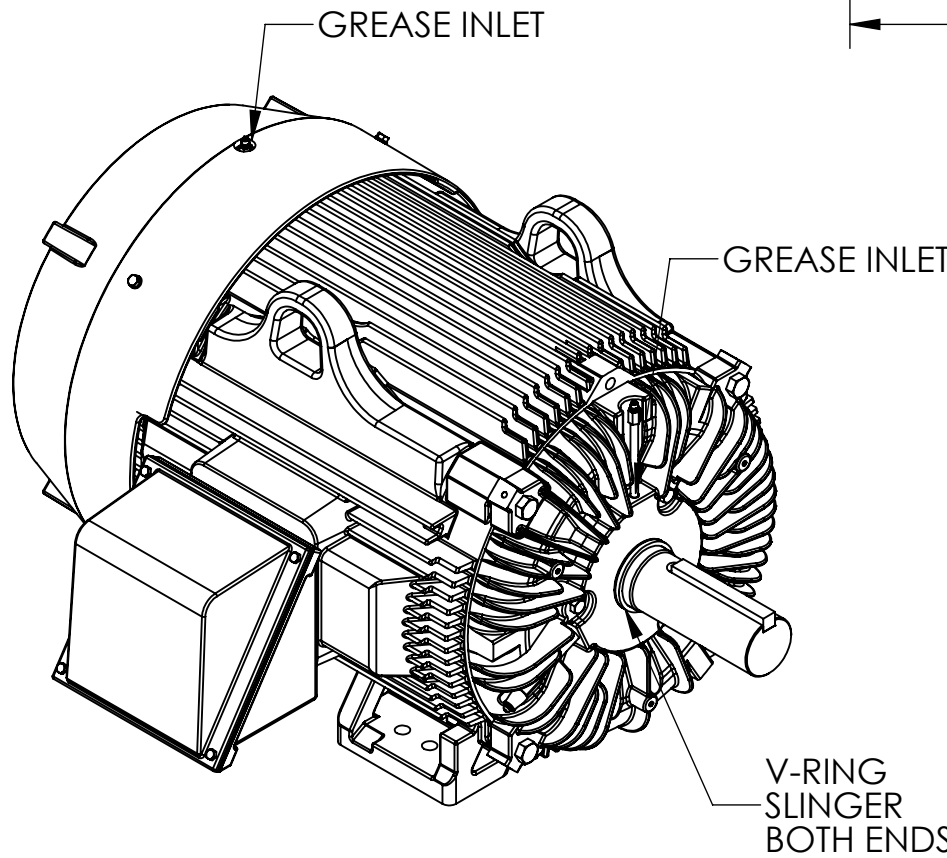
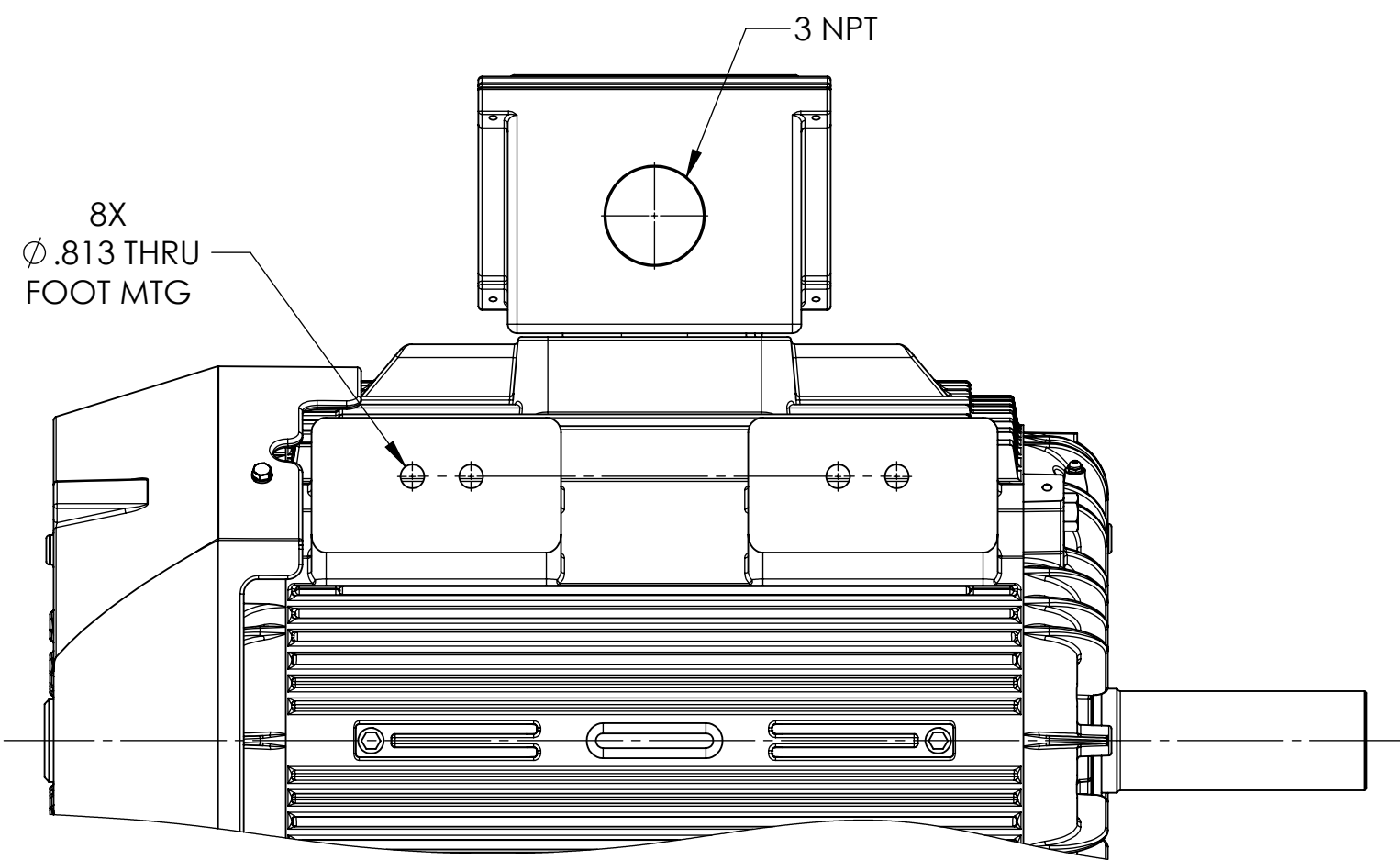
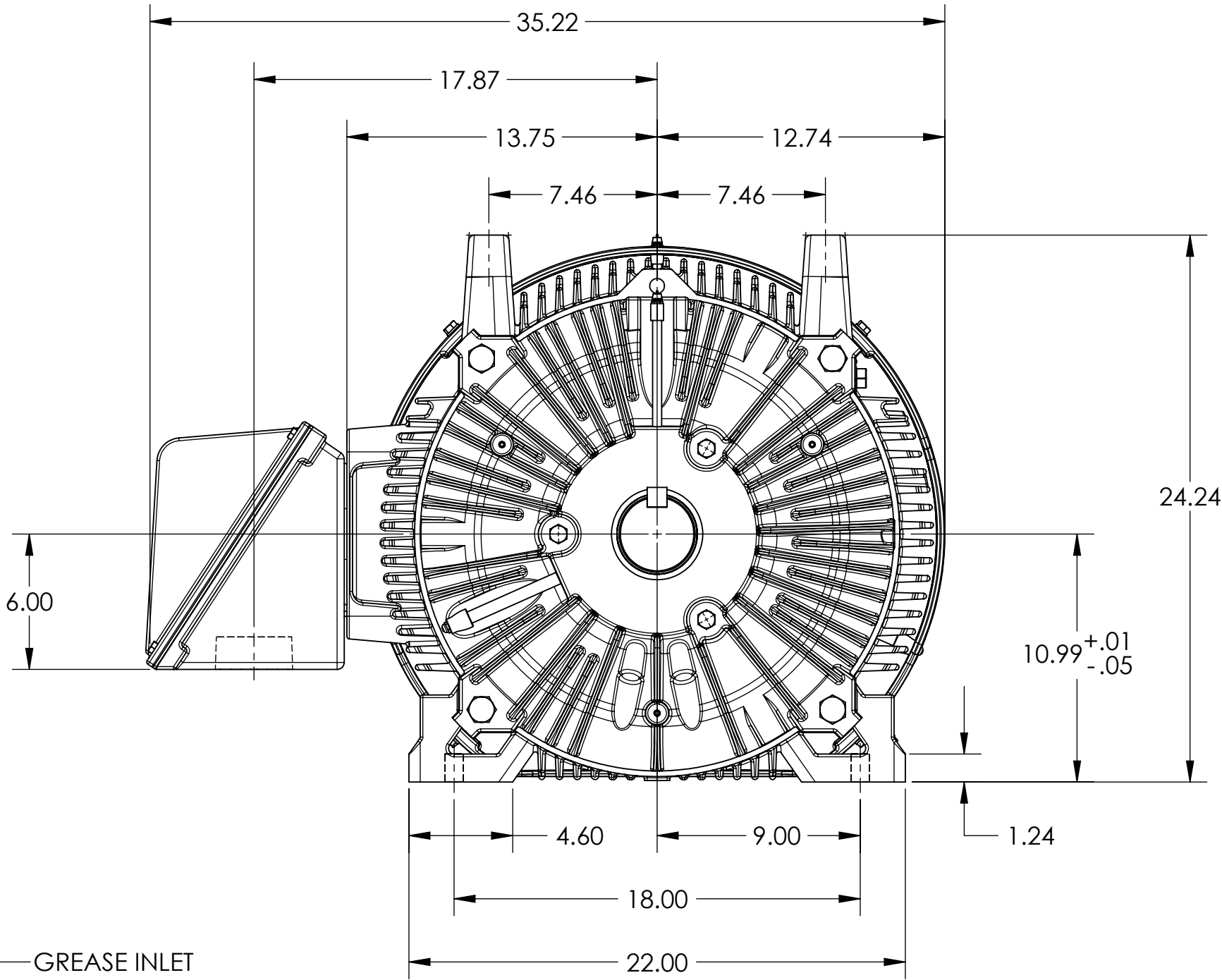
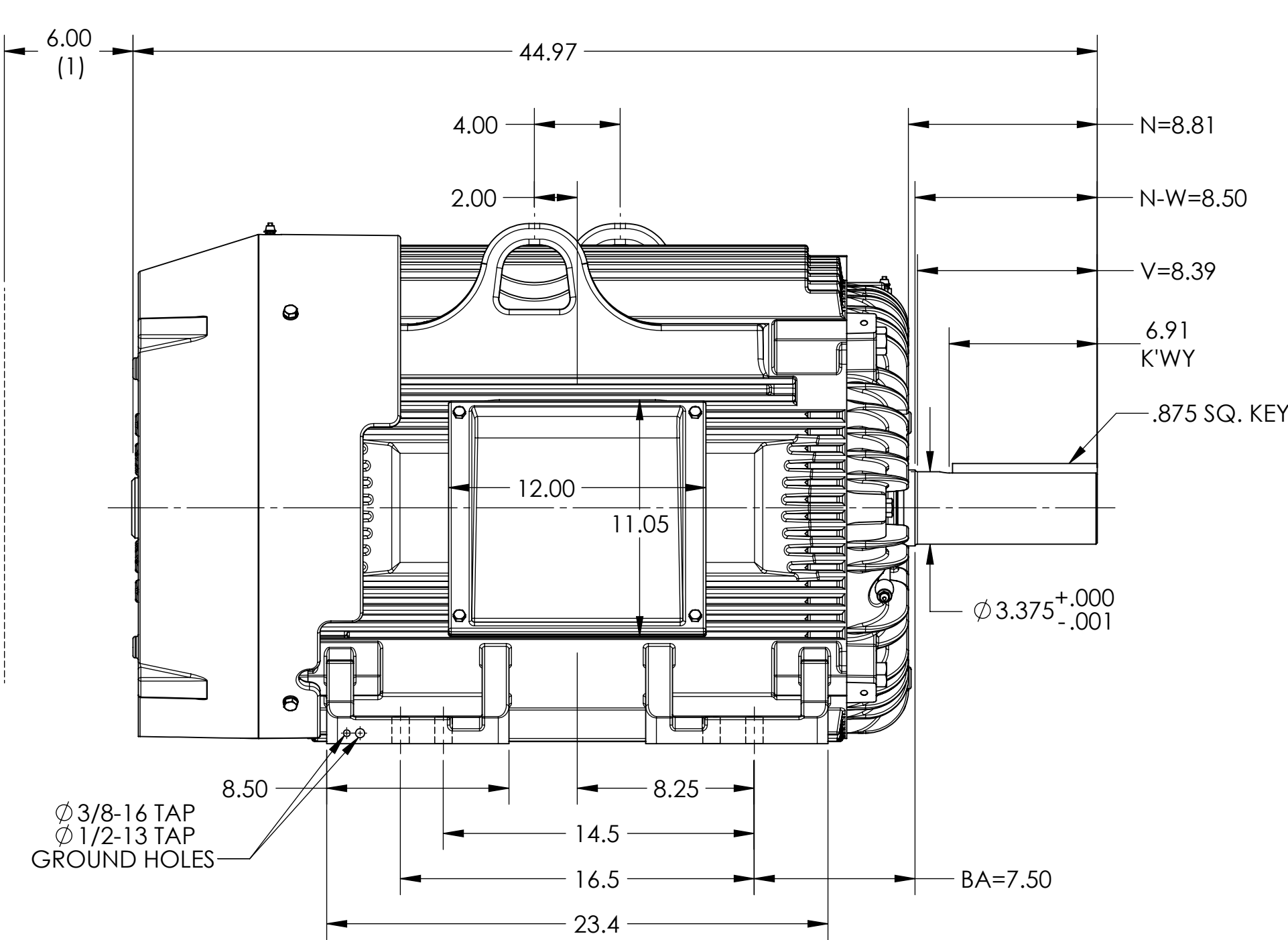

1. OBSTRUCTION MUST NOT ENCROACH ON AIR INLET.
2. WEIGHT = 2150 ± 15% DEPENDING ON RATING.

DIMENSIONS ARE IN INCHES.

CUSTOMER IS RESPONSIBLE FOR DETERMINING THAT MOTOR PERFORMANCE IS SUITABLE IN THE APPLICATION.

IF MOUNTING CLEARANCE DETAILS ARE REQUIRED, CONSULT FACTORY.

MAXIMUM PERMISSIBLE SHAFT RUNOUT WHEN MEASURED AT END OF
STANDARD SHAFT EXTENSION IS .003 T.I.R.

SHEET NUMBER
1 OF 1

617435-945

REV. DESC: UPDATE MODEL TO ADD EXTERNAL HARDWARE PER PROD MGM			
REV: B	VERSION: 02	REVISED: 04:55:30 10/03/2022	TDR: 000001196512
MODEL NO. 617435-945		REF:	
BY: ENFRAJ0		Material:	C

BALDOR

G445T STD TEFC F1 FOOTED - CAST IRON C/BOX

617435-945