

DUTY MASTER ALTERNATING CURRENT MOTORS
SQUIRREL-CAGE INDUCTION

617429-240

ENCLOSURE: TOTALLY ENCLOSED

MOUNTING: FOOT, F1

FRAME G405T
INCLUDES G404T FRAME MOUNTING HOLES

COOLING: FAN COOLED

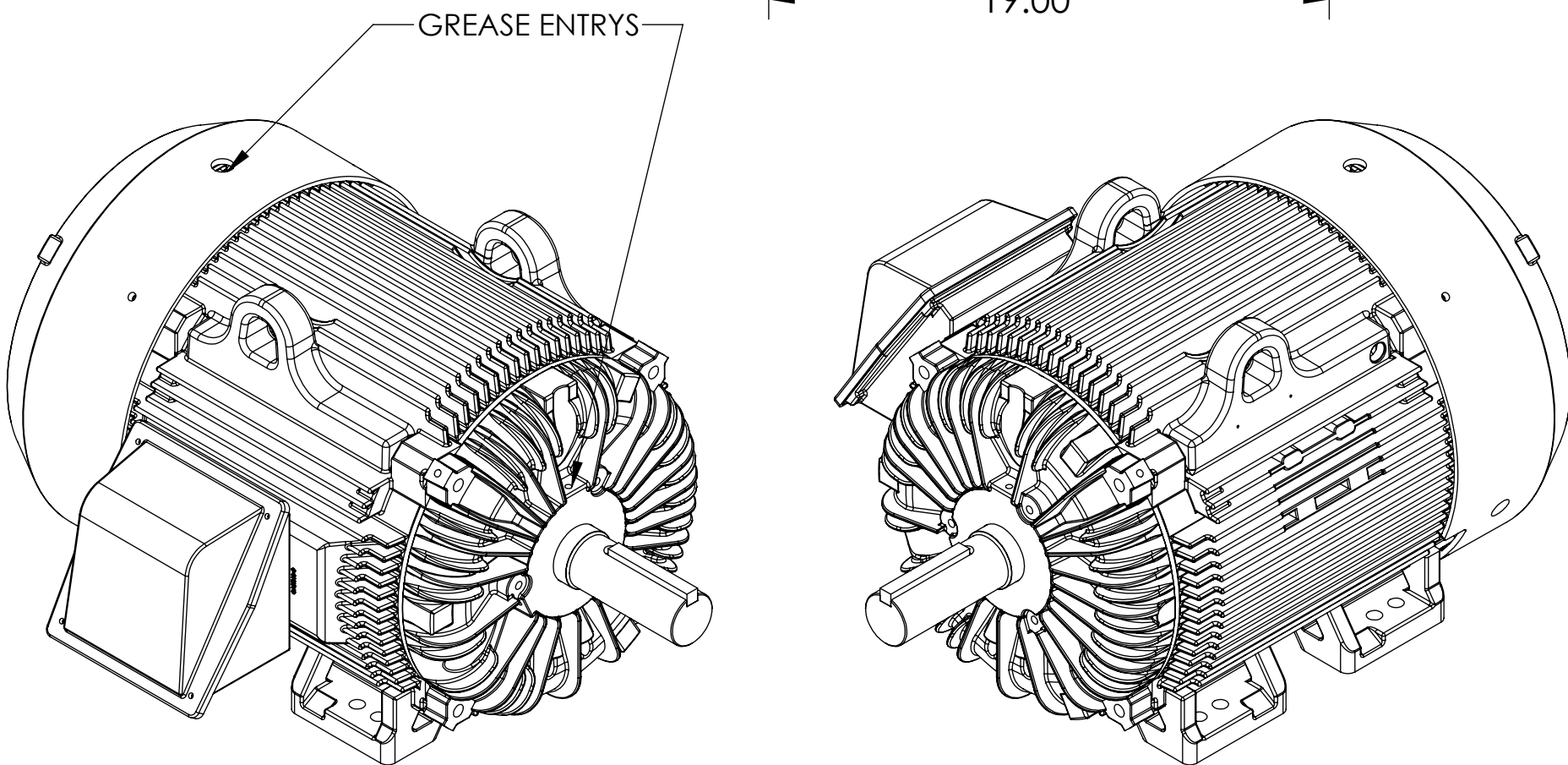
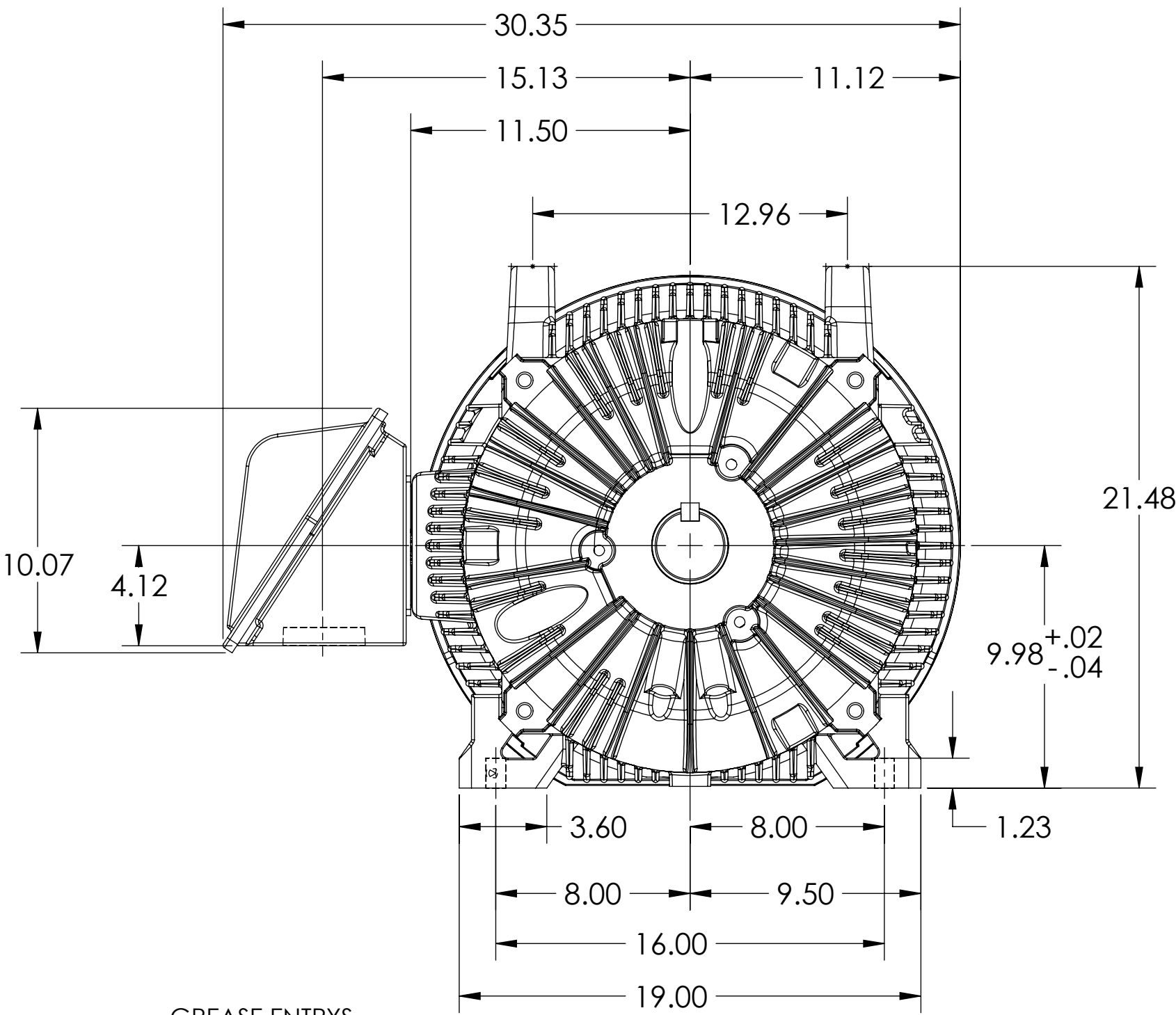
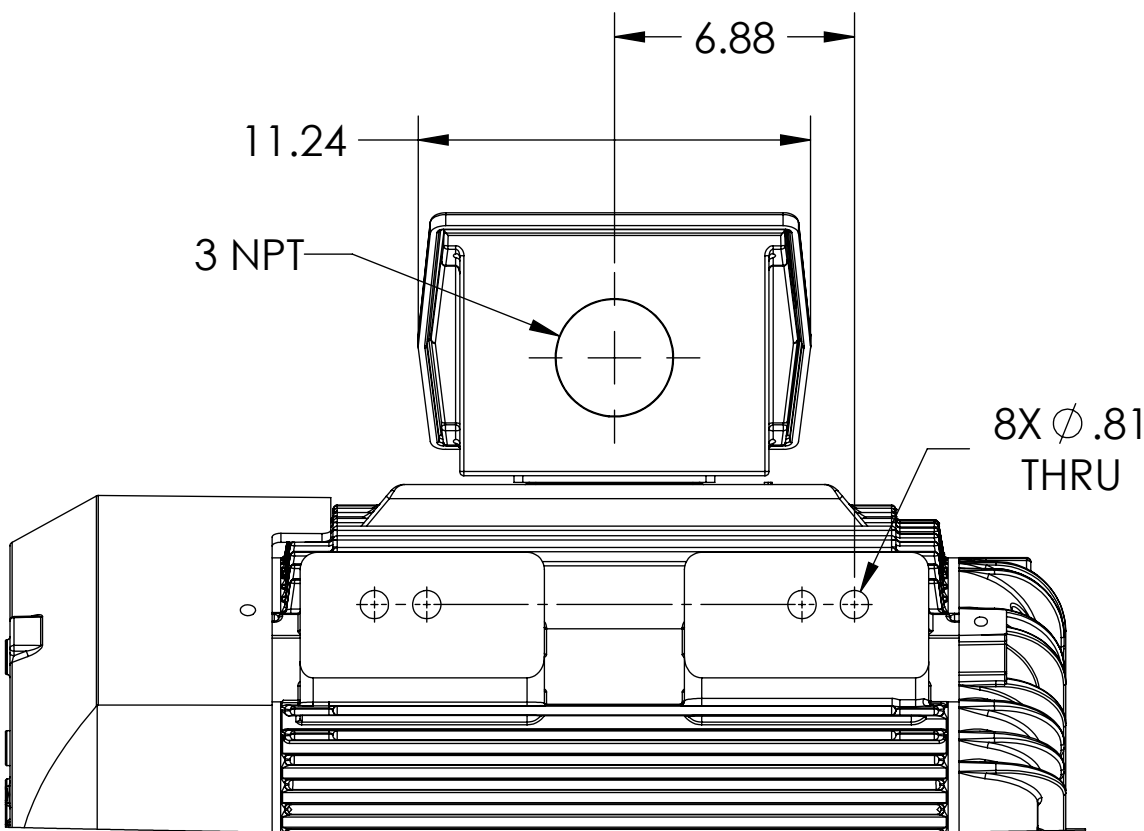
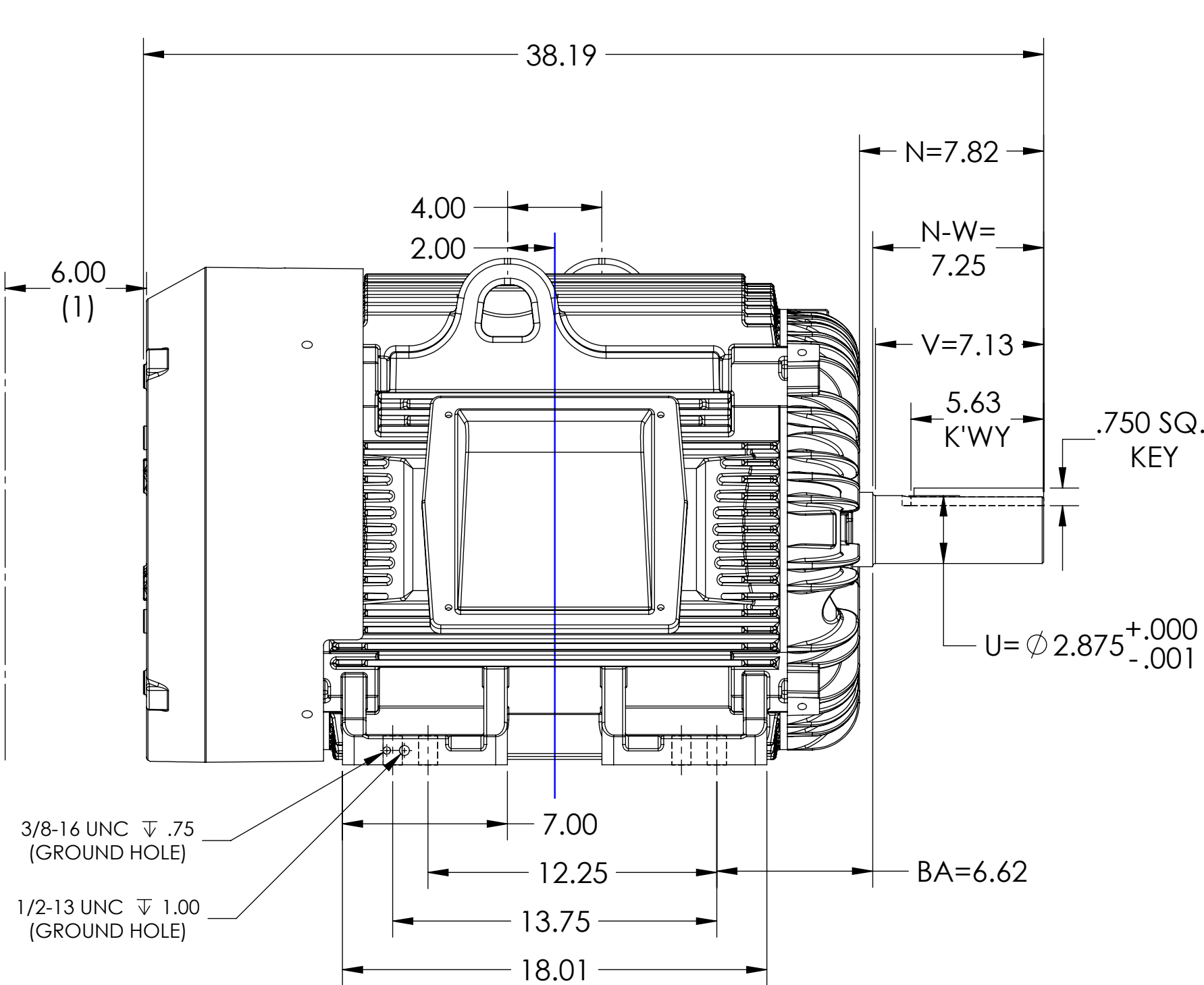

(1) OBSTRUCTION MUST NOT ENCROACH ON AIR INLET.

IF MOUNTING CLEARANCE DETAILS ARE REQUIRED, CONSULT FACTORY.

MAX PERMISSIBLE SHAFT RUNOUT WHEN MEASURED AT END OF STANDARD SHAFT EXTENSION IS .003" T.I.R.

DIMENSIONS ARE IN INCHES
MOTOR WEIGHT: 1350 LBS - MAY VARY BY 15% DEPENDING ON RATING.
CUSTOMER IS RESPONSIBLE FOR DETERMINING THAT MOTOR PERFORMANCE IS SUITABLE IN THE APPLICATION.

REV: -	VERSION: 00	REVISED: 09:58:52 02/10/2016	TDR: 000000964494
MODEL NO. 617429-240	BY: RAGRA	Material:	REF:

BALDOR

G405/4T TEFC F1 - FT - STD C.I. C/BOX

SHEET NUMBER
1 OF 1

617429-240

617429-240