

COOLING: FAN COOLED

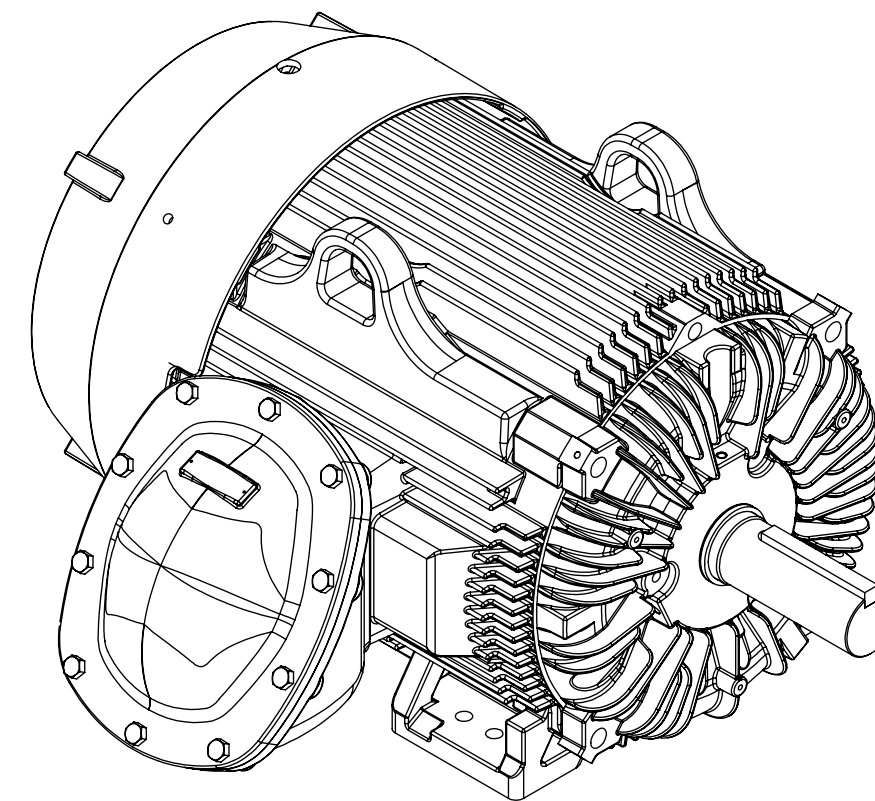
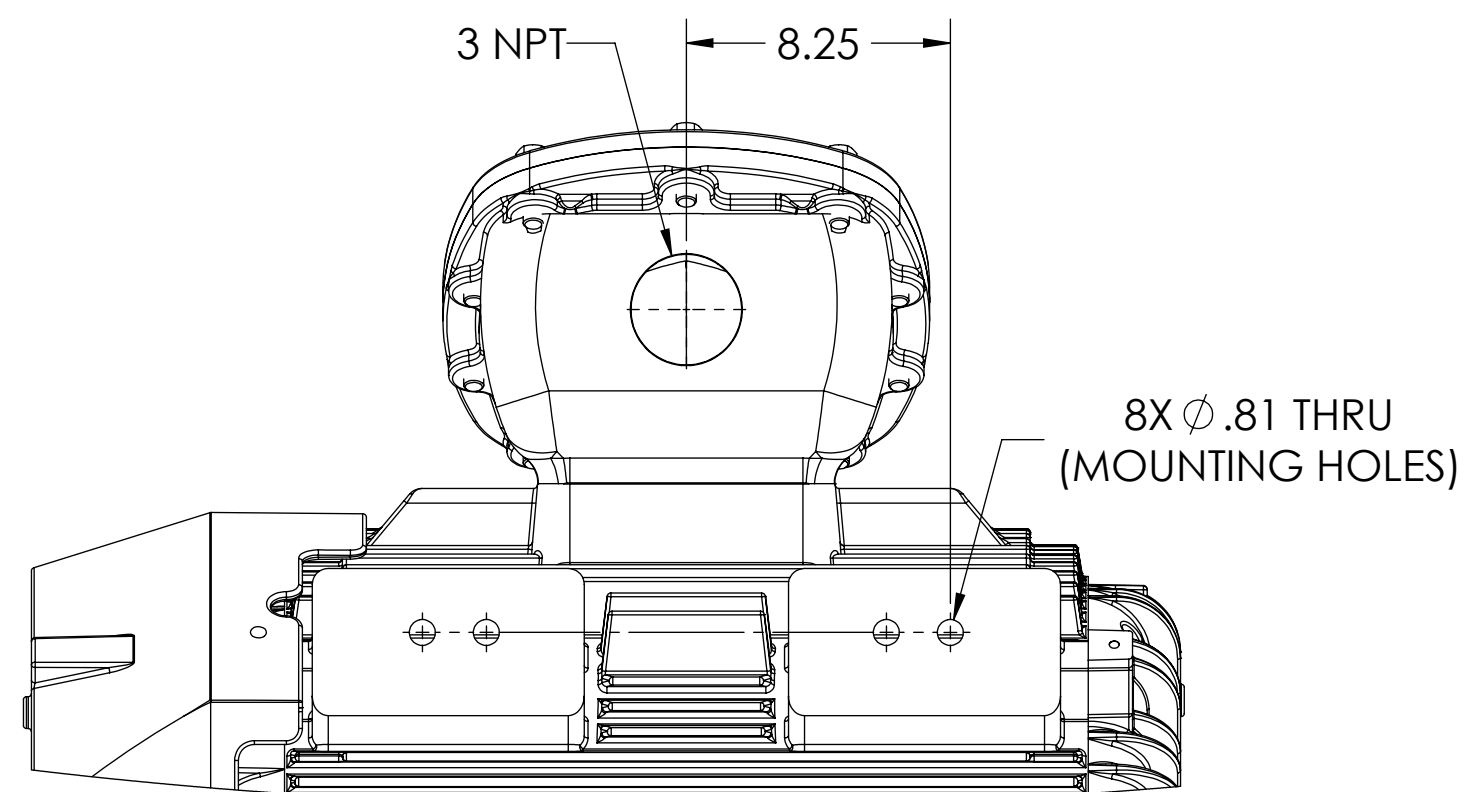
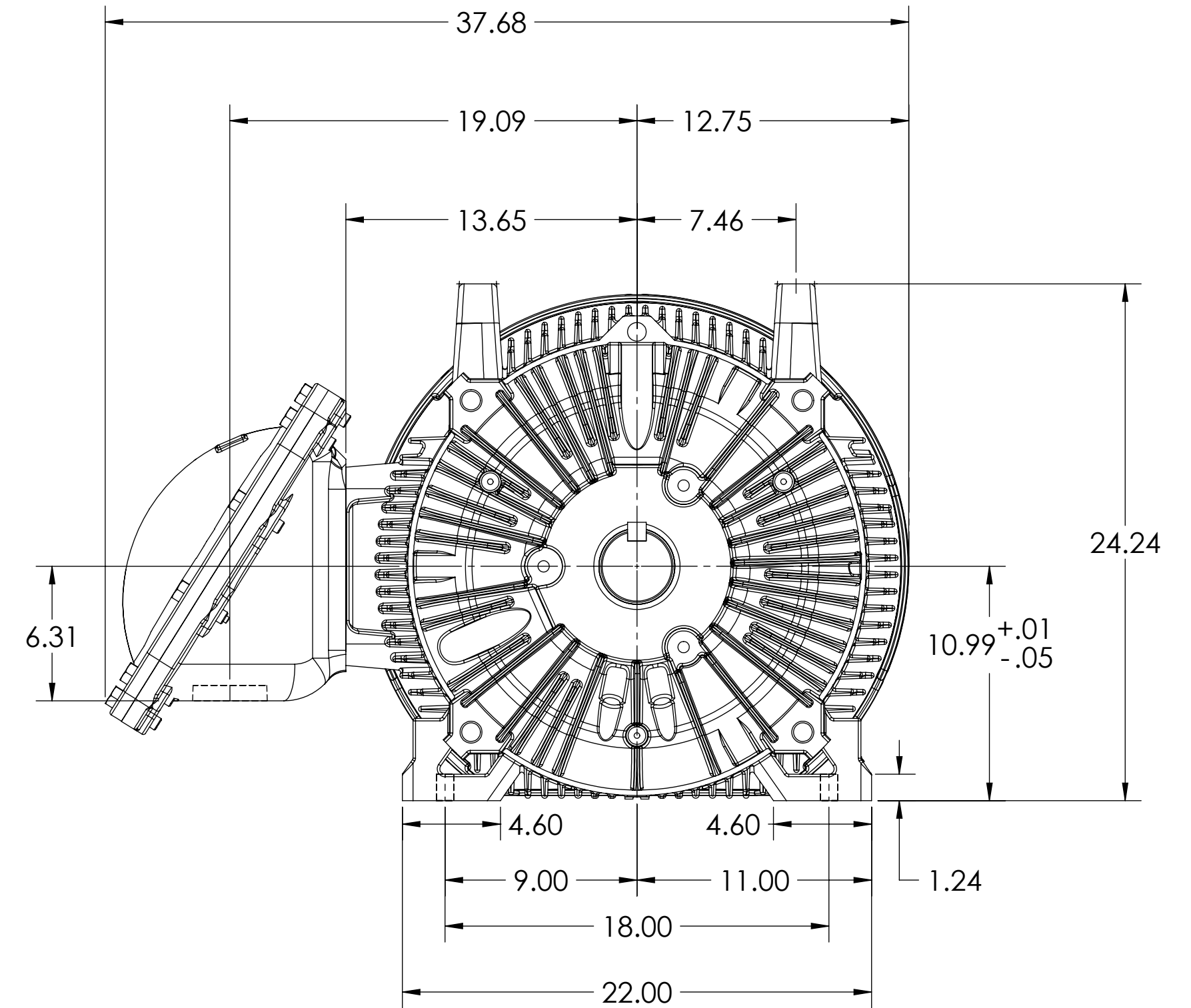

REV. DESC: UPDATE DS QUALITY			
REV: D	VERSION: 04	REVISED: 10:29:12 07/14/2017	TDR: 000001034367
MODEL NO. 617426-001			REF:
BY: USJEDIL		Material:	

G445T/444T FCXP F1 FOOT/CAST IRON CONDUIT BOX/DIV.1

617426-001

IF MOUNTING CLEARANCE DETAILS ARE REQUIRED, CONSULT FACTORY.
MAX PERMISSIBLE SHAFT RUNOUT WHEN MEASURED AT END OF STANDARD SHAFT EXTENSION IS .003" T.I.R.

617426-00

DUTY MASTER ALTERNATING CURRENT MOTORS
SQUIRREL-CAGE INDUCTION

617426-001

ENCLOSURE: UL LISTED MOTOR

MOUNTING: FOOT, F-1

G445T/G444T FRAME MOUNTING HOLES

COOLING: FAN COOLED

F
E
D
C
B
A

F
E
D
C
B
A

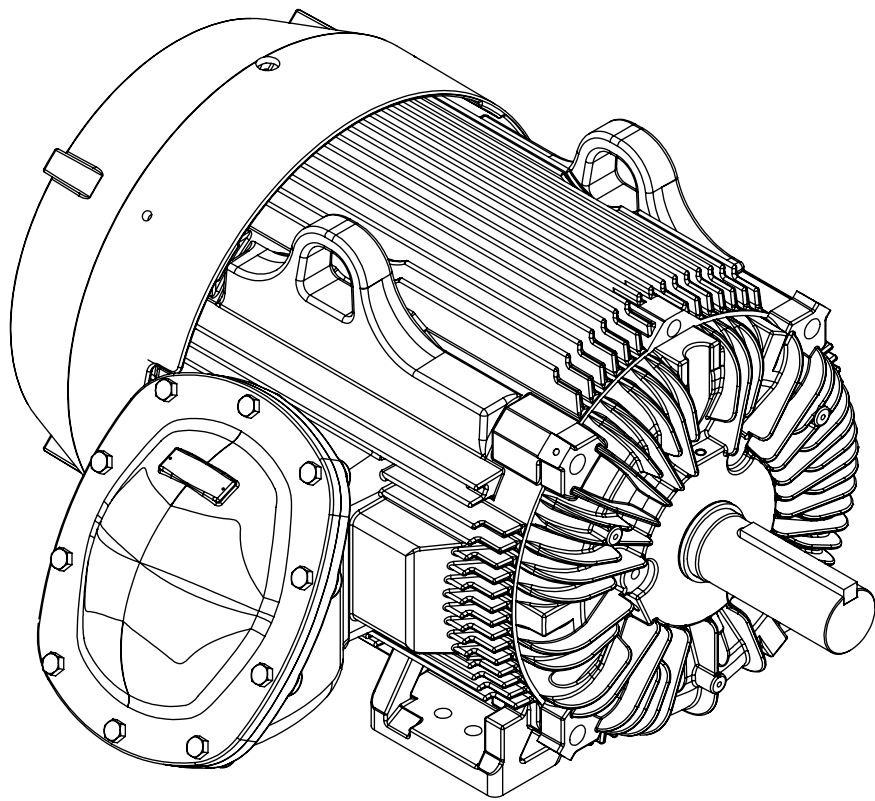
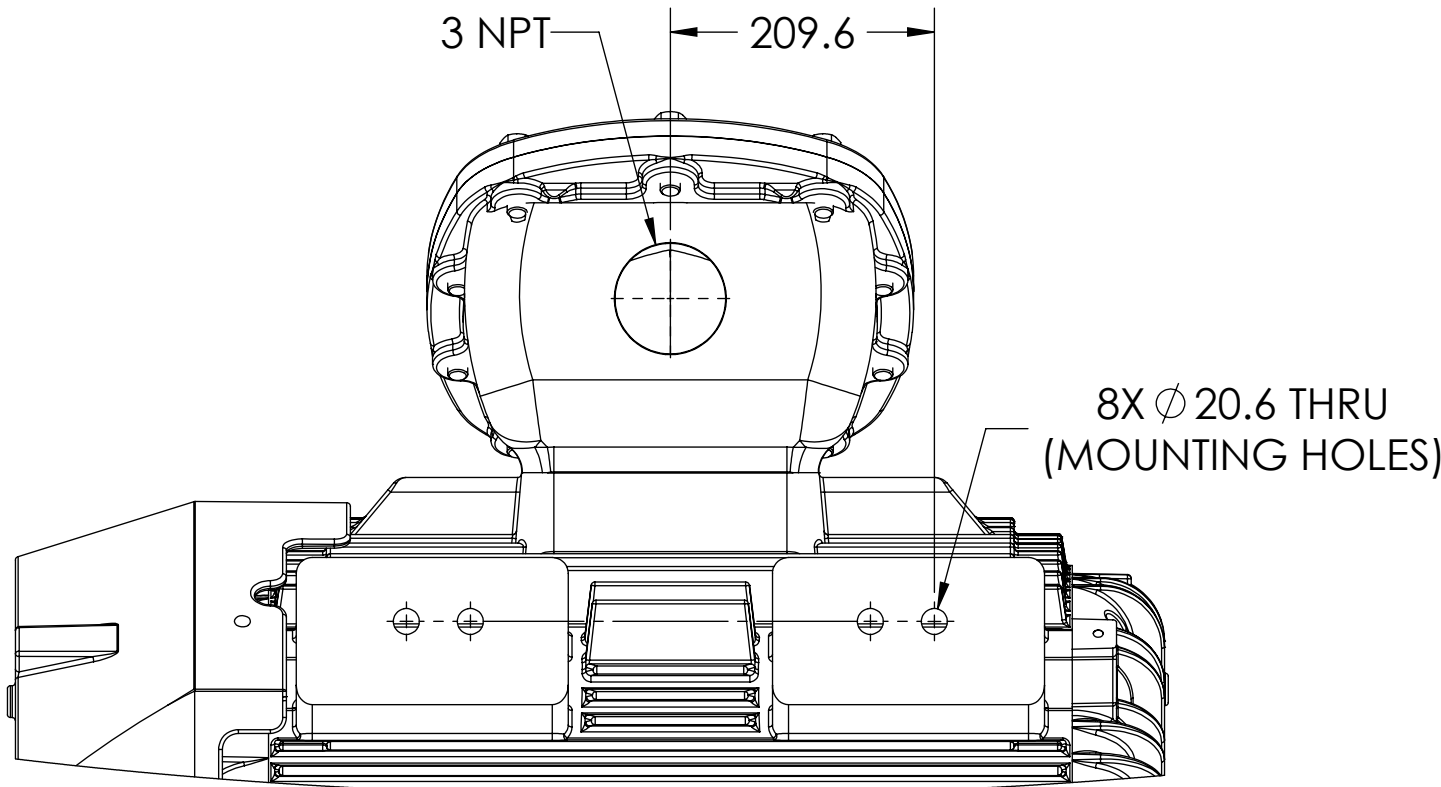
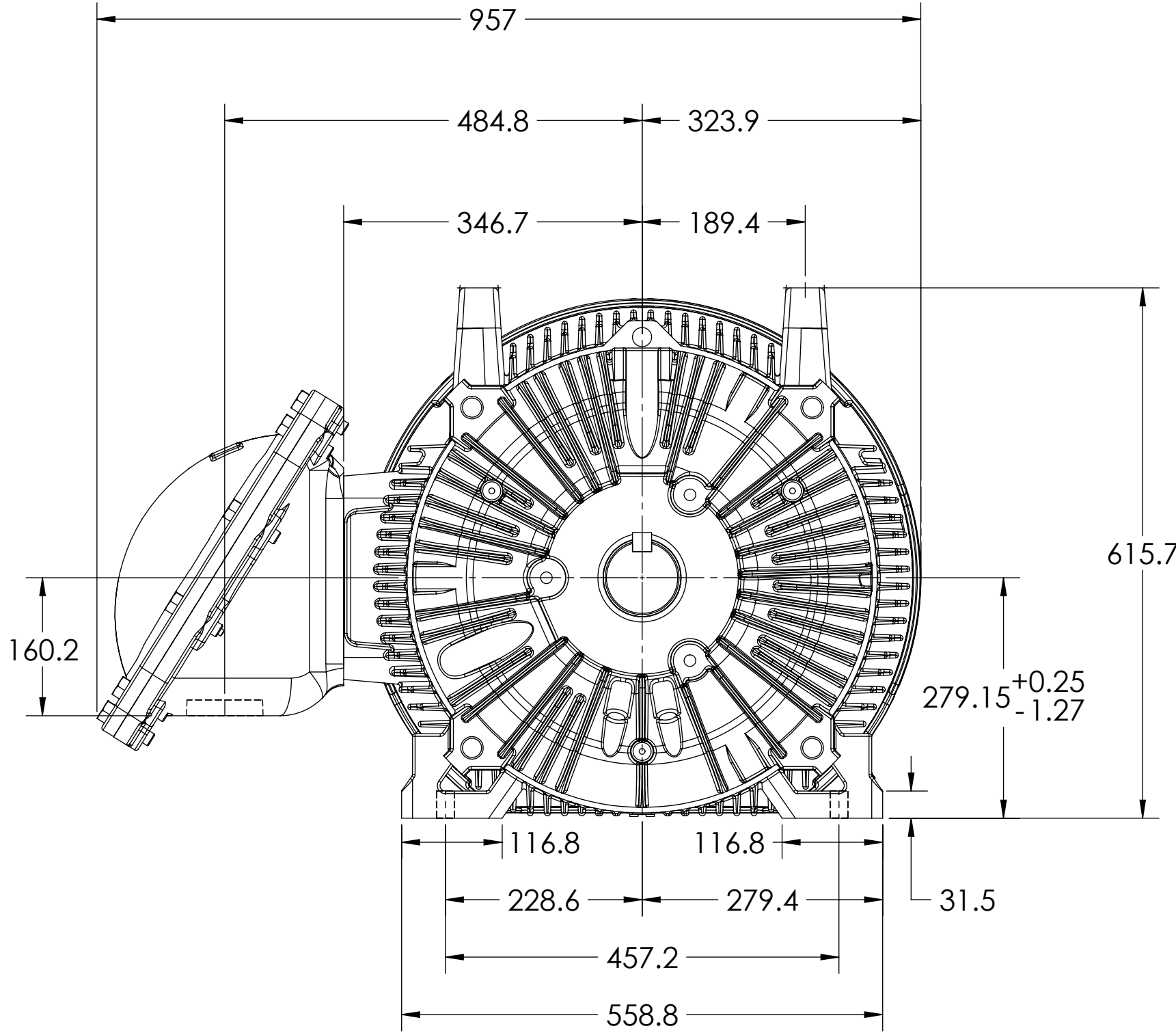
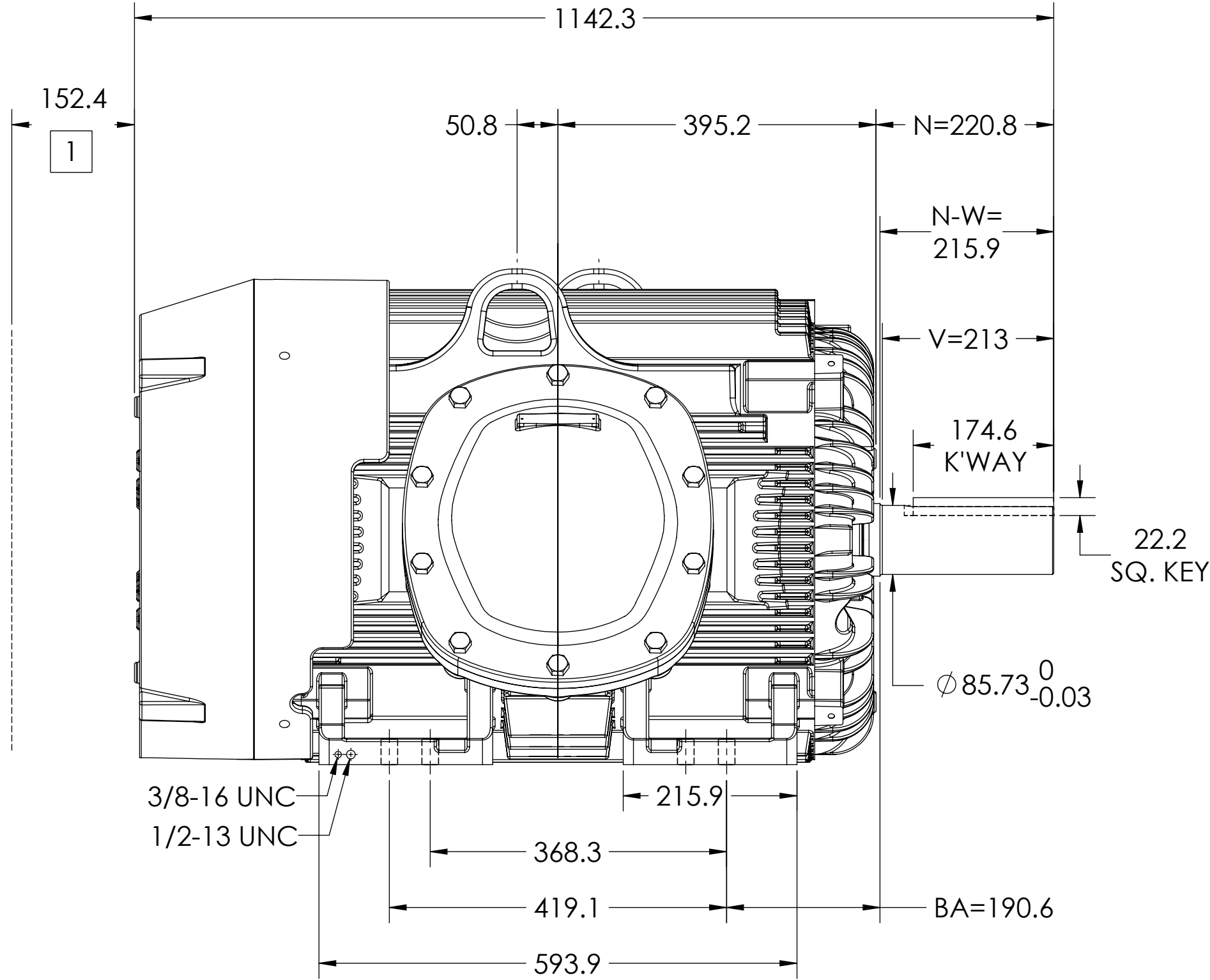

DIMENSIONS ARE IN MILLIMETERS.
WEIGHT (KGS): 975, MOTOR WEIGHTS MAY VARY BY 15% DEPENDING ON RATING.
CUSTOMER IS RESPONSIBLE FOR DETERMINING THAT MOTOR PERFORMANCE IS SUITABLE IN THE APPLICATION.

SHEET NUMBER
2 OF 2

100-6-001

1 OBSTRUCTION MUST NOT ENCROACH ON AIR INLET.

IF MOUNTING CLEARANCE DETAILS ARE REQUIRED, CONSULT FACTORY.
MAX PERMISSIBLE SHAFT RUNOUT WHEN MEASURED AT END OF STANDARD SHAFT EXTENSION IS .08 T.I.R.

REV. DESC: UPDATE DS QUALITY			
REV: D	VERSION: 04	REVISED: 10-29-12 07/14/2017	TDR: 000001034367
MODEL NO. 617426-001		REF:	
BY: USJEDIL		Material:	

C

BALDOR

G445T/444T FCXP F1 FOOT/CAST IRON CONDUIT BOX/DIV.1

617426-001