

ENCLOSURE: X/P, UNDERWRITERS LISTED

DUTY MASTER ALTERNATING CURRENT MOTORS

SQUIRREL-CAGE INDUCTION

617433-608

MOUNTING: FOOT, F-1 MOUNT

G405T/G404T FRAME MOUNTING HOLES

COOLING: FAN COOLED

CL. 1, GRP. C & D

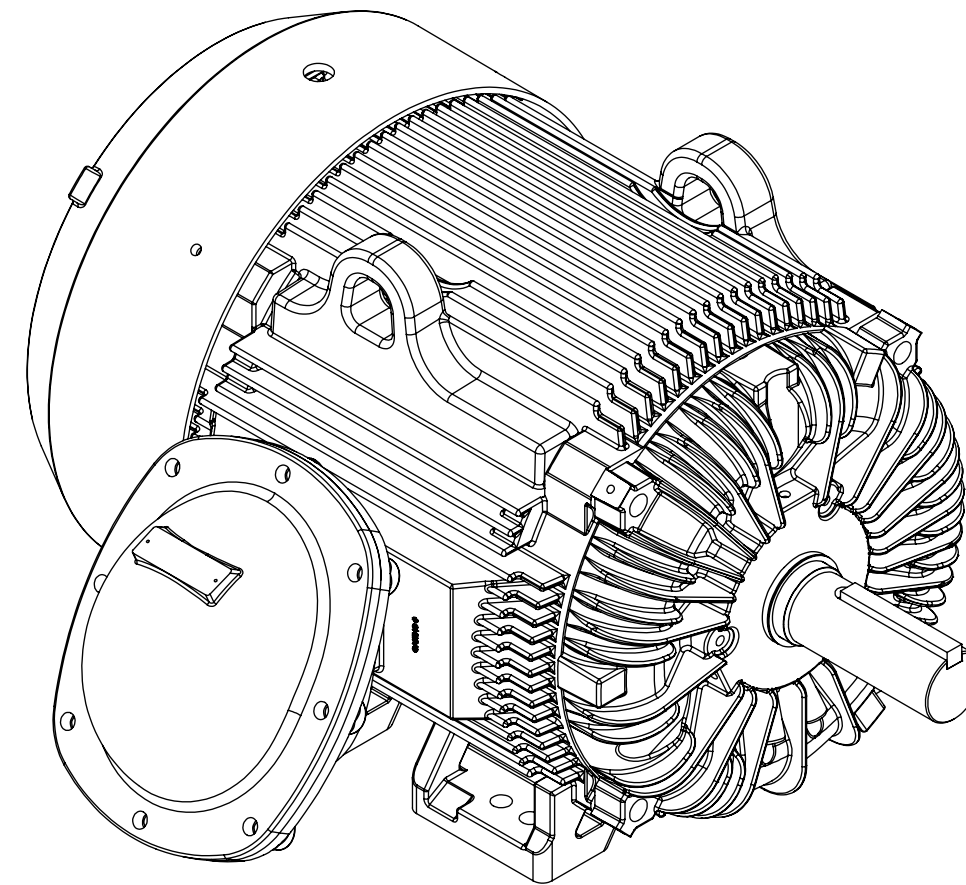
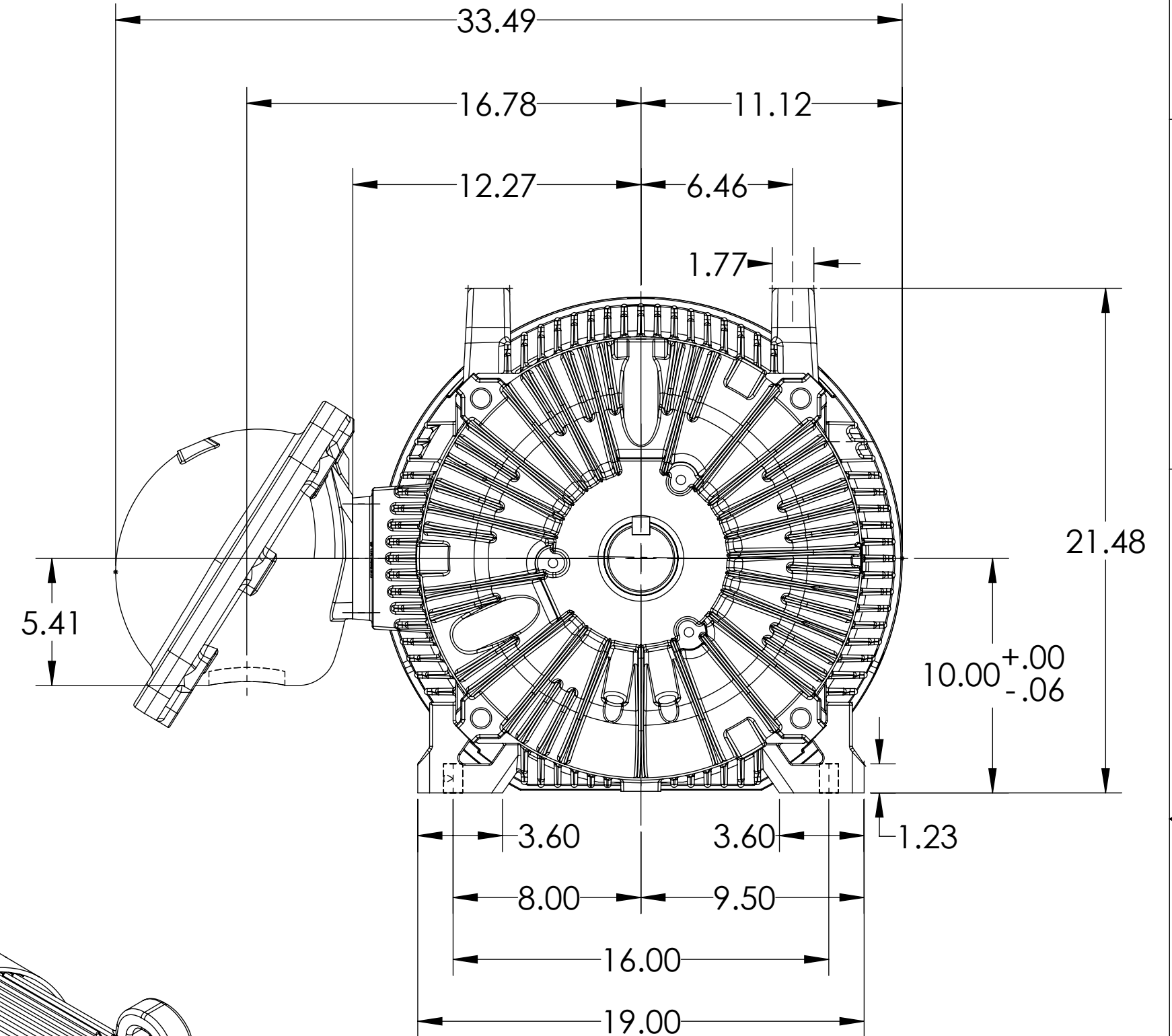
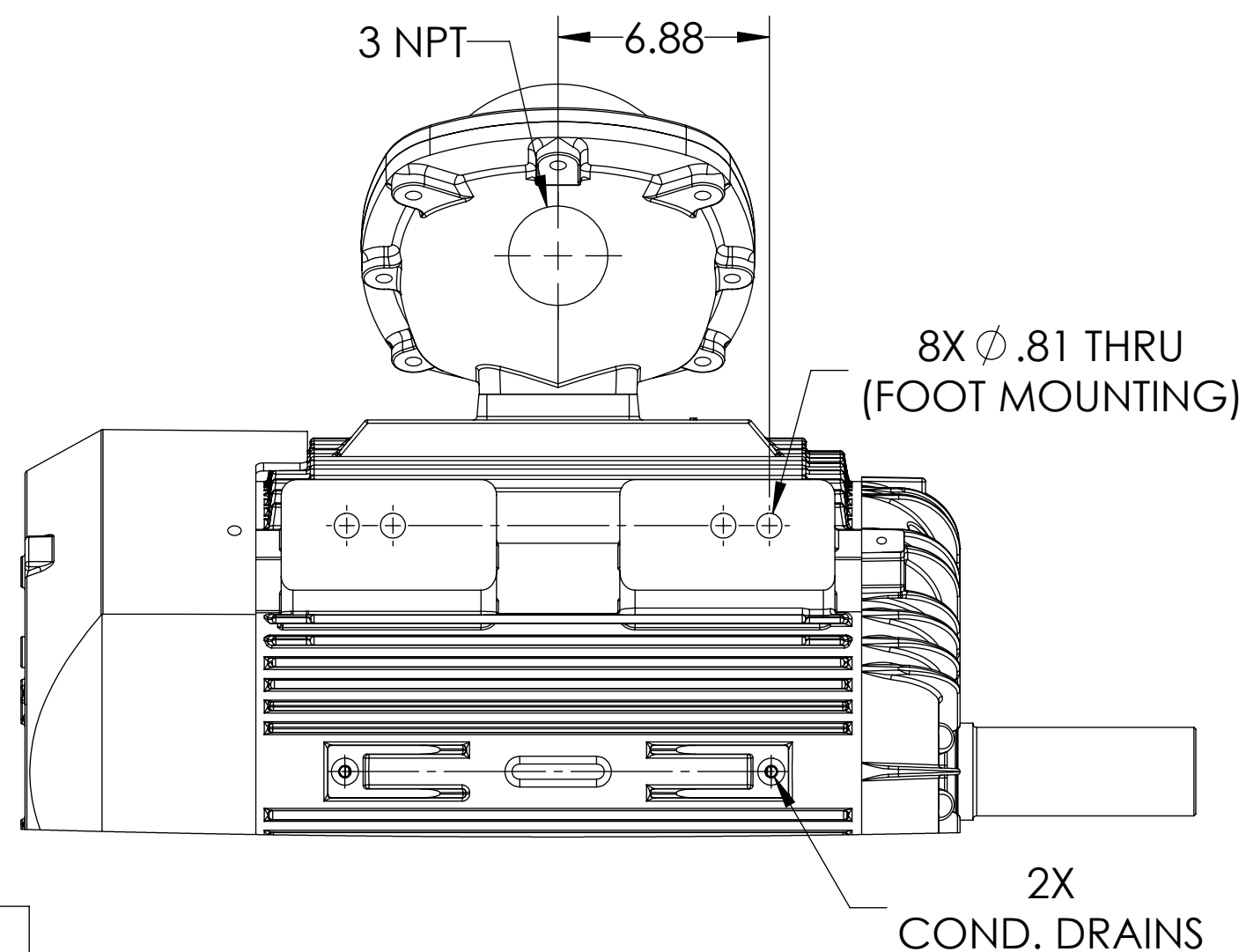
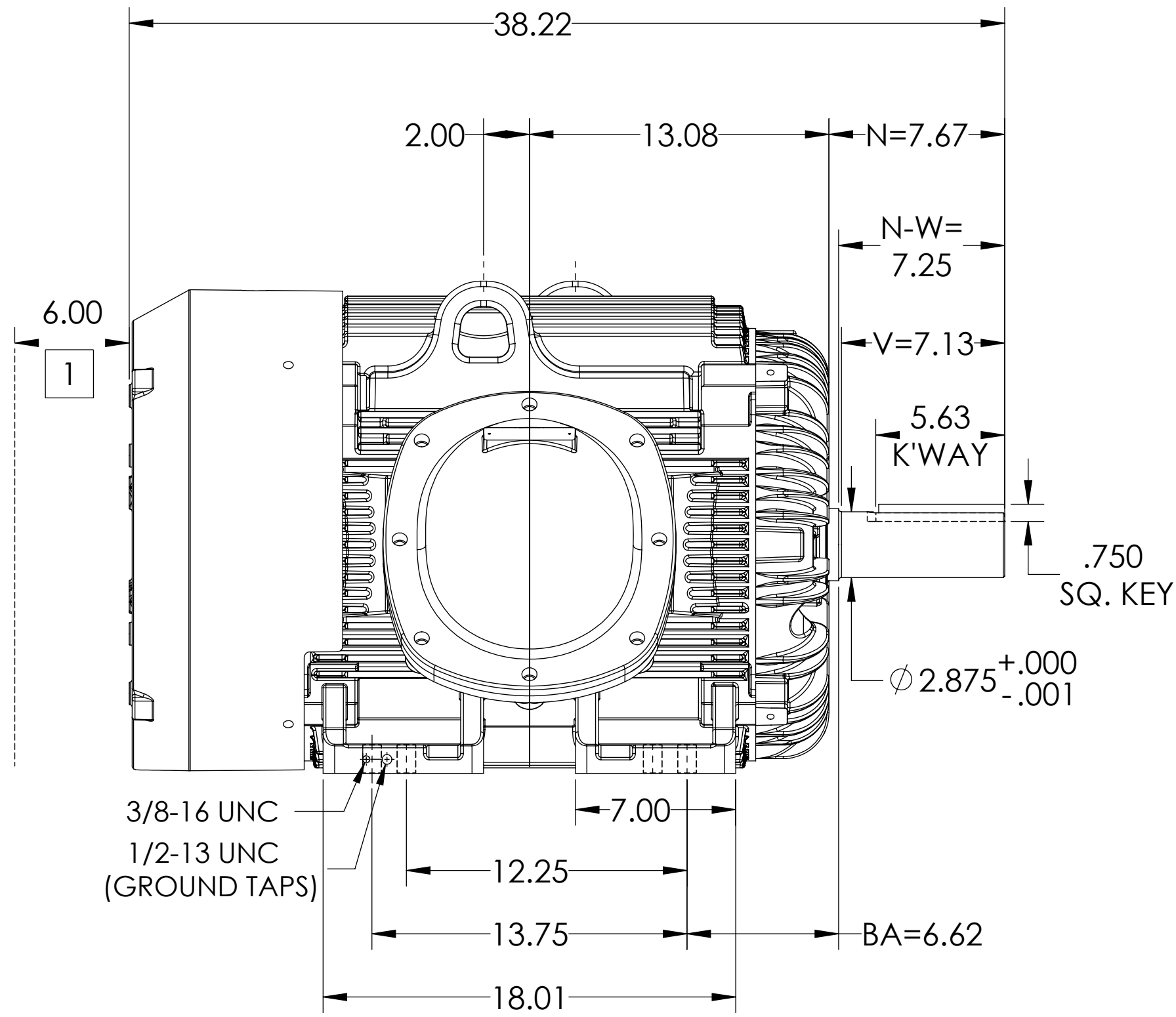

DIMENSIONS ARE IN INCHES.
WEIGHT: 1400 LBS \pm 15% DEPENDING ON RATING.
IF MOUNTING CLEARANCE DETAILS ARE REQUIRED, CONSULT FACTORY.
MAX PERMISSIBLE SHAFT RUNOUT WHEN MEASURED AT END OF STANDARD SHAFT EXTENSION IS .003" T.I.R.
CUSTOMER IS RESPONSIBLE FOR DETERMINING THAT MOTOR PERFORMANCE IS SUITABLE IN THE APPLICATION.

REV. DESC: NEW DRAWING			
REV: -	VERSION: 00	REVISED: 02:53:03 03/08/2019	TDR: 000001101608
MODEL NO. 617433-608			REF:
BY: USJEDIL		Material:	C

BALDOR

G405/404T TEFC XP F1 FOOT/CAST IRON BOX/CL.1 GRP C & D

SHEET NUMBER
1 OF 1

617433-608

1 OBSTRUCTION MUST NOT ENCROACH ON AIR INLET.

617433-608