

## SQUIRREL-CAGE INDUCTION

COOLING: FAN COOLED

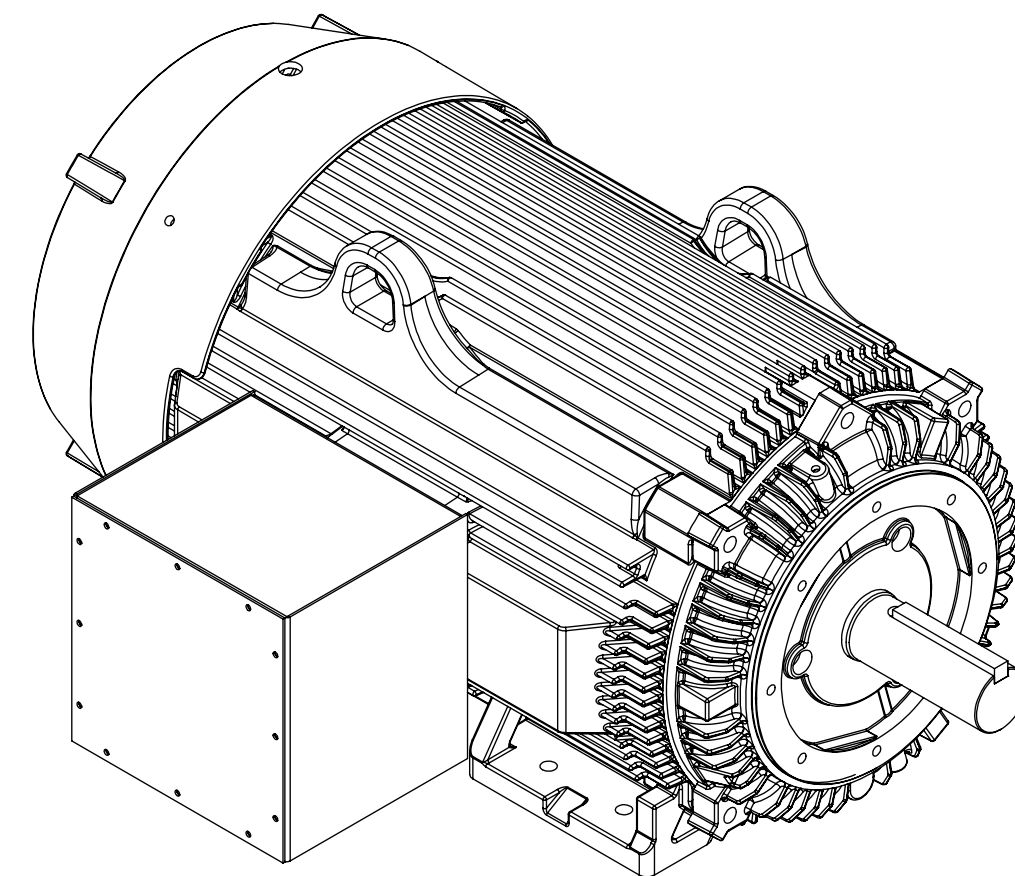
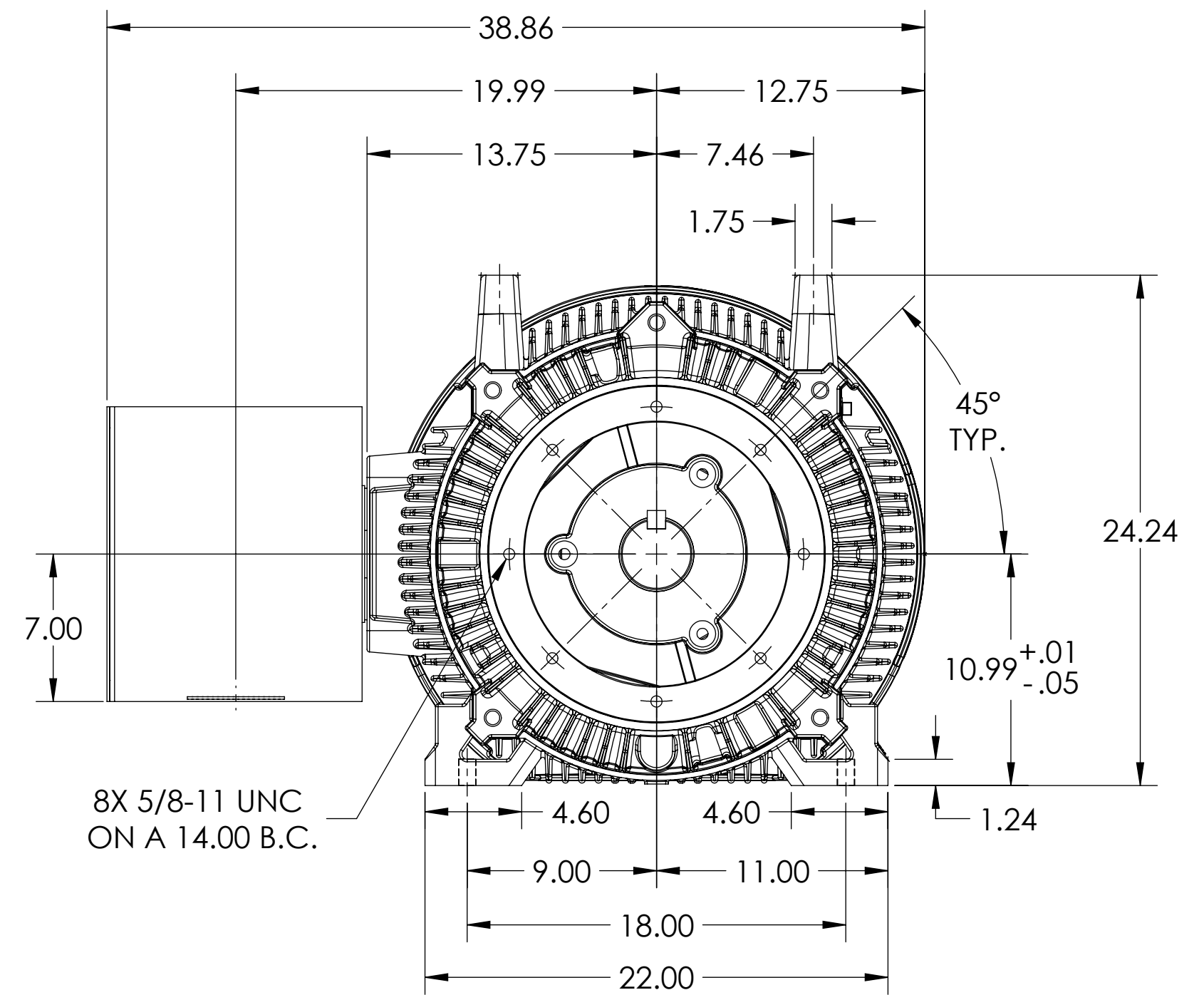

617427-670

MAX FACE RUNOUT & ECCENTRICITY = .007 T.I.R.  
MAX PERMISSIBLE SHAFT RUNOUT WHEN MEASURED AT END OF STANDARD SHAFT EXTENSION IS .003" T.I.R.