

## SQUIRREL-CAGE INDUCTION

## G449TC/G447TC FRAME MOUNTING HOLES

COOLING: FAN COOLED

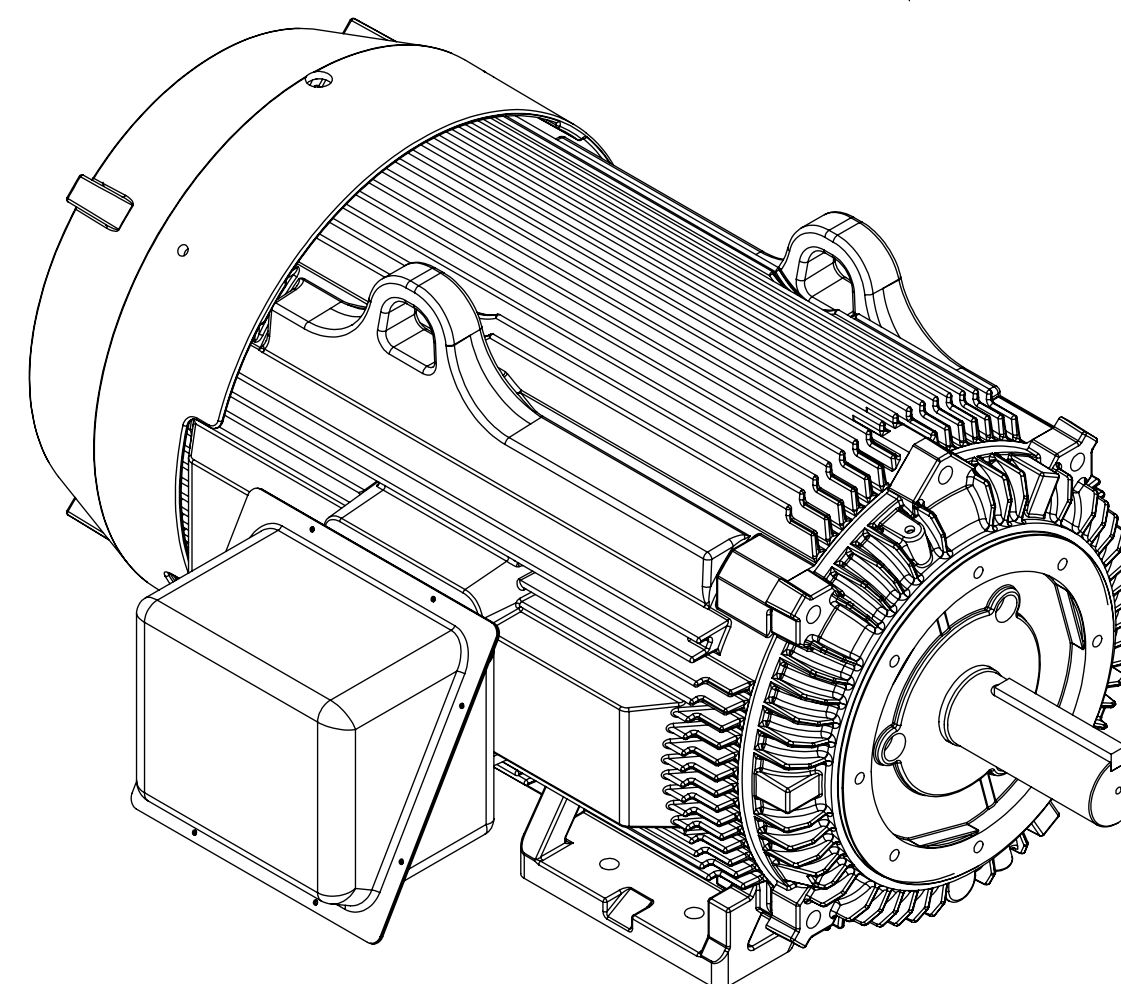
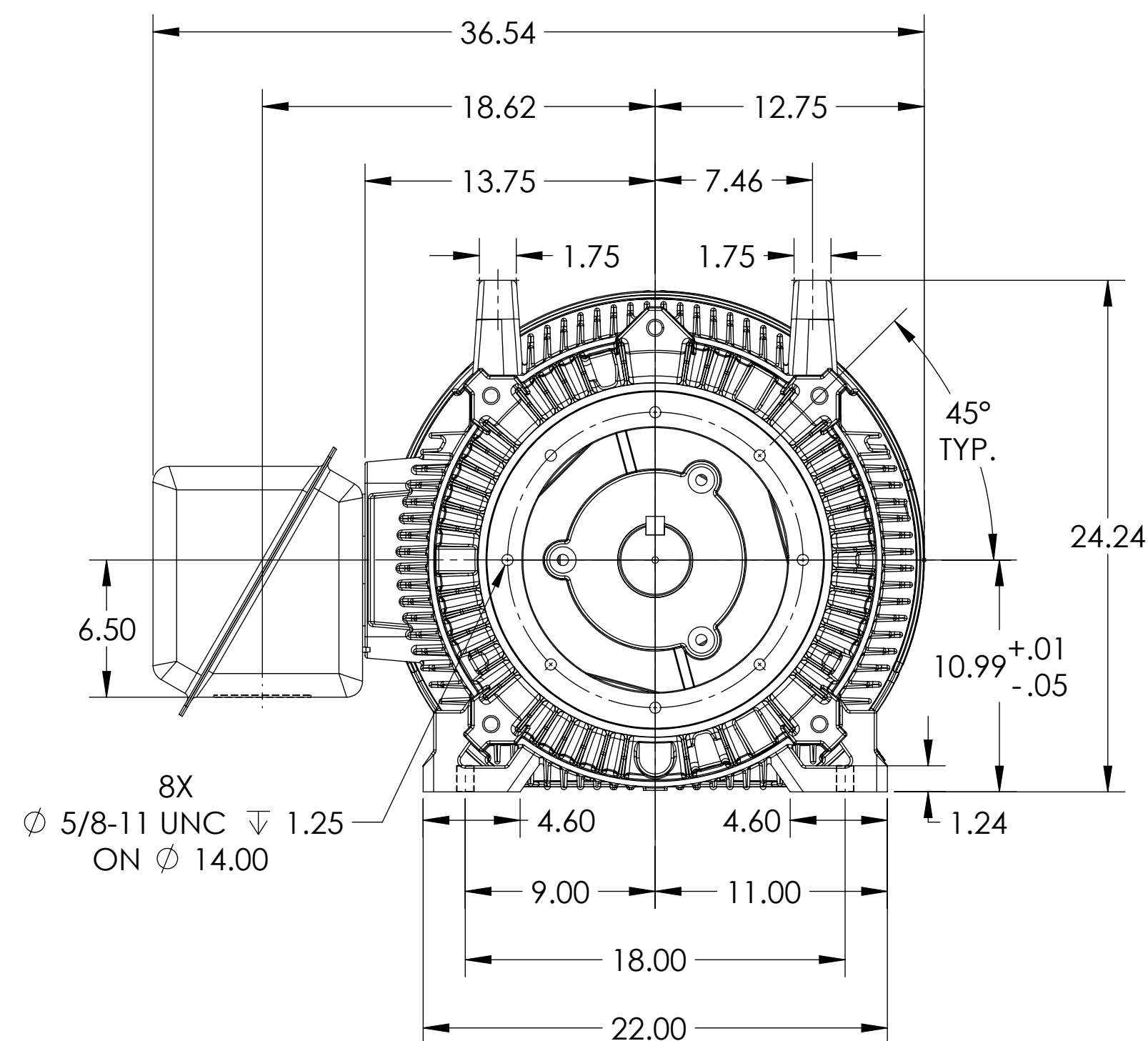

# BALDOR

G449/447TC TEFC F1 FOOT/STEEL CONDUIT BOX

IF MOUNTING CLEARANCE DETAILS ARE REQUIRED, CONSULT FACTORY.  
MAX PERMISSIBLE SHAFT RUNOUT WHEN MEASURED AT END OF STANDARD SHAFT EXTENSION IS .003" T.I.R.

|                              |             |                              |                   |
|------------------------------|-------------|------------------------------|-------------------|
| REV. DESC: UPDATE DS QUALITY |             |                              |                   |
| REV: B                       | VERSION: 02 | REVISED: 12:31:47 07/28/2022 | TDR: 000001194511 |
| MODEL NO. 617435-124         |             |                              |                   |
| BY: USJEDIL                  |             |                              |                   |

617435-124