

DUTY MASTER ALTERNATING CURRENT MOTORS
SQUIRREL-CAGE INDUCTION

617435-359

ENCLOSURE: TOTALLY ENCLOSED

SQUIRREL-CAGE INDUCTION

MOUNTING: FOOT, F-1 SIDE, C-FACE

G447TC/G445TC FRAME MOUNTING HOLES

COOLING: FAN COOLED

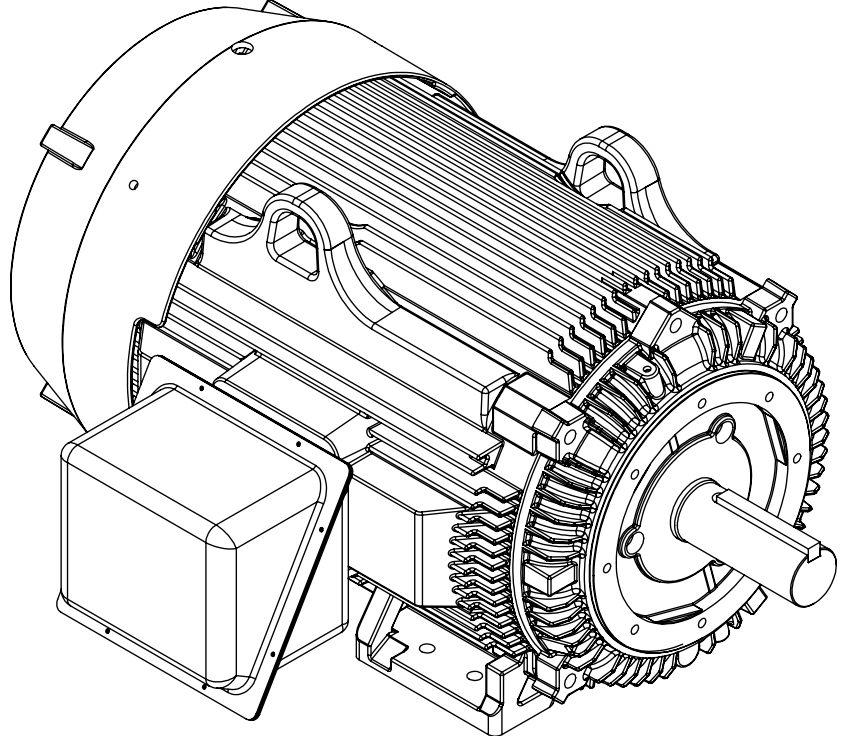
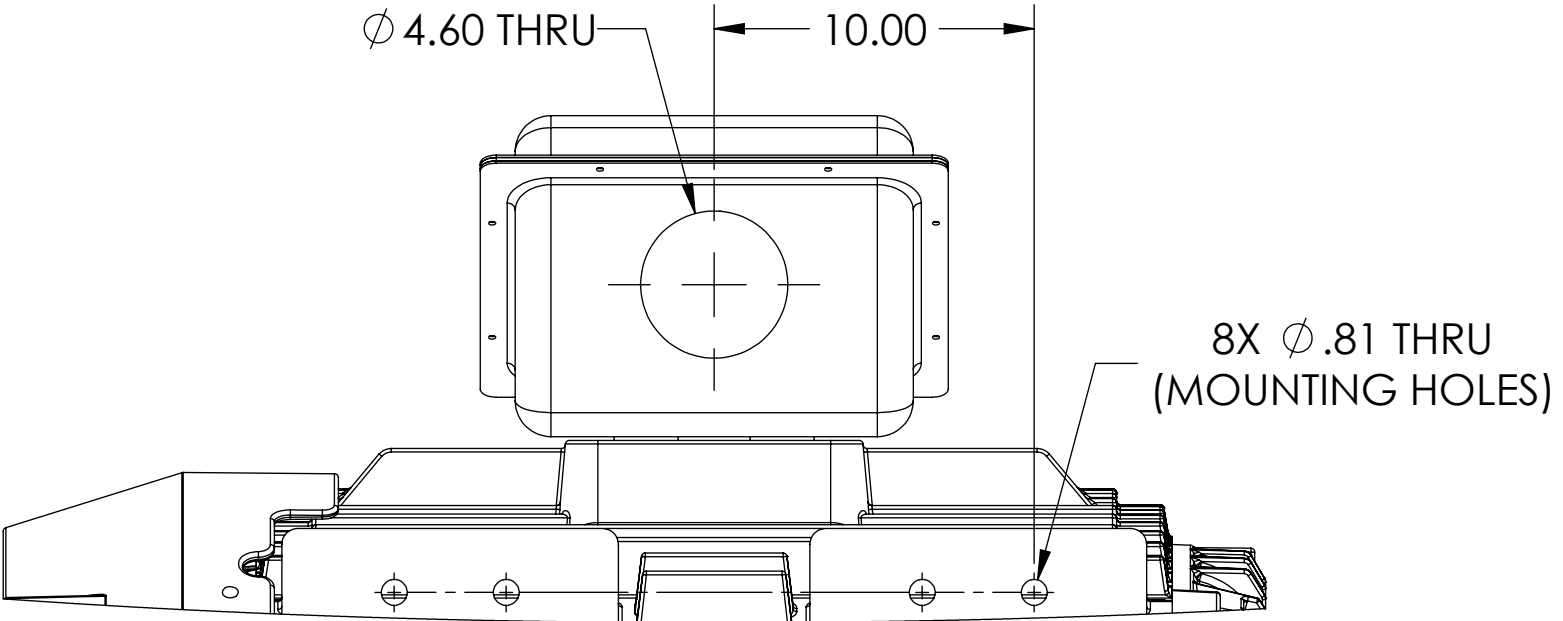
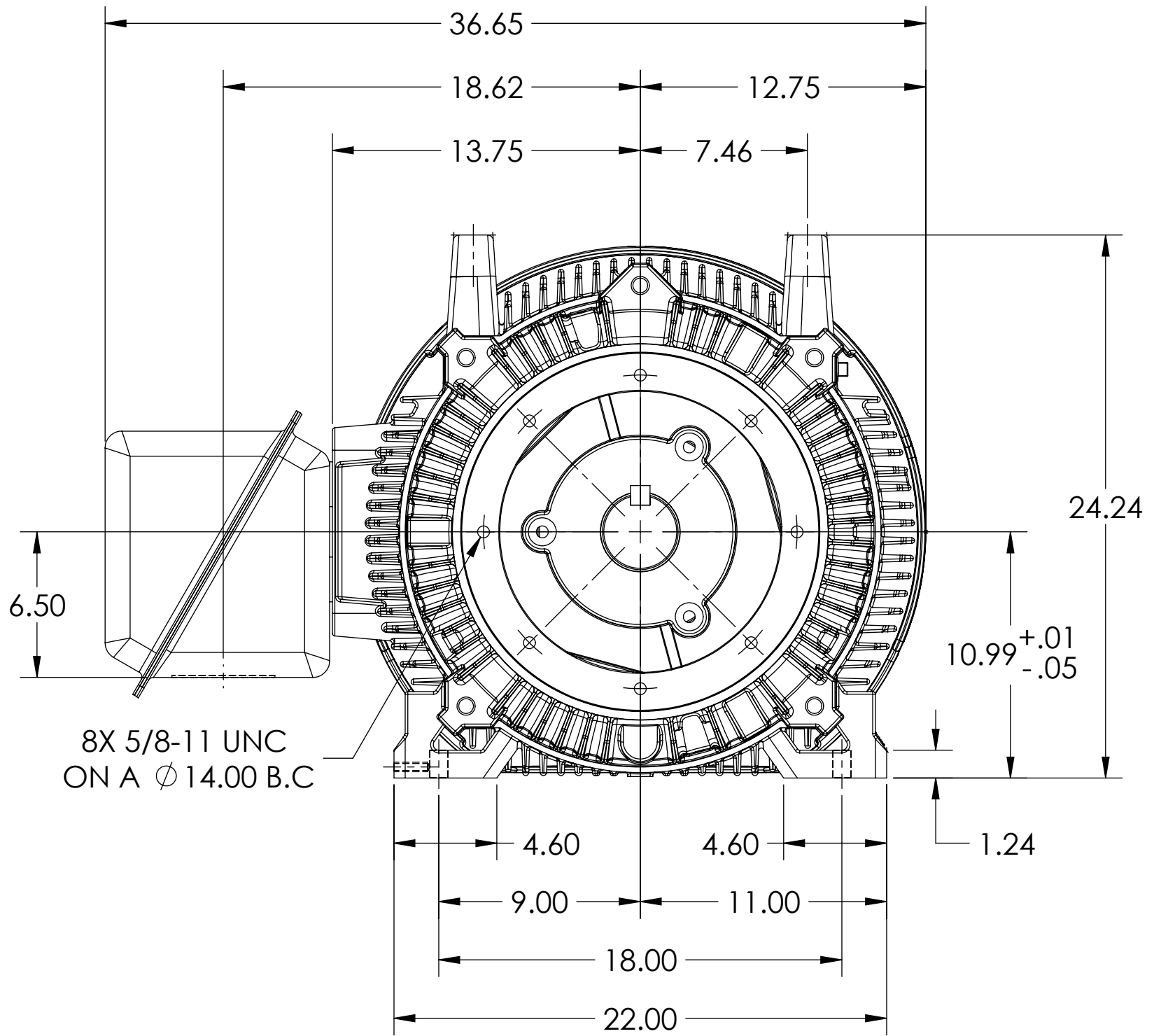
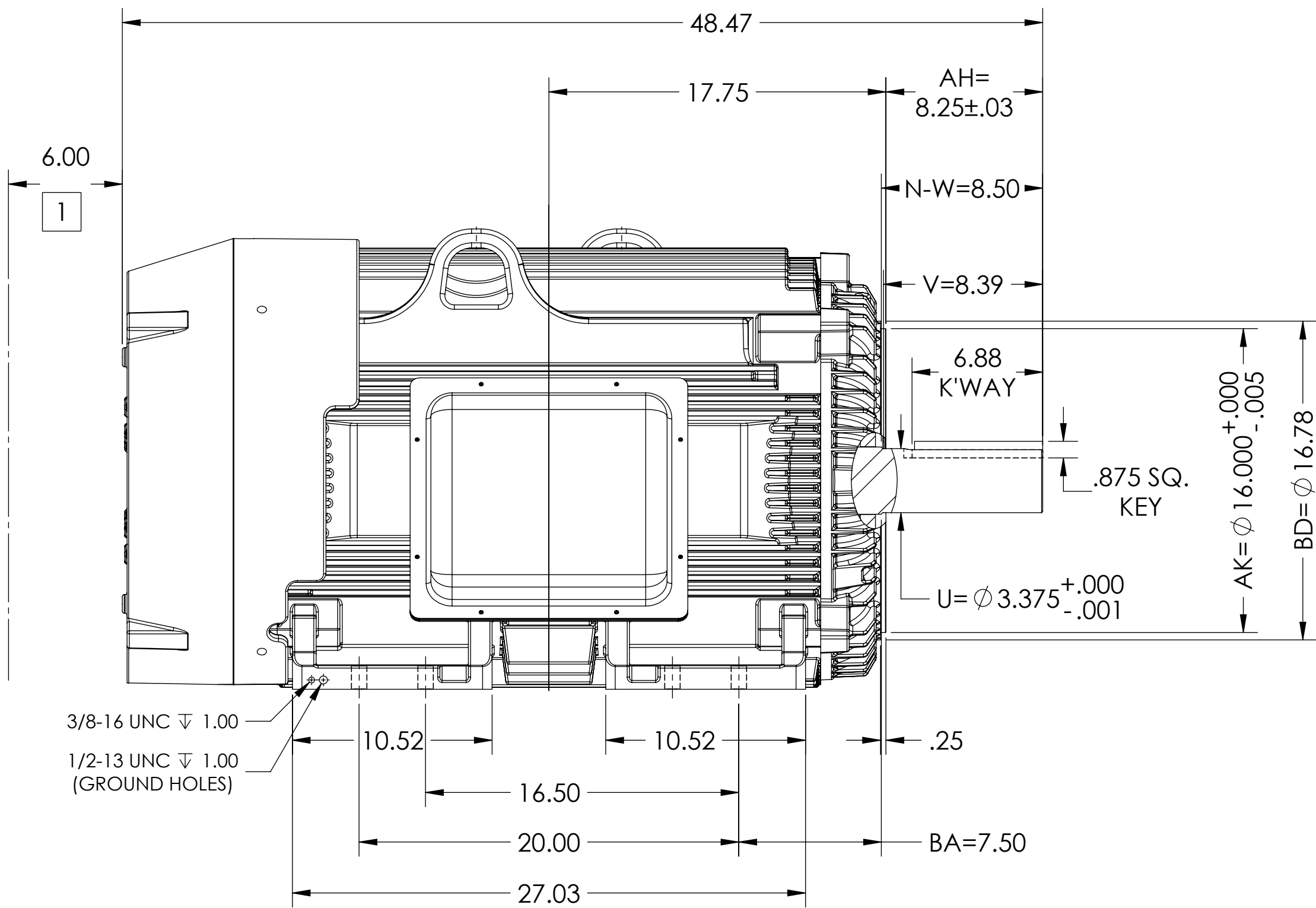

1 OBSTRUCTION MUST NOT ENCHROACH ON AIR INLET

FACE RUNOUT & ECCENTRICITY .007 MAX T.I.R.
IF MOUNTING CLEARANCE DETAILS ARE REQUIRED, CONSULT FACTORY.
PERMISSIBLE SHAFT RUNOUT WHEN MEASURED AT END OF STANDARD SHAFT EXTENSION IS .003" T.I.R.

DIMENSIONS ARE IN INCHES.
CUSTOMER IS RESPONSIBLE FOR DETERMINING THAT MOTOR PERFORMANCE IS SUITABLE IN THE APPLICATION.

REV. DESC: NEW DRAWING			
REV: -	VERSION: 00	REVISED: 10:58:56 02/17/2017	TDR: 000001016321
MODEL NO. 617435-359		REF:	
BY: USJEDIL		Material:	

BALDOR

G447/445TC TEFC FOOTED F1 S/C STEEL CONDUIT BOX

617435-359

617435-359