

DUTY MASTER ALTERNATING CURRENT MOTORS

SQUIRREL-CAGE INDUCTION

ENCLOSURE: TOTALLY ENCLOSED

SQUIRREL-CAGE INDUCTION

MOUNTING: FOOT, F1, C-FACE

G445TC/G444TC FRAME MOUNTING HOLES

COOLING: FAN COOLED

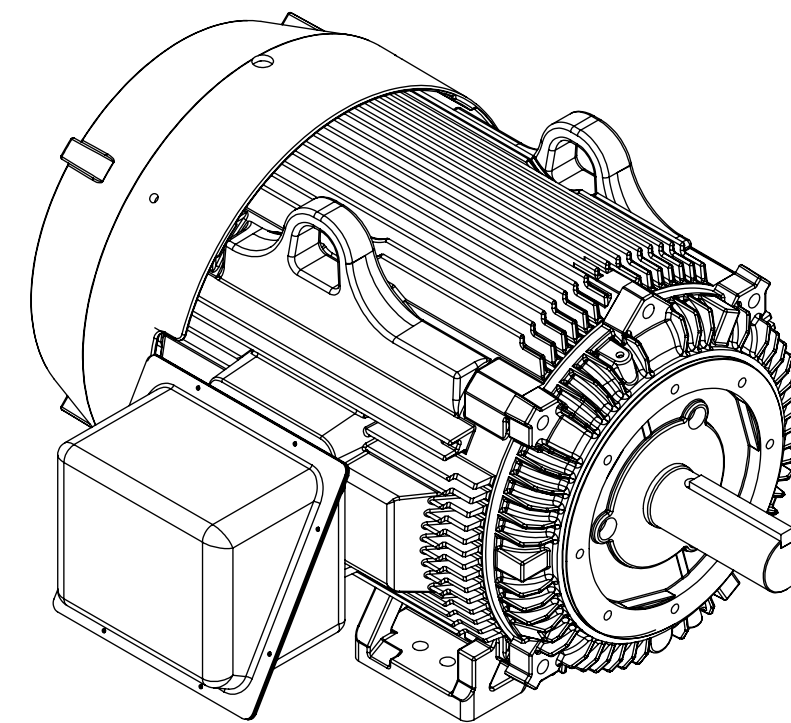
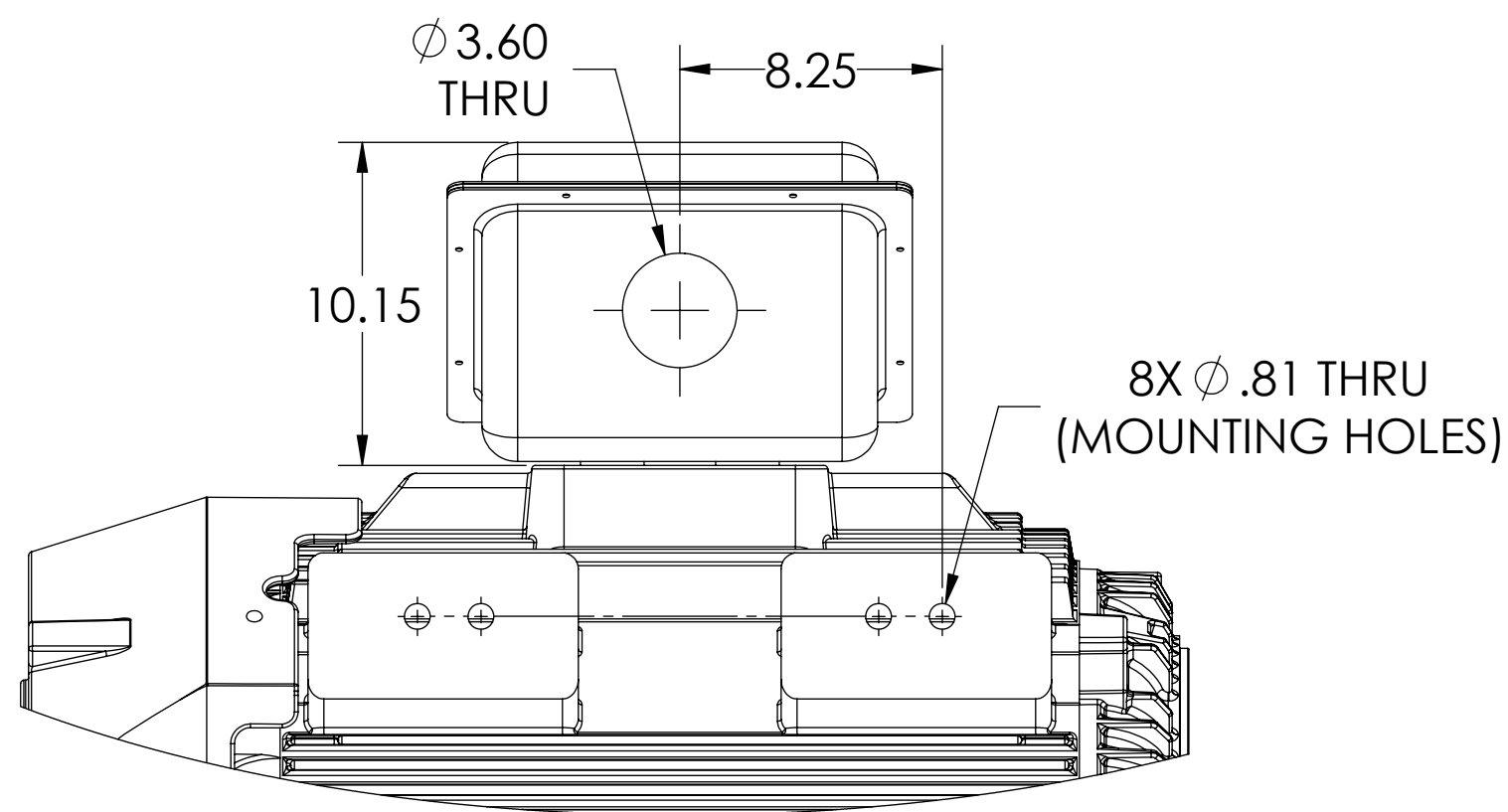
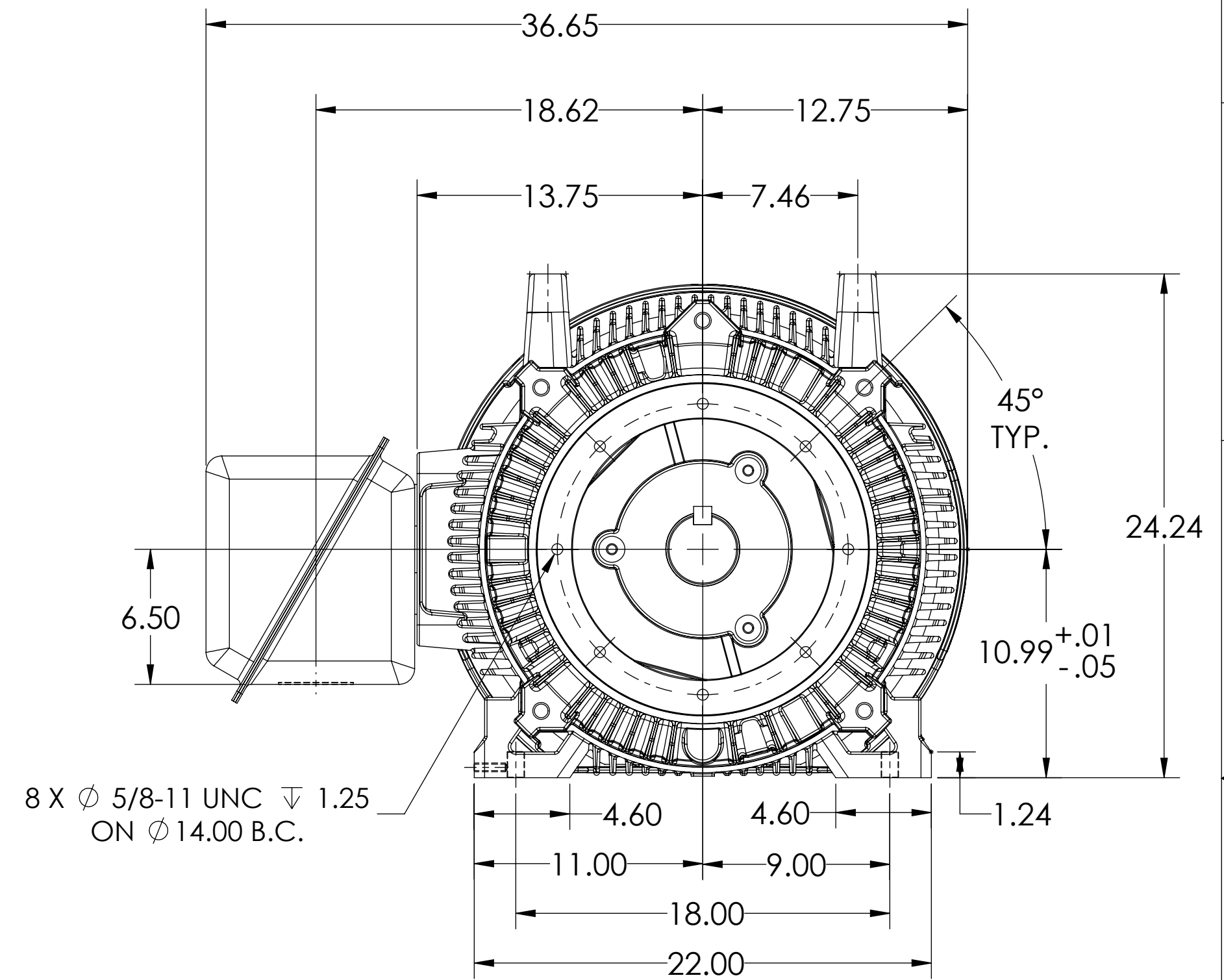
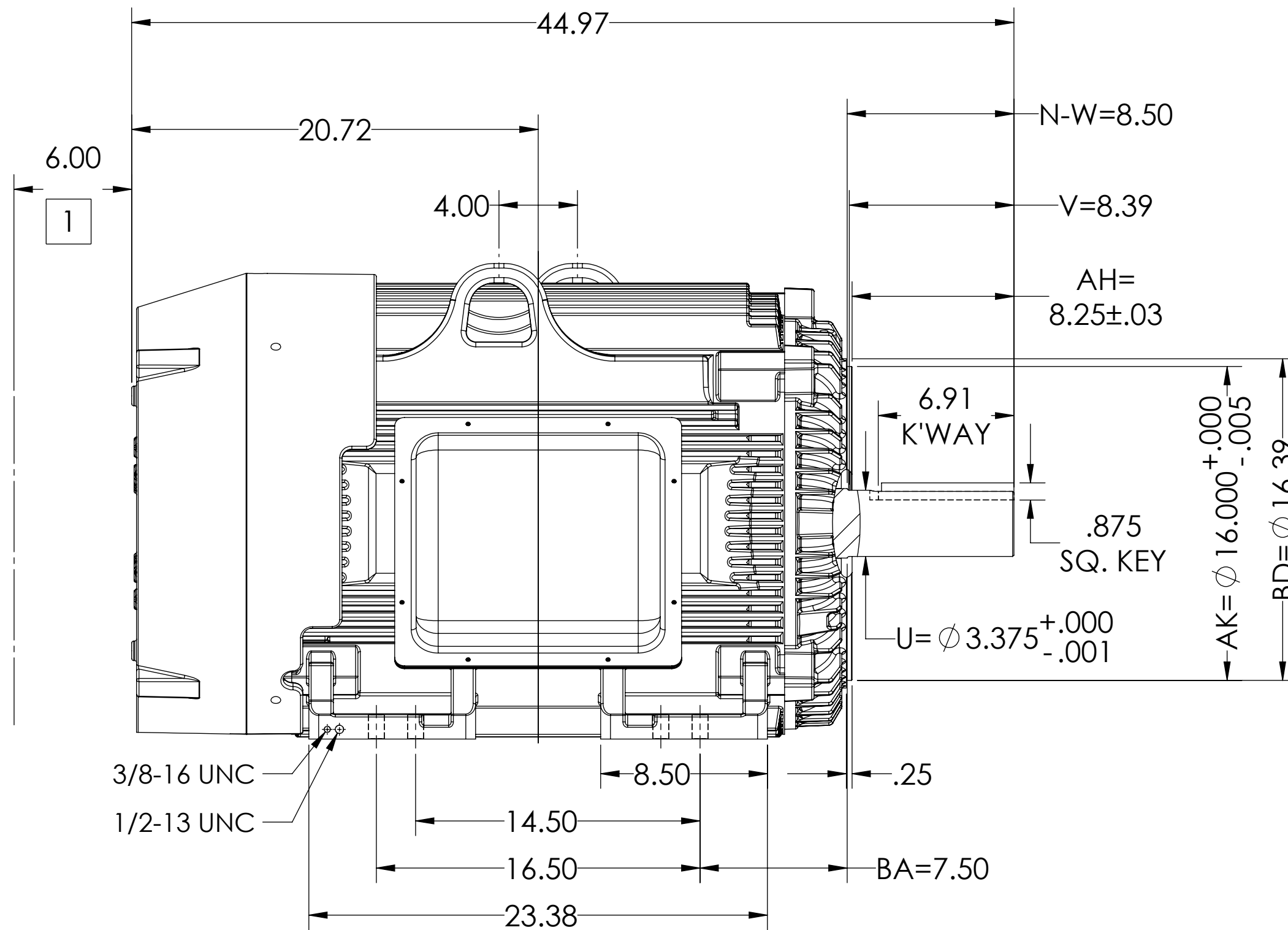

1 OBSTRUCTION MUST NOT ENCROACH ON AIR INLET.

FACE RUNOUT AND ECCENTRICITY .007 MAX T.I.R
IF MOUNTING CLEARANCE DETAILS ARE REQUIRED, CONSULT FACTORY.
MAX PERMISSIBLE SHAFT RUNOUT WHEN MEASURED AT END OF STANDARD SHAFT EXTENSION IS .003" T.I.R.

DIMENSIONS ARE IN INCHES.
WEIGHT (LBS): 2130, MOTOR WEIGHTS MAY VARY BY 15% DEPENDING ON RATING.
CUSTOMER IS RESPONSIBLE FOR DETERMINING THAT MOTOR PERFORMANCE IS SUITABLE IN THE APPLICATION.

REV. DESC: UPDATING DRAWING			
REV: A	VERSION: 01	REVISED: 09:23:57 02/17/2017	TDR: 000001016320
MODEL NO. 617427-802			REF:
BY: USJEDIL		Material:	

BALDOR

G445TC/444TC TEFC FOOTED F1 S/C STEEL CONDUIT BOX