

COOLING: FAN COOLED

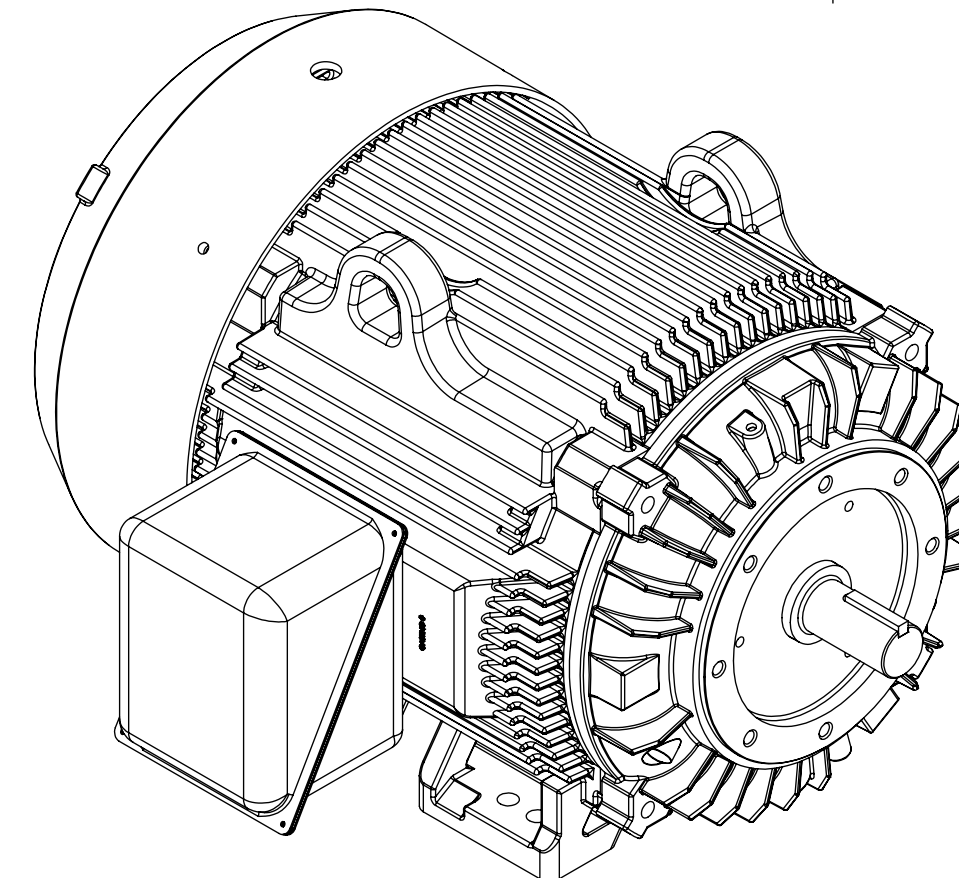
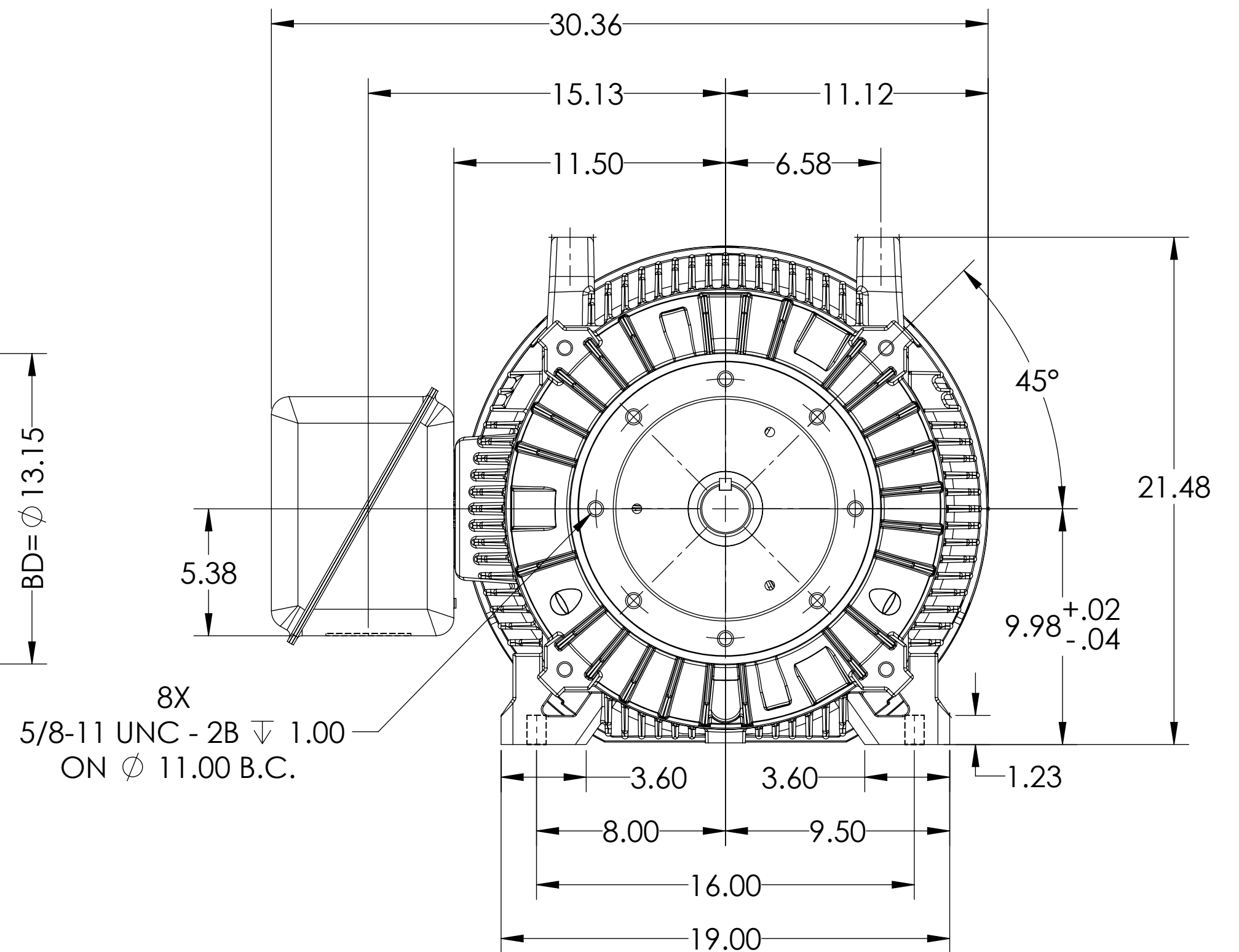

405/4TSC TEFC F1 FT S -

617429-641

MAX FACE RUNOUT AND FIT ECCENTRICITY = 0.007 T.I.R.  
IF MOUNTING CLEARANCE DETAILS ARE REQUIRED, CONSULT FACTORY.  
MAX PERMISSIBLE SHAFT RUNOUT WHEN MEASURED AT END OF STANDARD SHAFT EXTENSION IS .003" T.I.R.

617429-64