

# DUTY MASTER ALTERNATING CURRENT MOTORS

## SQUIRREL-CAGE INDUCTION

ENCLOSURE: TOTALLY ENCLOSED

MOUNTING: FOOT, F-1 , C-FACE

G405TC/G404TC FRAME MOUNTING HOLES  
CAST IRON C-BOX  
DIV. 2/GROUP F & G

COOLING: FAN COOLED

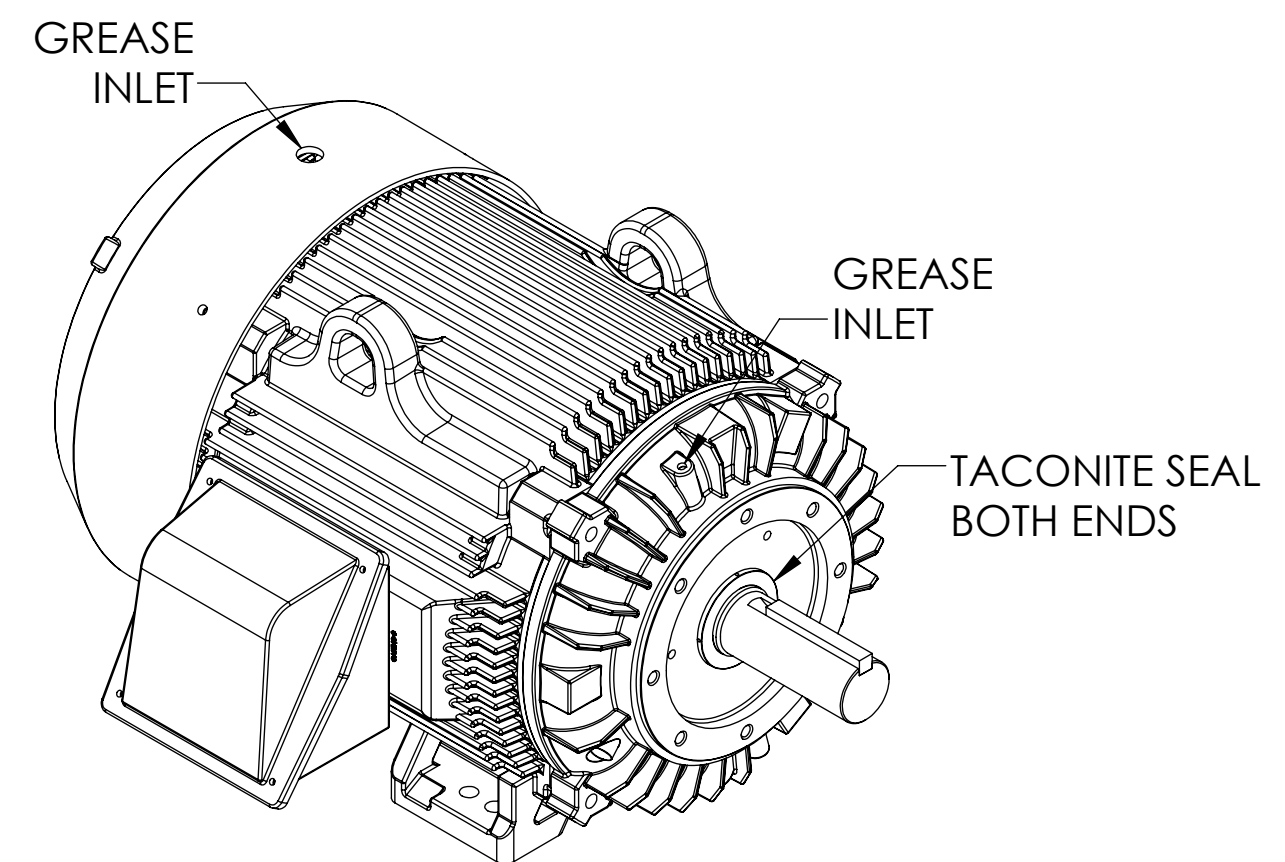
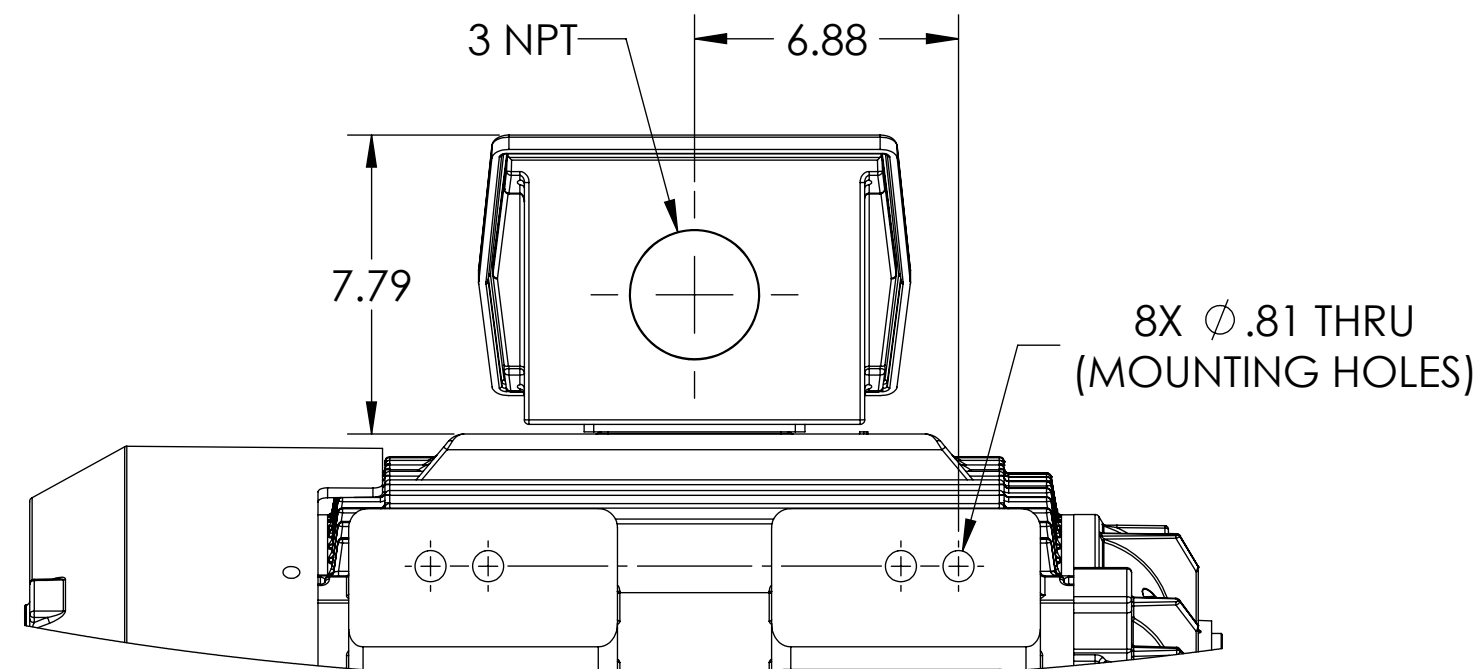
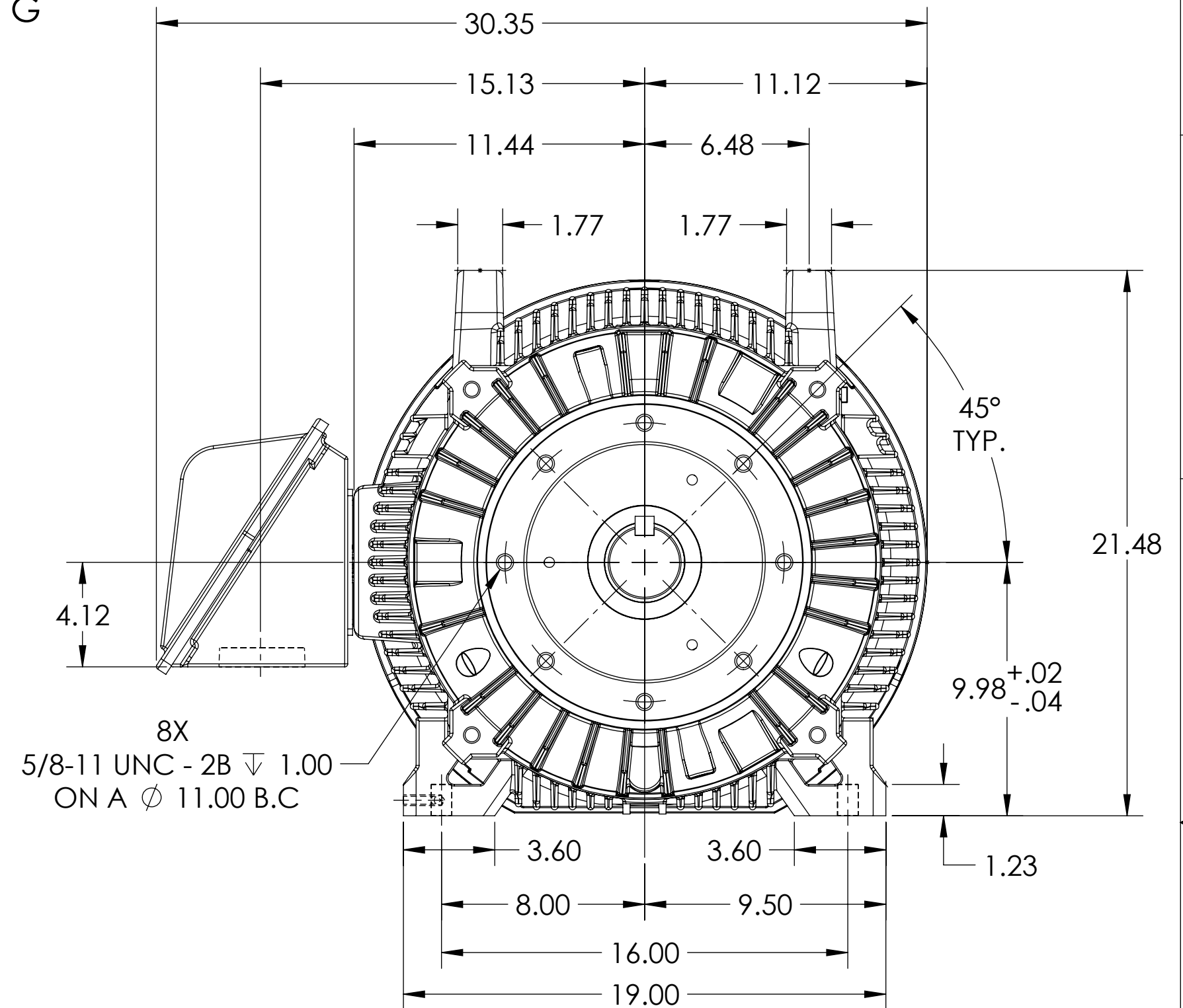
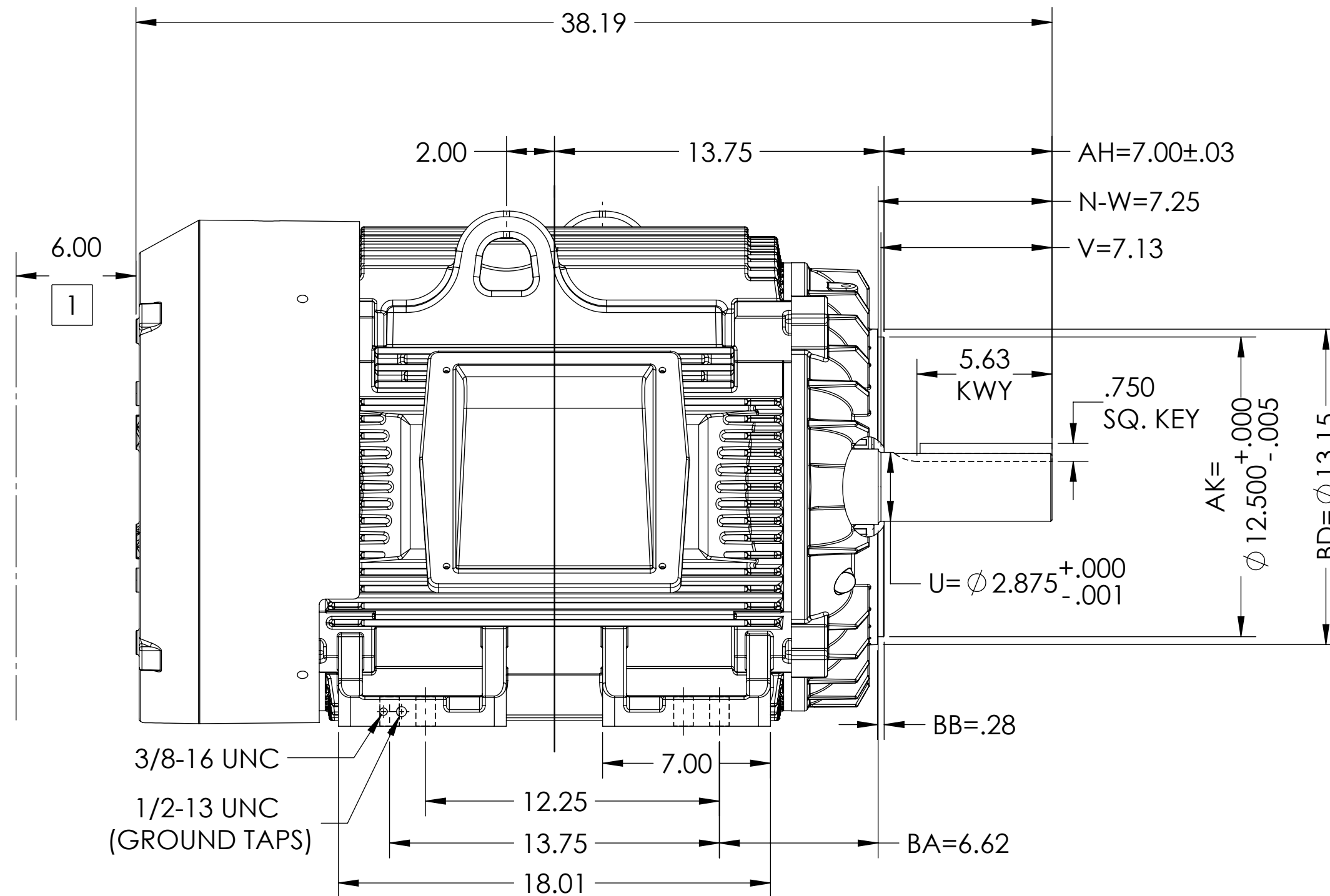

1 OBSTRUCTIONS MUST NOT ENCROACH ON AIR INLET.

FACE RUNOUT & ECCENTRICITY .007 T.I.R  
IF MOUNTING CLEARANCE DETAILS ARE REQUIRED, CONSULT FACTORY.  
MAX PERMISSIBLE SHAFT RUNOUT WHEN MEASURED AT END OF STANDARD SHAFT EXTENSION IS .003" T.I.R.

WEIGHT (LBS): 1300±15%  
DIMENSIONS ARE IN INCHES.  
CUSTOMER IS RESPONSIBLE FOR DETERMINING THAT MOTOR PERFORMANCE IS SUITABLE IN THE APPLICATION

REV. DESC: NEW LAYOUT			
REV: -	VERSION: 00	REVISED: 10:36:41 12/13/2024	TDR: 000001239215
MODEL NO. 617437-733			
BY: USTIREE		C	

**BALDOR**

G405/404TC FC F1 FT S/C CI CBOX - TACONITE GR.F&G DIV 2