



DUTY MASTER ALTERNATING CURRENT MOTORS  
SQUIRREL-CAGE INDUCTION

617435-162

ENCLOSURE: TOTALLY ENCLOSED

MOUNTING: FOOT, F-1

G445TC/G444TC MOUNTING

COOLING: FAN COOLED

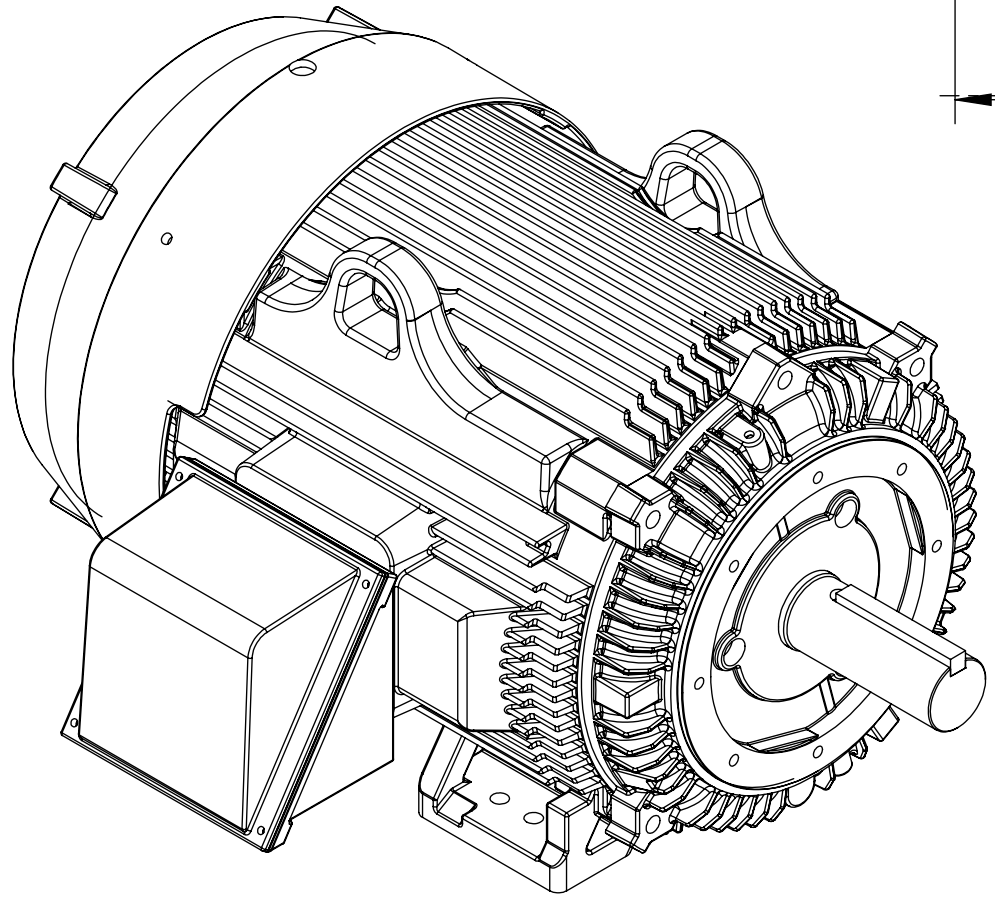
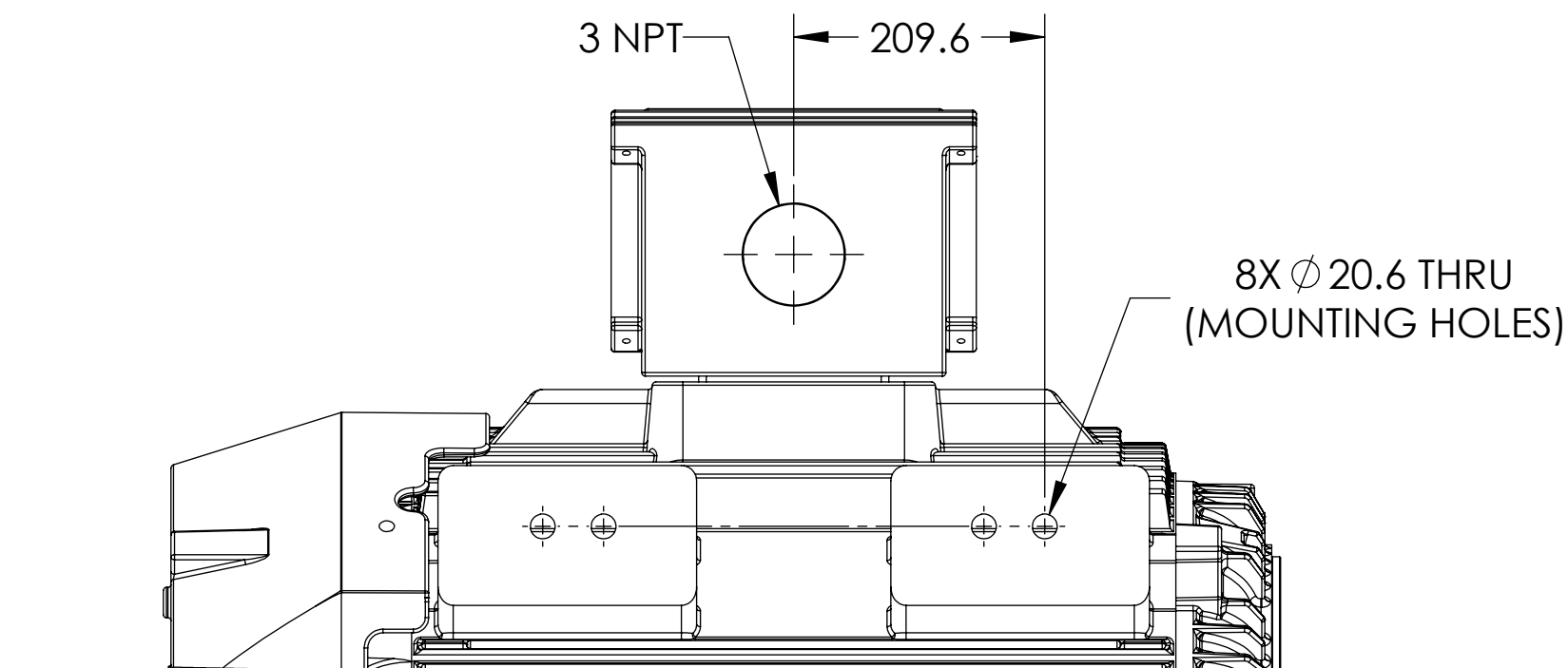
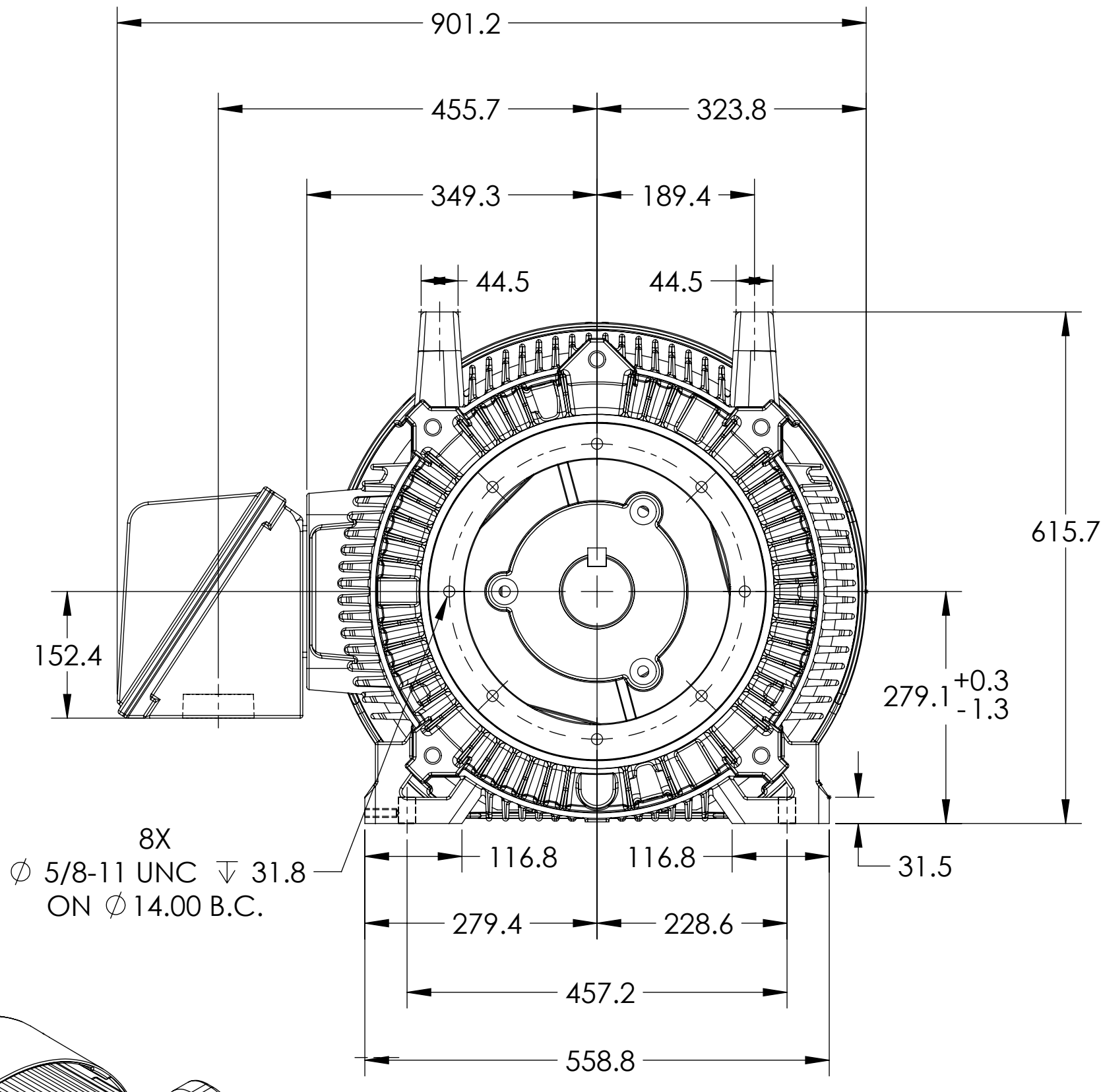
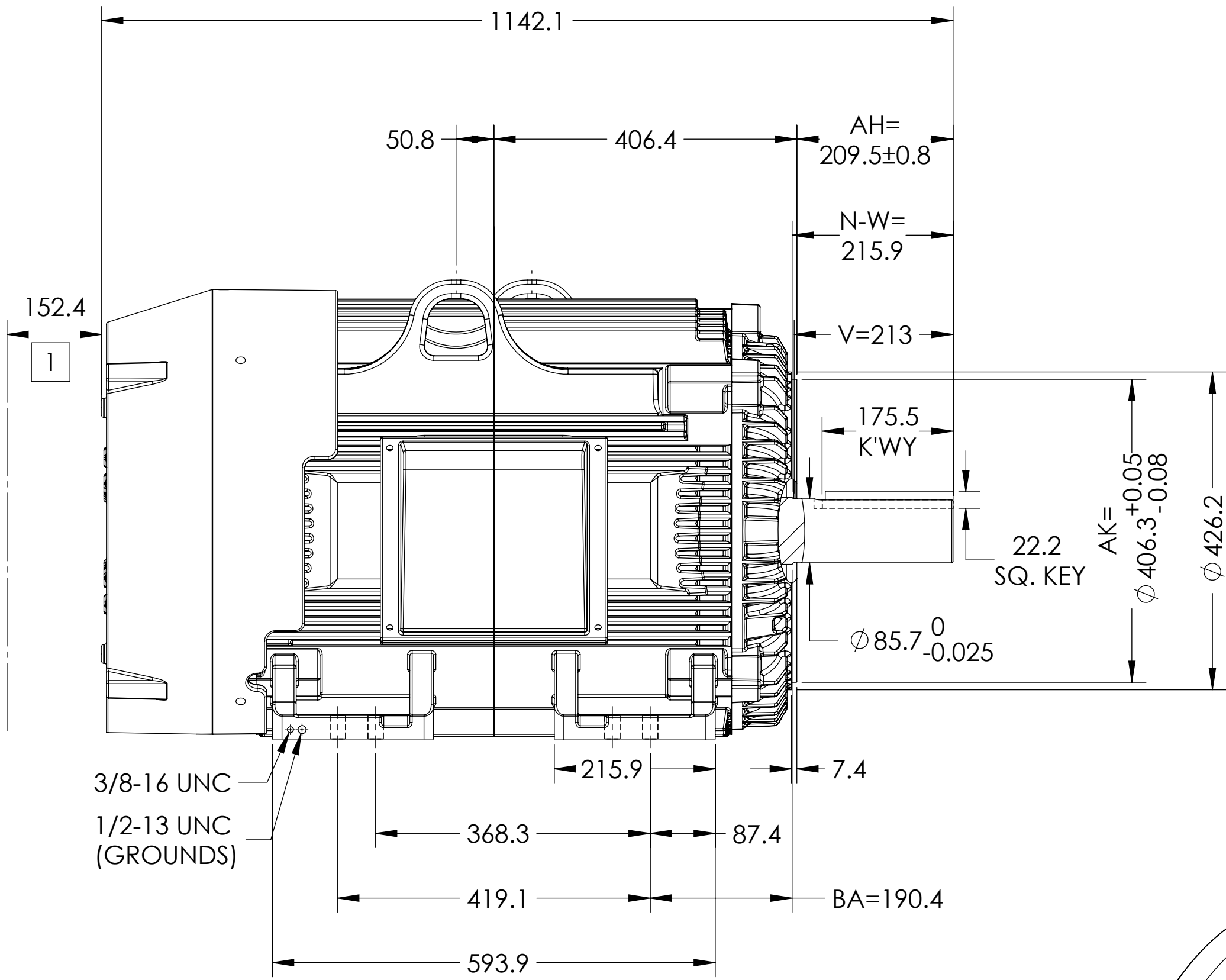

DIMENSIONS ARE IN MILLIMETERS.  
MAX FACE AND FIR RUNOUT = 0.18  
WEIGHT (KG): 966, MOTOR WEIGHTS MAY VARY BY +/- 15% DEPENDING ON RATING.  
CUSTOMER IS RESPONSIBLE FOR DETERMINING THAT MOTOR PERFORMANCE IS SUITABLE IN THE APPLICATION.

REV. DESC: UPDATE DS QUALITY/ADD METRIC DS			
REV: B	VERSION: 02	REVISED: 10:17:15 05/24/2022	TDR: 000001191365
MODEL NO. 617435-162		REF:	
BY: USJEDIL		Material:	

**BALDOR**

G445/444TC TEFC FOOT F1/CAST IRON CONDUIT BOX

1 OBSTRUCTIONS MUST NOT ENCROACH ON AIR INLET.

IF MOUNTING CLEARANCE DETAILS ARE REQUIRED, CONSULT FACTORY.  
MAX PERMISSIBLE SHAFT RUNOUT WHEN MEASURED AT END OF STANDARD SHAFT EXTENSION IS .08 T.I.R.

SHEET NUMBER  
2 OF 2

617435-162

617435-162