

S4LYP064

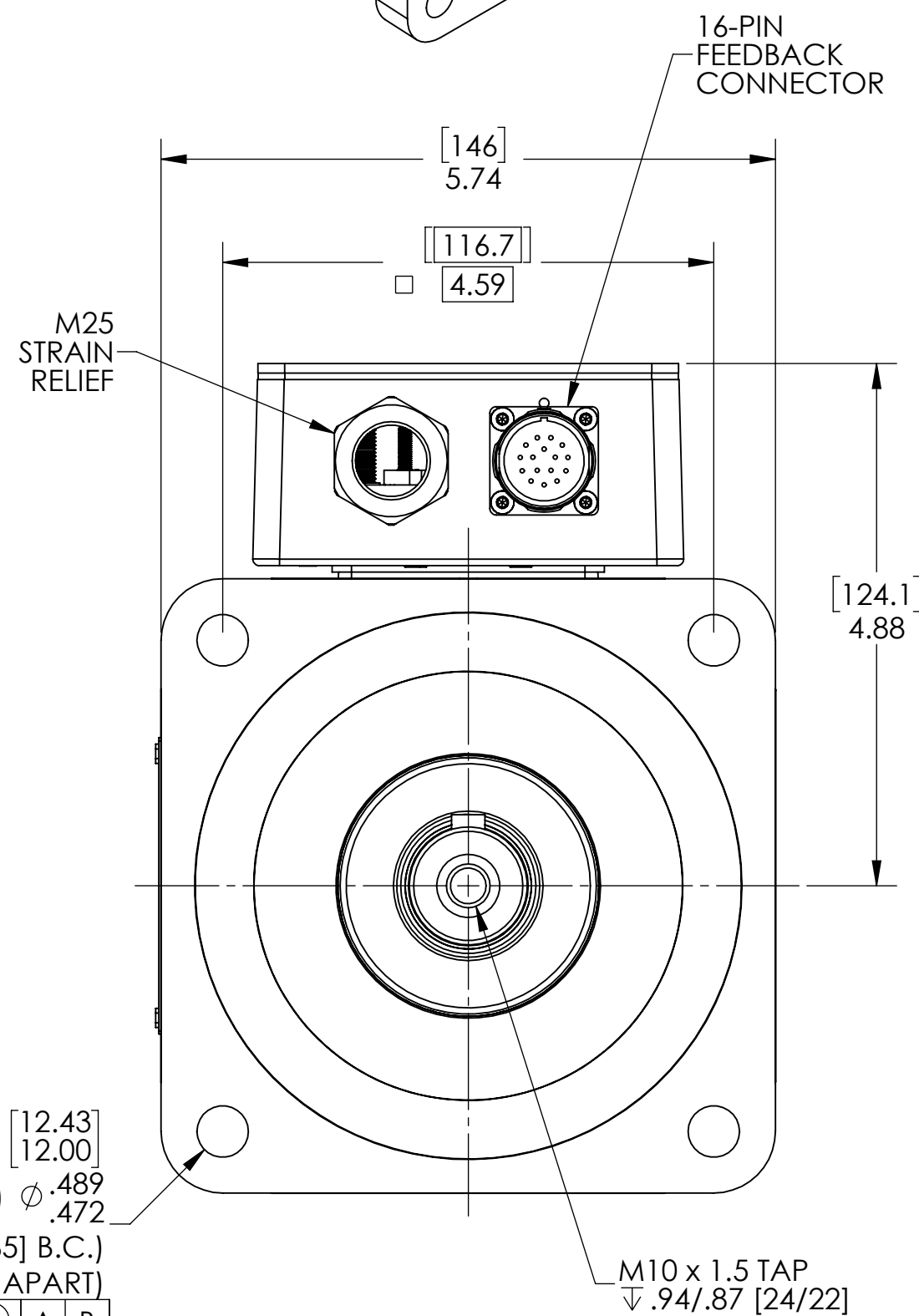
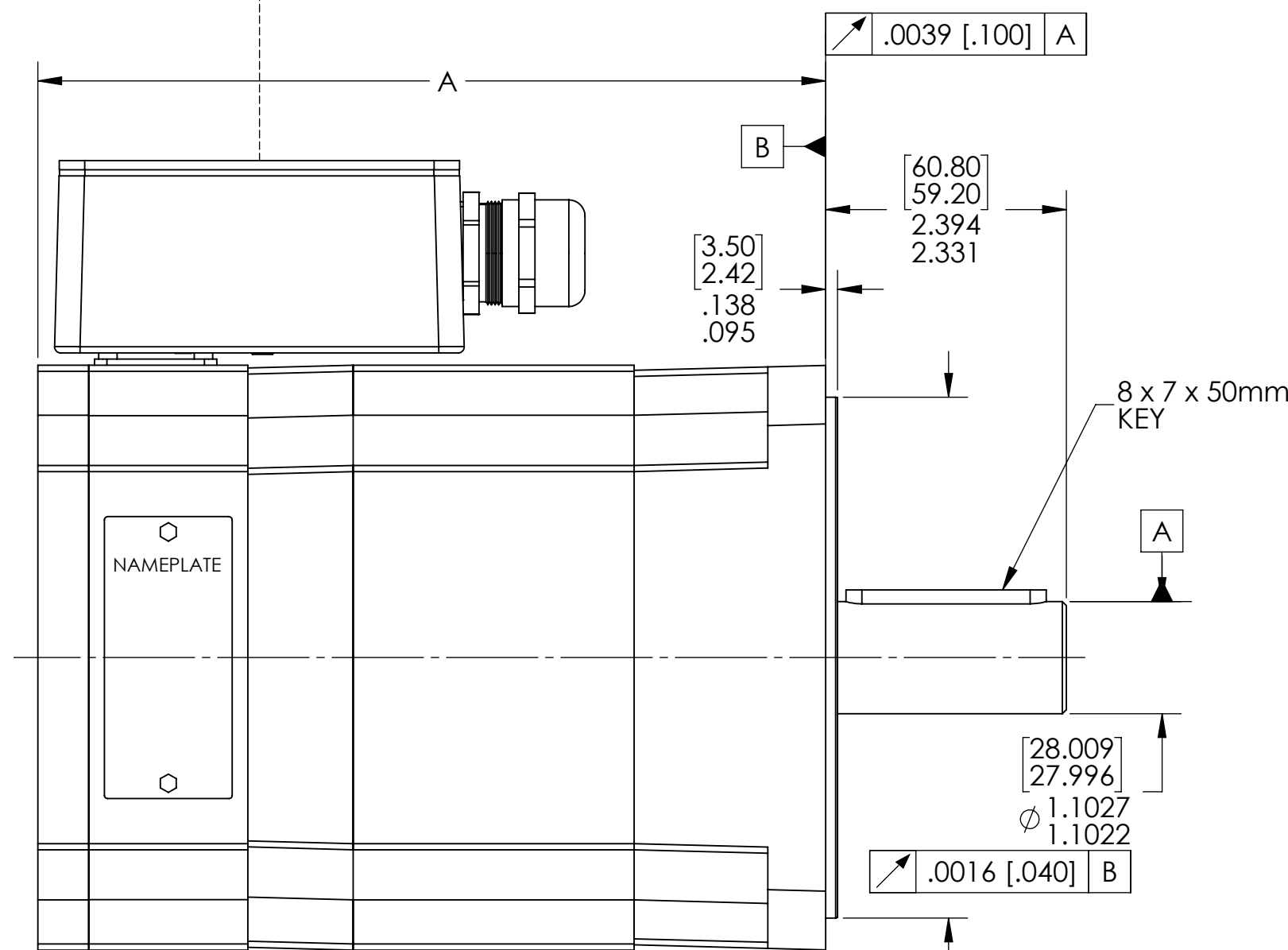
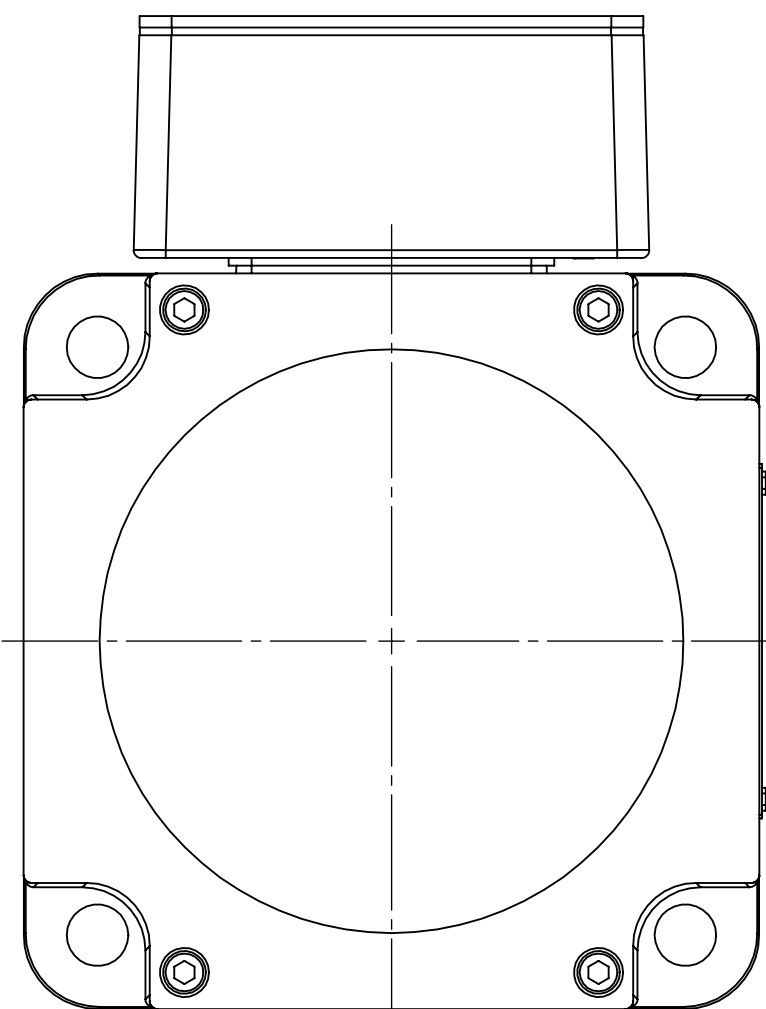
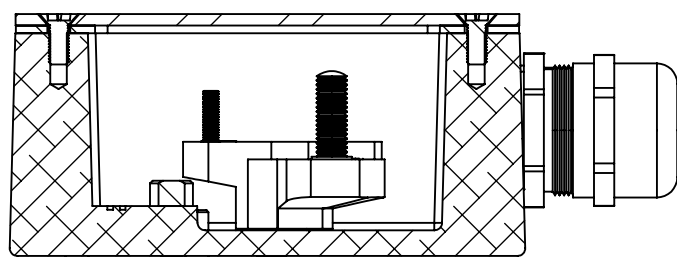
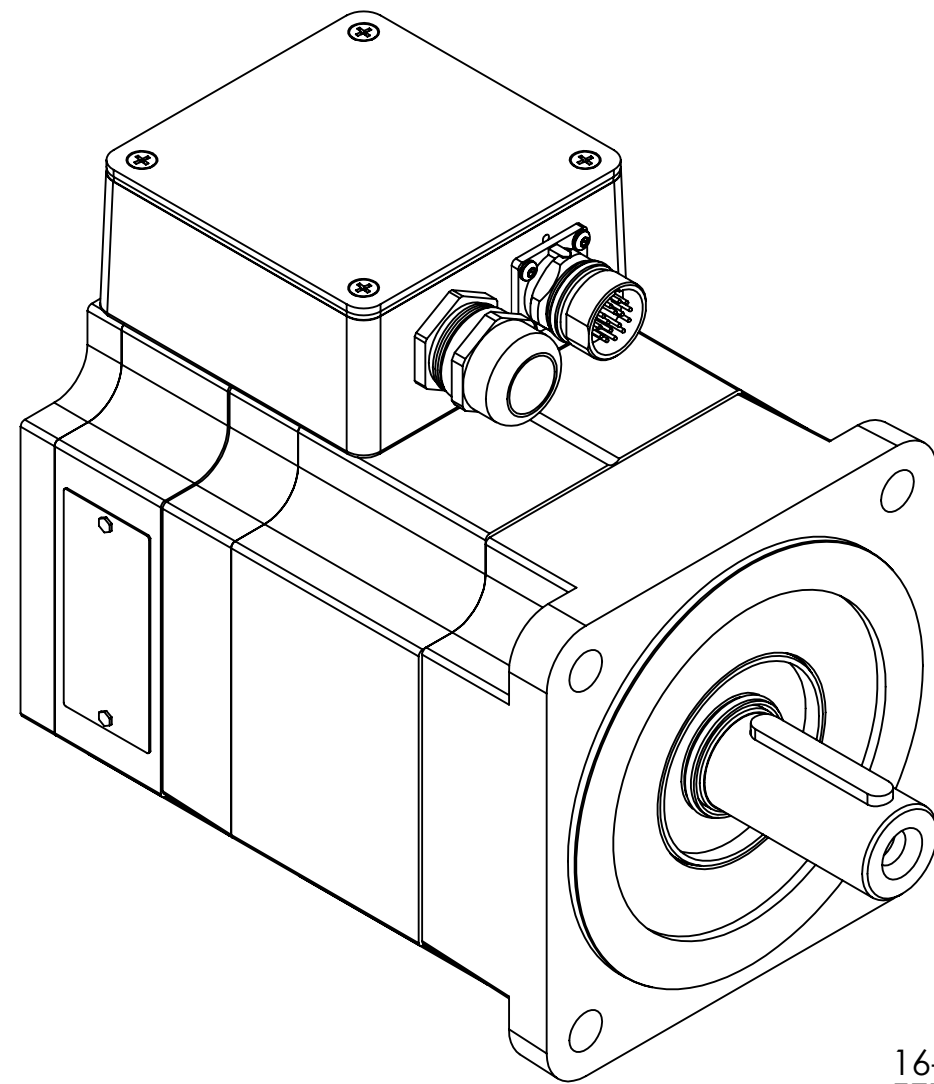
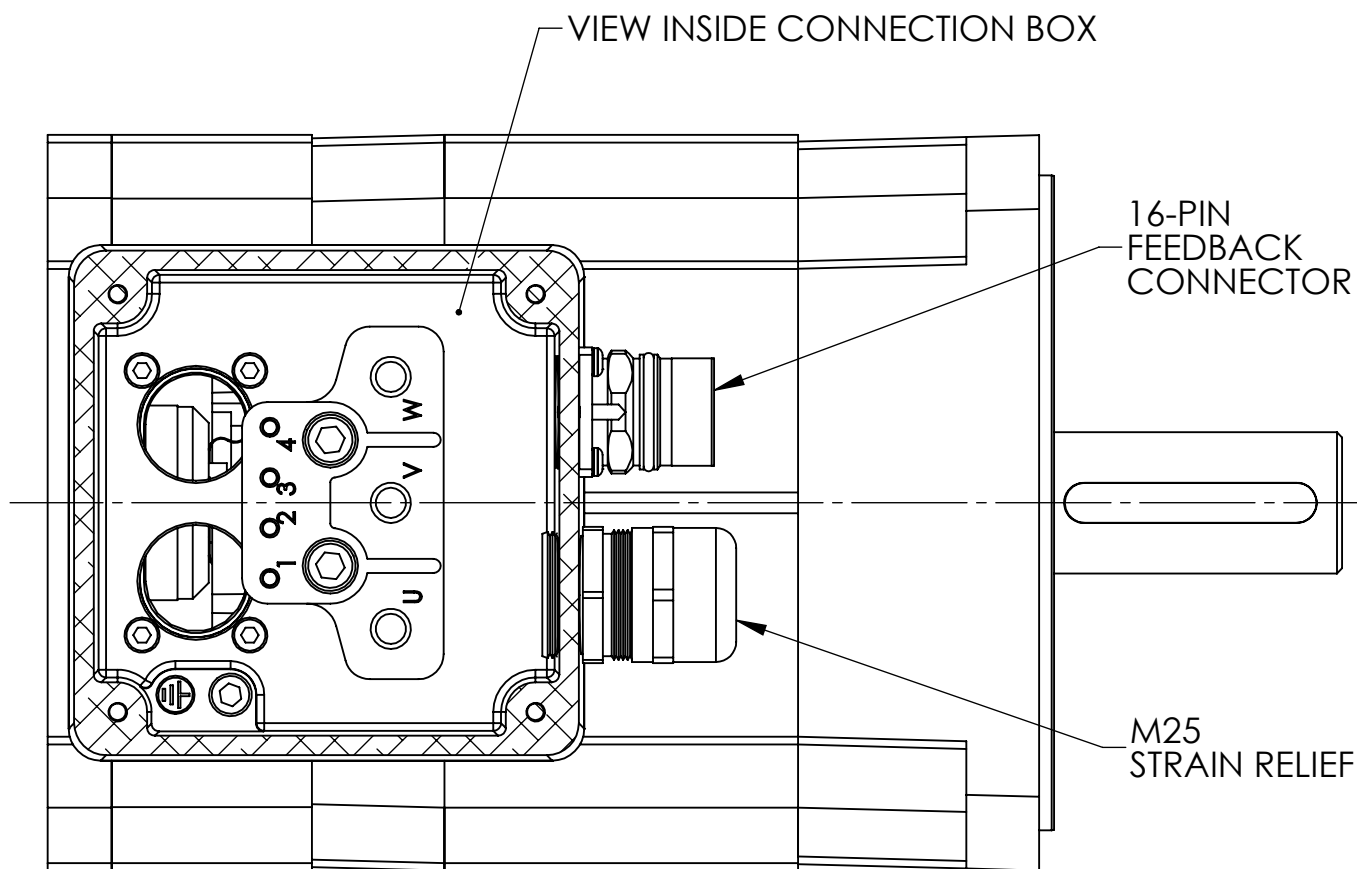
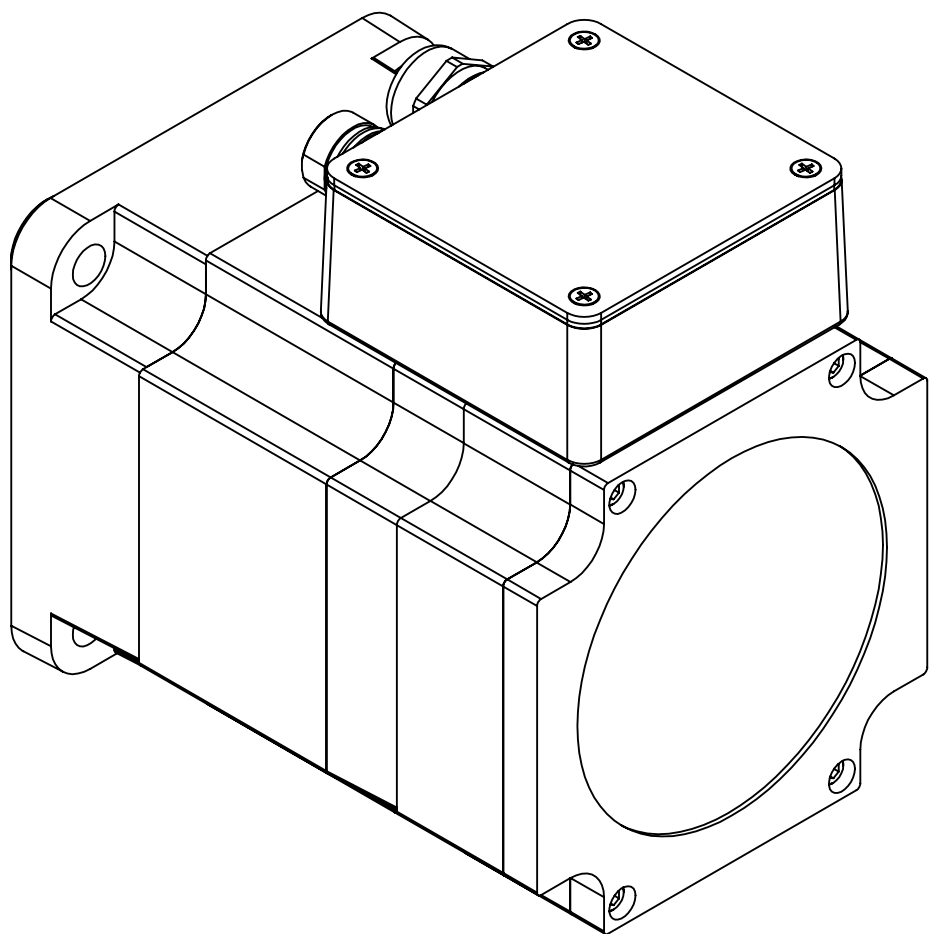

TOL UNLESS SPEC.  
2 PLC INCH DEC. =  
± .06" [1.5mm]  
ANGLES ± 0.5°

REFERENCE	CODE	A
BSM100B-1	22	7.75 [196.8]
BSM100A/N-1	24	8.00 [203.1]
BSM100A/N-2	40	10.00 [253.9]
BSM100B-2	46	10.75 [273.0]
BSM100A/N-3	56	12.00 [304.7]
BSM100B-3	70	13.75 [349.2]
BSM100A/N-4	72	14.00 [355.5]
BSM100B-4	80	15.00 [380.9]

CUSTOMER IS RESPONSIBLE FOR DETERMINING THAT BALDOR'S PRODUCT WILL PERFORM SUITABLY IN THE INTENDED APPLICATION

REV. DESC: UPDATE GRAPHICS			
REV: G	VERSION: 06	REVISED: 01:43:38 02/16/2018	TDR: 000001061021
MODEL NO. S4LYP064		REF: -	
BY: ENJEFD0		C	

**BALDOR**

BSM100, 28D165, ENCODER, K.O. BOX M25, 16P M23 CONNECTOR

S4LYP064

S4LYP064