

“QD” WELD-ON HUBS

Usage: For many applications, such as conveyor drum pulleys, rotors, plate sprockets, impellers, etc.



DID YOU KNOW THAT...

Maska QD weld-on hubs are made of low carbon steel for its excellent welding properties, and are compatible with all standard QD bushings, with the exception of SD.

HOW TO ORDER

EXAMPLE: **H-M**

H **M**

H: QD WELD-ON HUB

M: HUB SIZE (RELATED TO QD BUSHING)

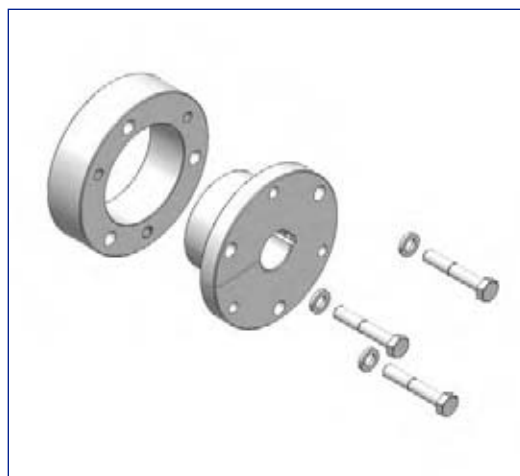

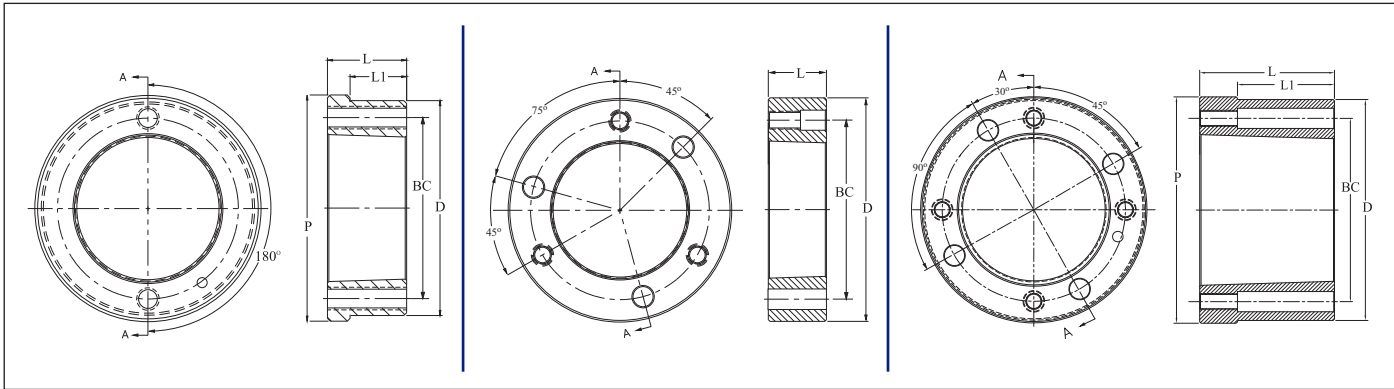

Type 1

Type 2

Type 3

DIMENSIONS

Part No.	List Price \$	Fits Bushing	Type	Dimensions - Inches					Bore Range	Approx. Weight
				D*	L	P	L1	BC		
H-L	9.00	L	1	2.375	0.88	2.50	0.17	2	3/8 to 1 1/2"	0.6
H-CL	9.00	L	1	2.375	0.88	2.50	0.63	2	3/8 to 1 1/2"	0.6
H-JA	9.00	JA	2	2.250	0.56	1 21/32	1/2 to 1 1/4"	0.4
H-SH	15.00	SH	2	3.000	0.81	2 1/4	1/2 to 1 11/16"	1
H-SDS	14.00	SDS	2	3.500	0.75	2 11/16	1/2 to 2"	1.2
H-SK	27.00	SK	2	4.375	1.25	3 5/16	1/2 to 2 5/8"	3
H-SF	35.00	SF	2	5.000	1.25	3 7/8	1/2 to 2 15/16"	4
H-E	72.00	E	2	6.250	1.63	5	7/8 to 3 1/2"	8.3
H-F	120.00	F	2	7.000	2.50	5 5/8	1 to 4"	15.5
H-J	175.00	J	2	7.750	3.19	6 1/4	1 7/16 to 4 1/2"	22.7
H-M	310.00	M	3	9.250	5.19	9.50	3.56	7 7/8	2 to 5 1/2"	50
H-N	460.00	N	3	10.250	6.25	10.50	4.50	8 1/2	2 3/4 to 6"	77
H-P [□]	1460.00	P	2	13.000	7.25	10	2 15/16 to 7"	155
H-W [□]	2300.00	W	2	15.500	9.00	12 3/4	4 1/4 to 8 1/2"	260

Mounting: **Type 1:** Reverse mount only **Type 2 & 3:** Standard and Reverse mount [□]: Standard mount only
 *Tolerance: **H-L & H-CL** = (+0.001"/-0.005") **H-JA thru H-J** = (+0.000"/-0.002") **H-M thru H-W** = (+0.000"/-0.003")