

# RPMAC VARIABLE SPEED ALTERNATING CURRENT MOTOR FL1844CZ

ENCLOSURE: DRIP PROOF

MOUNTING: FOOT / NEMA 250TC C-FACE

DRIVE METHOD: COUPLED OR BELTED

COOLING: FORCE VENTILATED

ACCESSORIES: PROVISIONS FOR TACHOMETER MOUNTING ONLY WHEN SPECIFIED

617233-023

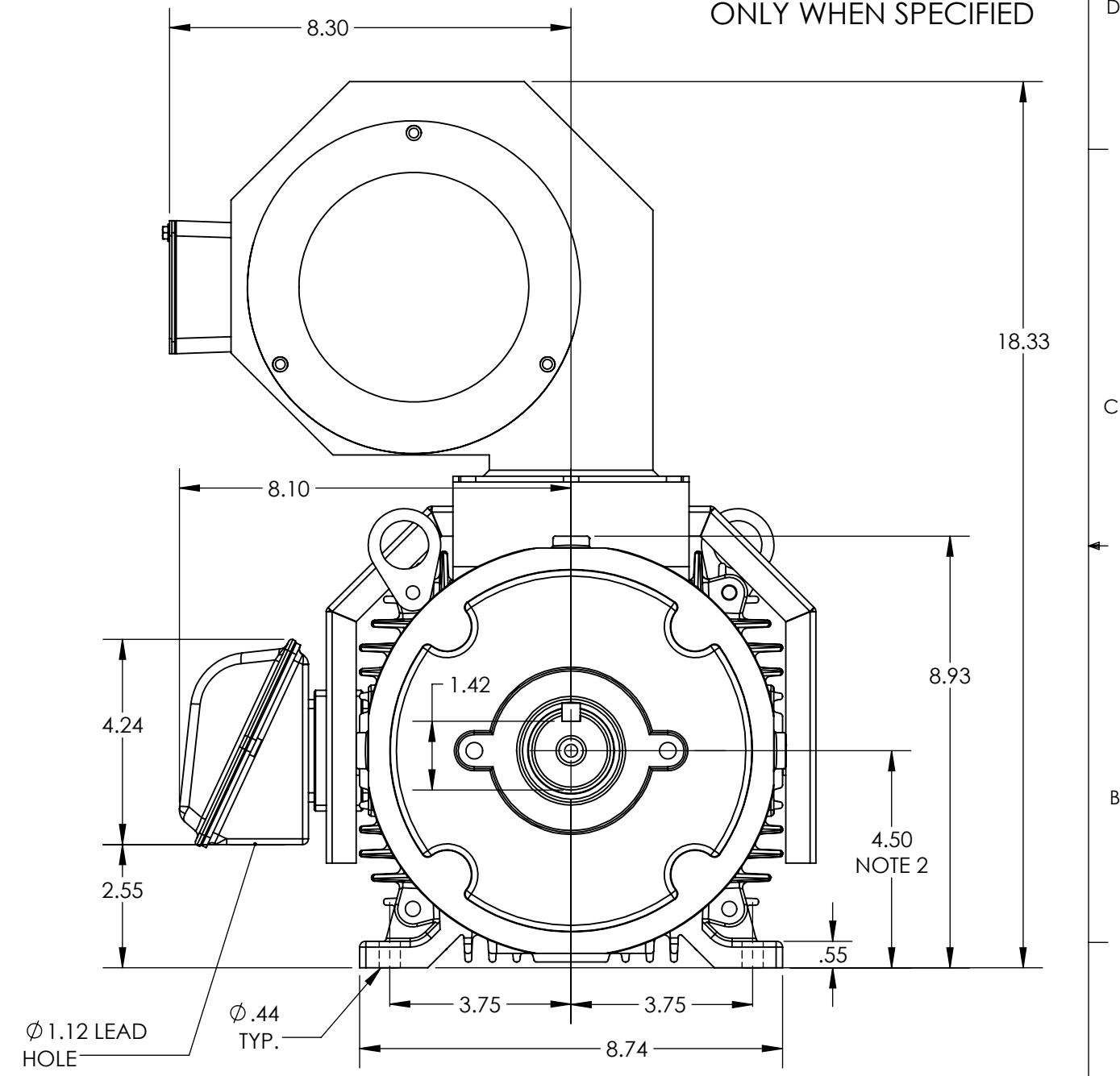
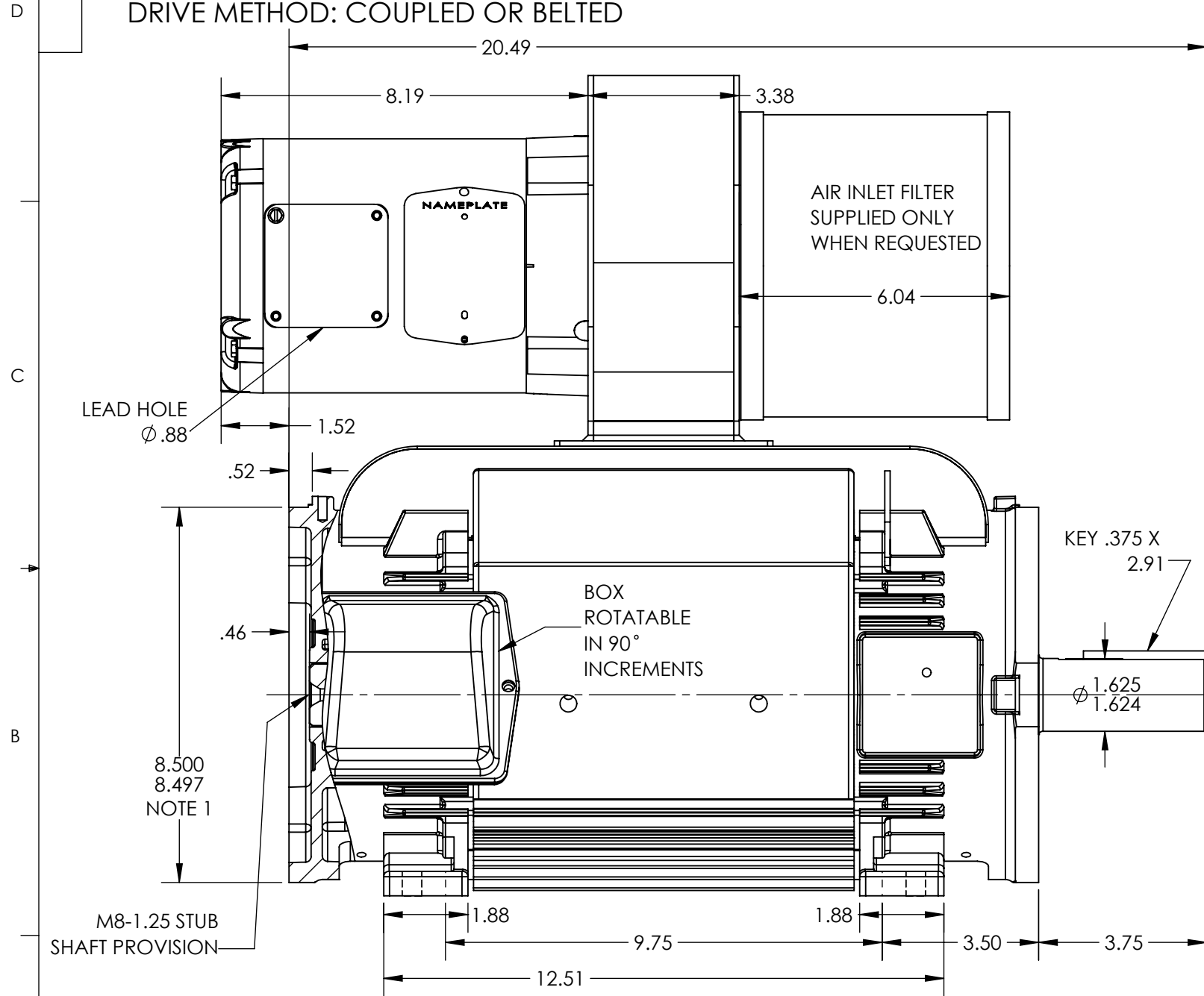

NOTE 1 TACHOMETER MOUNTING  
1.2-13 TAP .88 DEEP, ON A 7.25 DIA. BOLT CIRCLE  
FACE RUNOUT AND ECCENTRICITY .004 MAX T.I.R.

NOTE 2 SHAFT HEIGHT WILL NOT BE EXCEEDED.  
SHIMS UP TO .03 INCHES IN THICKNESS ARE USUALLY  
REQUIRED FOR COUPLED OR GEARED MACHINES.

NOTE 3 MAXIMUM PERMISSIBLE SHAFT RUNOUT WHEN MEASURED  
AT END OF STD. SHAFT EXTENSION IS .002 T.I.R. UP TO AND  
INCLUDING 1.625 DIA. AND .003 T.I.R. 1.625 TO 5 INCH DIA.

NOTE 4 TERMINAL BOX MAY BE LOCATED F1 OR F2 IF SPECIFIED.  
ROTATABLE IN 90° INCREMENTS  
REFER TO 616779-050 FOR SPECIFIED TERMINAL BOX DIMENSIONS  
REFER TO 616779-055 FOR SPECIFIED TACHOMETER DIMENSIONS

40 AMP MILL TERMINAL BOX SHOWN  
MOTOR WEIGHT 200 LBS. (MAY VARY 15%)  
DIMENSIONS ARE IN INCHES SCALE 1:1

CUSTOMER IS RESPONSIBLE FOR DETERMINING THAT THE PRODUCT WILL PERFORM SUITABLY IN THE INTENDED APPLICATION

REV. DESC: CONVERT TO SW			
REV: D	VERSION: 04	REVISED: 11:19:31 01/25/2023	TDR: 000001203038
MODEL NO. 617233-023		REF: -	
BY: RGGRWM		<b>B</b>	

**BALDOR - RELIANCE®**

DIM SH 250TC RPMAC DPFV FL1844CZ FT MT PROV FOR TACH

617233-023